



**HAL**  
open science

## **Design Innovations and Performance Assessment of Small Wind Turbines: A Review for Decentralized and Off-grid Applications**

Rovamanjaka Onjamalala Lucas Rollandros Ravoniharinaivo, Youssef Kebbati, Odette Fokapu, Aicha Yvanna Rasoarimanana, Jean Claude Rakotoarisoa, Nirinarison Jean Razafinjaka

### ► To cite this version:

Rovamanjaka Onjamalala Lucas Rollandros Ravoniharinaivo, Youssef Kebbati, Odette Fokapu, Aicha Yvanna Rasoarimanana, Jean Claude Rakotoarisoa, et al.. Design Innovations and Performance Assessment of Small Wind Turbines: A Review for Decentralized and Off-grid Applications. *Current Journal of Applied Science and Technology*, 2025, 44 (7), pp.15-26. <10.9734/cjast/2025/v44i74571>. <hal-05145439>

**HAL Id: hal-05145439**

**<https://hal.science/hal-05145439v1>**

Submitted on 21 Oct 2025

HAL is a multi-disciplinary open access archive for the deposit and dissemination of scientific research documents, whether they are published or not. The documents may come from teaching and research institutions in France or abroad, or from public or private research centers.

L'archive ouverte pluridisciplinaire HAL, est destinée au dépôt et à la diffusion de documents scientifiques de niveau recherche, publiés ou non, émanant des établissements d'enseignement et de recherche français ou étrangers, des laboratoires publics ou privés.



Distributed under a Creative Commons CC BY 4.0 - Attribution - International License



# **Design Innovations and Performance Assessment of Small Wind Turbines: A Review for Decentralized and Off-grid Applications**

**Rovamanjaka Onjamalala Lucas Rollandros RAVONIHARINAIVO <sup>a\*</sup>, Youssef KEBBATI <sup>b</sup>, Odette FOKAPU <sup>c,d</sup>, Aicha Yvanna RASOARIMANANA <sup>a,d</sup>, Jean Claude RAKOTOARISOA <sup>a</sup> and Nirinarison Jean RAZAFINJAKA <sup>a</sup>**

<sup>a</sup> *Ecole Doctorale Thématique Energies, Renouvelables et Environnement, University of Antsiranana, Antsiranana, Madagascar.*

<sup>b</sup> *Laboratoire de Physique et Chimie, de l'Environnement et de l'Espace, University of Orleans, Orleans, France.*

<sup>c</sup> *Université de Technologie de Compiègne, UMR CNRS 7338 Biomécanique et Bioingénierie, University of Picardie Jules Verne, IUT Aisne, Cuffies-Soissons, France.*

<sup>d</sup> *Diasporeines Africa, France.*

## **Authors' contributions**

*This work was carried out in collaboration among all authors. All authors read and approved the final manuscript.*

## **Article Information**

DOI: <https://doi.org/10.9734/cjast/2025/v44i74571>

## **Open Peer Review History:**

This journal follows the Advanced Open Peer Review policy. Identity of the Reviewers, Editor(s) and additional Reviewers, peer review comments, different versions of the manuscript, comments of the editors, etc are available here: <https://pr.sdiarticle5.com/review-history/138123>

**Review Article**

**Received: 16/04/2025**  
**Published: 04/07/2025**

\*Corresponding author: E-mail: [ravoniharinaivo@gmail.com](mailto:ravoniharinaivo@gmail.com);

**Cite as:** RAVONIHARINAIVO, Rovamanjaka Onjamalala Lucas Rollandros, Youssef KEBBATI, Odette FOKAPU, Aicha Yvanna RASOARIMANANA, Jean Claude RAKOTOARISOA, and Nirinarison Jean RAZAFINJAKA. 2025. "Design Innovations and Performance Assessment of Small Wind Turbines: A Review for Decentralized and Off-Grid Applications". *Current Journal of Applied Science and Technology* 44 (7):15-26. <https://doi.org/10.9734/cjast/2025/v44i74571>.

## ABSTRACT

This study provides a critical and comparative review of recent technological innovations in small wind turbines (SWTs), with a focus on their relevance for decentralized energy production in both urban and remote environments. It is based on a descriptive and analytical evaluation of technologies reported in the scientific literature from 2019 to 2024. Five representative SWT models are selected, Liam F1 UWT, Aeroleaf, IceWind, AeroMINE, and Harmony, covering both horizontal and vertical axis designs, including drag-based, lift-based, and pressure-gradient-based systems. A multi-criteria assessment framework is applied, considering performance under low to moderate wind conditions, as well as factors such as aerodynamic configuration, materials, installation context, and cost-effectiveness. Particular attention is paid to turbine start-up thresholds, acoustic levels, urban integration, and turbulence tolerance. The analysis shows that while some models such as Harmony and AeroMINE offer adaptability to complex wind profiles in urban areas, others like IceWind and Liam F1 are more suited for remote or low-noise environments. The role of aerodynamic design, ranging from Savonius and Darrieus profiles to helical blades and motionless Venturi-based systems, is highlighted as a key determinant of performance. The study concludes with recommendations for enhancing durability, scalability, and hybrid potential in future SWT developments.

*Keywords: Design innovations; performance assessment; small wind turbines; off-grid applications.*

## 1. INTRODUCTION

Over the past decades, wind turbine technology has experienced significant growth, establishing itself as one of the most widespread and strategic sources of renewable energy worldwide. The sector is currently dominated by China due to its high installed capacity (Zhang et al., 2020). The expansion of wind energy has been strongly influenced by responses to energy crises, particularly the one linked to the war in Ukraine, which have redirected investments toward renewables to ensure energy security and price stability (IEA, 2023). While large-scale onshore and offshore installations still dominate energy production (Linnerud et al., 2022), reflects an increasing interest in energy decentralization and user autonomy (Bianchini et al., 2022), a reduction in dependence on centralized grids, and the valorization of local resources, especially in urban or remote areas, as emphasized by Tang et al., (2015).

In regions with low solar irradiance, small wind turbines represent an essential alternative to photovoltaics to ensure reliable electrification (López-González et al., 2020). These technologies are currently used in a variety of contexts: powering isolated homes, smart urban infrastructure, hybrid systems with solar panels, and autonomous equipment such as weather stations and relay antennas. The global market for small wind turbines is experiencing sustained growth, driven by technological innovations and targeted policy incentives. However, as noted by

Li et al., (2012), practical conditions must be met to ensure their economic viability. Incentive measures such as low-interest loans or investment subsidies are crucial to promote their large-scale adoption.

Despite these advances, scientific literature shows that research remains focused primarily on large-scale turbines or standard prototypes (Veers et al., 2023), often overlooking the specific challenges of small wind turbines, such as low wind speeds, increased turbulence, architectural integration issues, and concerns related to noise and maintenance (Khedr and Castellani, 2024). This gap calls for a critical reassessment of current approaches (Zajicek et al., 2023), in light of recent technological innovations.

In this context, the present article undertakes a critical review of recent developments in small wind turbine technology, drawing on a representative corpus of devices developed by startups around the world. The goal is to go beyond marketing claims and examine the actual performance of these technologies, their technical limitations, and optimization prospects, in order to support their long-term integration into decentralized energy systems.

## 2. OVERVIEW OF WIND TURBINES

A wind turbine is an electromechanical conversion device designed to harness the kinetic energy of moving air. The conversion

process involves two successive stages: transforming kinetic energy into mechanical rotational energy, followed by its conversion into electrical energy through electromagnetic induction.

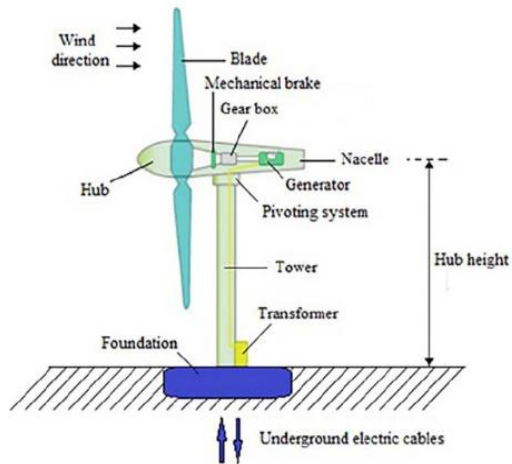

**Fig. 1. Overview of the main components of a HAWT (Horizontal Axis Wind Turbine) (Năstase, 2024)**

### 2.1 Classification of Wind Turbines by Rotor Size, Swept Area, and Rated Power

According to Tummala et al., (2016) small wind turbines differ from large-scale systems by having a rotor diameter between 1.25 and 3 meters and a rated power output ranging from 0.25 to 1.4 kW. The Table 1 summarizes this classification.

The relationship between rotor diameter and swept area is mathematically defined by:

$$A = \frac{\pi D^2}{4} \quad (1)$$

**Table 1. HAWT classification by rotor diameter and power output (Tummala et al., 2016)**

Scale	Rotor (m)	Swept Area (m <sup>2</sup> )	Power (kW)	Typical Applications
Micro	0.5 – 1.25	0.2 – 1.2	0.004 – 0.25	Remote sites, boats, caravans
Mini	1.25 – 3	1.2 – 7.1	0.25 – 1.4	Small domestic needs, water pumping
Domestic	3 – 10	7 – 79	1.4 – 16	Electricity production for households
Small commercial	10 – 20	79 – 314	25 – 100	Small business, farms
Medium commercial	20 – 50	314 – 1963	100 – 1000	Medium businesses, small communities
Large commercial	50 – 100	1963 – 7854	1000 – 3000	Large companies, wind farms

This fundamental aerodynamic equation Manwell, (2002) shows that a linear increase in diameter (D) results in a quadratic increase in the area for extracting wind energy.

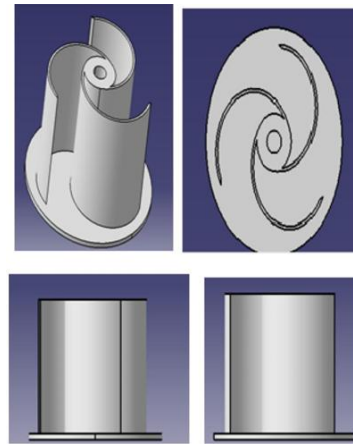

**Fig. 2. Isometric, top, front, and side views of the Savonius rotor blade (Chandrashekhar, 2019)**

### 2.2 Classification by Rotor Axis Orientation

Small wind turbines can be categorized into two main families based on rotor orientation:

#### 2.2.1 Vertical axis wind turbines (VAWT)

These turbines have a vertical rotational axis, enabling omnidirectional wind capture without the need for a yaw system. Two main types are identified:

The Savonius turbine, invented in 1922 by Finnish engineer S. J. Savonius, operates based on the drag force exerted by wind on curved blades. It is known for its simple design, low-speed wind startup capability, and reliability under moderate wind conditions.

**Table 2. Technical comparison of HAWT and VAWT**

Criterion	HAWT	VAWT
Wind orientation	Requires yaw mechanism	Omnidirectional capture
Self-starting	Generally present	Darrieus : rarely / Savonius : intrinsic
Generator location	At top of the tower (maintenance harder)	At base (easier maintenance)
Power coefficient (Cp)	0.35 – 0.45	Darrieus : 0.3 – 0.4 / Savonius : 0.15 – 0.3
Turbulence sensitivity	High (depends on orientation)	Lower, suited for urban environments
Typical applications	Rural areas with steady wind	Urban rooftops, isolated environments

In contrast, the Darrieus-type wind turbine, designed in 1925 by French engineer G. J. Darrieus, relies on lift generated by airfoil-shaped blades. Although more complex than the Savonius model, it offers higher efficiency, especially at high wind speeds. Its various design variants allow for adaptation to different needs and installation conditions.

**2.2.2 Horizontal axis wind turbines (HAWT)**

Horizontal Axis Wind Turbines dominate the wind energy sector (see Fig. 1), accounting for over 90% of global installations. Their design, which orients the rotor into the wind using a yaw system, allows for efficient energy capture. They achieve power coefficients (Cp) close to Betz’s limit (0.45–0.55) and overall efficiencies of 35–45% (Krishnan, 2021). Modern models, such as the 12 MW Haliade-X, can generate up to 67 GWh per year, enough to power about 16,000 European households (Winters and Saunders, 2018). Installed at heights of 80 to 150 meters, they benefit from steadier wind, especially offshore where capacity factors can exceed 50%. However, their large size and space requirements limit urban integration, and their logistical costs remain high.

**2.3 Analyze Comparative: HAWT vs VAWT**

The Table 2 summarizes the key differences between HAWTs and VAWTs, highlighting their respective advantages and constraints.

In residential applications, VAWTs are often more suitable due to their low noise levels, ease of maintenance, and ability to capture wind from any direction without an active yaw mechanism. The HAWTs, on the other hand, may offer higher aerodynamic efficiency but are generally better suited for open rural areas where space and consistent wind flow are available. This distinction is important when selecting a turbine for domestic-scale deployment. According to

Manwell, (2002), the performance of a wind turbine depends not only on its geometric and mechanical characteristics, but also on local environmental conditions. Therefore, the choice between HAWT and VAWT should be guided by a cost-efficiency optimization approach, considering architectural integration and maintenance constraints.

In the context of urban and personal wind energy, VAWTs offer significant advantages. Their ability to capture wind from any direction and their lower sensitivity to turbulence make them especially suitable for urban environments, where airflow is often disturbed by surrounding structures (Mertens et al., 2025). Additionally, locating the generator at the base facilitates maintenance and reduces associated costs.

Beyond technical constraints, the economic and environmental feasibility of DIY (Do It Yourself) solutions for personal wind energy holds great potential for small-scale energy transitions. Community-based projects and handcrafted mini-turbines using recycled materials have emerged in response to economic and environmental constraints. These initiatives, complementing the analyses of Manwell, 2002 and urban wind case studies, illustrate how local innovation can help overcome limitations inherent in industrial approaches within complex settings (Mubarok et al., 2018).

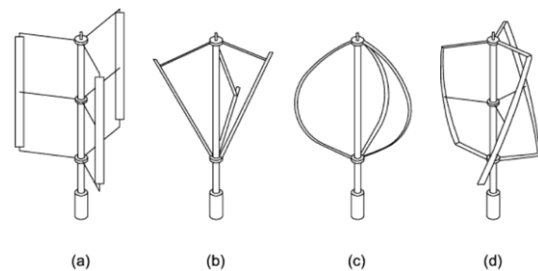

**Fig. 3. Possible variations of the Darrieus VAWT: (a) H-shape, (b) V-shape, (c) Troposkein shape, and (d) Gorlov shape (Chandrashekhar, 2019)**

### 3. STATE OF THE ART OF INNOVATIVE SMALL WIND TURBINES

In response to the growing demand for renewable urban energy, many companies have recently developed innovative small wind turbines that combine compactness, low noise levels, and performance at low wind speeds. This section presents a representative selection of emerging technologies, grouped according to their structural or functional approaches. The selection focuses on five devices considered representative based on the following criteria: innovative character, availability of performance data (in the scientific literature), and technological feasibility.

#### 3.1 Bio-inspired and Optimized Design Small Wind Turbines

##### 3.1.1 Liam F1 UWT

The Liam F1 Urban Wind Turbine (UWT), developed in the Netherlands, is a horizontal-axis small wind turbine inspired by the Archimedean screw, designed for urban use. Two complementary approaches have been used to assess its performance: a study by Jang et al., (2019), which combined Computational Fluid Dynamics (CFD) simulations, wind tunnel testing, and on-site trials, achieving a maximum power coefficient ( $C_p$ ) of 0.293 at a wind speed of 12.7 m/s; and a study by Magaña, (2024) which focused on low-cost reproducibility through a 3D-printed prototype at a 1:3 scale.

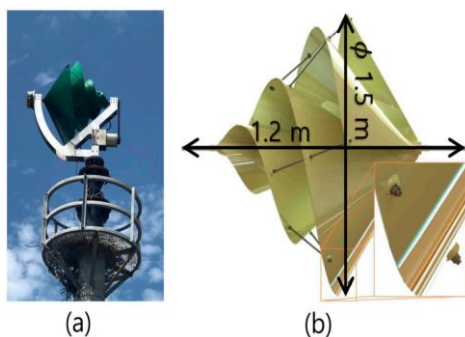

**Fig. 4. Geometric shape of the wind turbine: (a) wind turbine installed during performance tests; (b) 3D model file used for simulation (Jang et al., 2019)**

The results indicate good aerodynamic efficiency and suitability for educational or experimental applications, although commercial deployment remains limited.

##### 3.1.2 Aeroleaf

The Aeroleaf is a biomimetic vertical-axis micro wind turbine designed by NewWind, integrating photovoltaic elements for hybrid energy production. Several studies have evaluated its performance. (Emeara et al., 2021) demonstrated its ability to start operating at a wind speed as low as 1.94 m/s in a hybrid system, while (Rathore et al., 2023) tested a wind tree with five modules generating up to 2.77 W at 5.68 m/s. (Nugraha et al., 2025) simulated a scaled-down model (1:4), achieving a maximum power coefficient ( $C_p$ ) of 0.134, with sufficient efficiency to power an LED. Although its design is well-suited for urban environments, its high cost (~36,500 USD) currently limits widespread adoption.



**Fig. 5. Aeroleaf Wind Turbine (Ray, 2025)**

#### 3.2 Developments in Savonius Turbines

##### 3.2.1 IceWind

Developed in Iceland, the IceWind is a vertical-axis micro wind turbine derived from the Savonius model, optimized for low wind speeds. Several studies have assessed its performance through wind tunnel experiments and CFD simulations. It reaches a rotational speed of 850 rpm at 15.8 m/s and a maximum static torque of 0.064 N·m (Afify, 2019). Three-dimensional Fluid-Structure Interaction (FSI) simulations show greater efficiency than the conventional Savonius design at low-speed regimes, with good behavior at very low Tip Speed Ratios (TSR), the ratio between blade tip speed and wind speed (Lillahulhaq and Djanali, 2019). The three-blade configuration proved to be the most efficient (Gad et al., 2020), offering an attractive balance between stability, efficiency, and compactness (Mansour and Afify, 2020). Its curved, silent, and robust aluminum design makes it a promising candidate for regions with moderate or unstable wind conditions.



**Fig. 6. CW IceWind Wind Turbine (Mansour and Afify, 2020)**

have explored its performance. It demonstrates a start-up capability at just 2.5 m/s and operates silently thanks to a passive furling system (Raut et al., 2020). The Scoop Harmony profile (Syahin et al., 2024) shows a 31% increase in rotational speed compared to a conventional Savonius turbine, reaching 783 rpm at 10 m/s. Experimental tests confirm moderate power output (up to 13 mW at 69 rpm) using a low-voltage generator, making it suitable for off-grid or educational applications (Malvadkar et al., 2019). Its compact, lightweight design, made of PLA (polylactic acid, a biodegradable polymer used in 3D printing) or PVC (polyvinyl chloride), and low cost make it an accessible solution for micro energy applications.

### 3.3 Unconventional and Hybrid Systems

#### 3.3.1 AeroMINE

The AeroMINE (Aero Motionless, Integrated, and Noiseless Extractor) is a non-conventional wind energy technology with no external rotating rotor, designed to be integrated into building facades. It relies on the Venturi effect to concentrate airflow toward an internal turbine. Two major studies (Pol et al., 2020, Houchens et al., 2022) conducted in wind tunnels and on-site at Sandia Labs, demonstrated mechanical efficiency reaching 27% at a 15° angle and 25% under real-world conditions at wind speeds of  $\geq 9$  m/s (the minimum wind speed for optimal performance). This system shows excellent stability under wind misalignment up to  $\pm 30^\circ$ , with performance loss limited to 20% at 45°. Although still in the experimental phase, AeroMINE offers a silent, modular, and turbulence-resilient solution, particularly well-suited for building-integrated urban wind power applications.

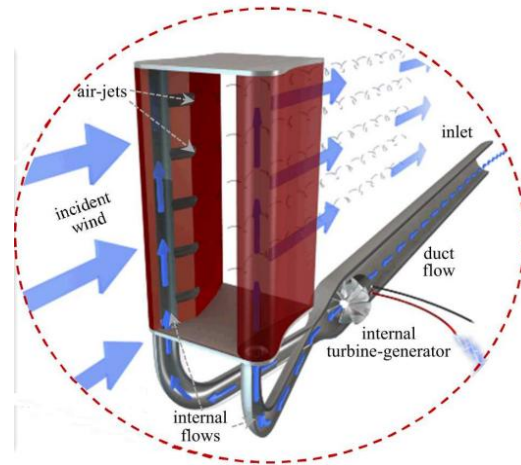
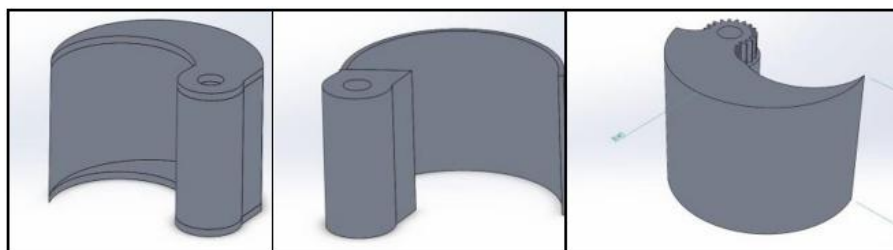

**Fig. 7. Operation of an AeroMINE pair (Houchens and Marian, 2019)**

#### 3.3.2 Harmony

The Harmony turbine is a vertical-axis micro wind turbine with a helical geometry, developed for low wind potential environments. Three studies

To facilitate the comparison between the studied small wind turbines, the Table 3 summarizes the main technical, contextual, and environmental characteristics of the five innovative devices analyzed. It highlights their specific advantages as well as the design-related trade-offs, enabling a cross-evaluation based on performance, cost, and adaptability criteria.



**Fig. 8. Isometric view of the wind turbines: VAWT Savonius (left), Solid Harmony (center), and Scoop Harmony (right) (Syahin et al., 2024)**

**Table 3. Comparative table of innovative small wind turbines**

Model	Type & Configuration	Max Cp	Max RPM (ref. wind)	Start-up	Max Power (ref. wind)	Main Materials	Noise	Typical Application	References
Liam F1 UWT	Bio-inspired HAWT, 3 blades, axial rotor	0.293 @12.7 m/s	330 rpm @12.7 m/s	~2.5 m/s	500 W @12.7 m/s	Metal (real), PLA (prototype)	≤ 40 dB	Urban lighting, educational	(Jang et al., 2019, Magaña, 2024)
Aeroleaf	Modular biomimetic VAWT, hybrid with PV	0.134 @9 m/s	1450 rpm @5 m/s	1.94 m/s	2.77 W @5.68 m/s	PLA, composite + integrated PV	Very low	Microgrid, urban building	(Mohamed et al., 2021, Rathore et al., 2023, Nugraha et al., 2025)
IceWind	Savonius-derived VAWT, 2–4 blades	~0.18 (3 blades)	~700 rpm @14 m/s	≤ 2 m/s (efficient TSR<0.1)	~0.18 N·m (static torque)	Aluminium (prototype)	Moderate	Remote areas, cold climates	(Afify, 2019, Lillahulhaq and Djanali, 2019, Gad et al., 2020, Mansour and Afify, 2020)
AeroMINE	Fixed system, no rotor, Venturi effect	0.25–0.27	–	≥ 5 m/s	Up to 27% mechanical efficiency	Structural composite	Inaudible	Industrial façades	(Pol et al., 2020, Houchens et al., 2022)
Harmony	Helical VAWT, scoop/3D-printed blades	0.6 (Scoop)	783 rpm @10 m/s (Scoop)	2.5 m/s	13.25 mW @69 rpm	PLA, PVC, 3D printing	Very low	Off-grid, educational	(Houchens and Marian, 2019, Syahin et al., 2024, Raut et al., 2020, Malvadkar et al., 2019)

**Table 4. Multicriteria analysis of innovative small wind turbines**

Model	Estimated Cost	Efficiency	Maintenance	Installation	Noise	Environmental Adaptability	Durability	Overall score (1-5)
Liam F1 UWT	High (4)	High (4)	Moderate (3)	Easy (4)	Very low (5)	Good (4)	Good (4)	4.0
Aeroleaf	High (4)	Moderate (3)	Low (2)	Easy (4)	Very low (5)	Urban only (3)	Good (4)	3.6
IceWind	Moderate (3)	Moderate + (3.5)	Good (4)	Moyenne (3)	Average (3)	Polaire, rural (4)	Very Good (5)	3.6
AeroMINE	Very high (5)	Moderate + (3.5)	Low (2)	Complex (2)	None (1)	Industrial only (3)	Good (4)	2.9
Harmony	Low (2)	Low+ (2.5)	Fréquent (2)	Very easy (5)	Very low (5)	Versatile (4)	Moderate (3)	3.4

For informational purposes,  $C_p$  and RPM values are derived from simulations, wind tunnel tests, or experimental data, depending on the study. Maximum power output depends on the specific system tested and may not reflect standardized conditions. The Harmony model includes various profiles (Solid, Scoop), with only some achieving higher performance levels.

### 3.4 Comparative Analysis

The comparative study of the Liam F1 UWT, Aeroleaf, IceWind, AeroMINE, and Harmony turbines reveals significant differences in terms of efficiency, design, environmental adaptability, and technological maturity. Each technology tackles specific challenges but comes with structural, functional, or contextual limitations to consider.

#### 3.4.1 Aerodynamic efficiency ( $C_p$ ) and energy performance

Power coefficient ( $C_p$ ) values, although dependent on experimental conditions, allow for a preliminary ranking of performance. The AeroMINE turbine demonstrates aerodynamic efficiencies ranging from 18% to 27% depending on the angle of attack (Pol et al., 2020) which corresponds to about 42% of the Betz limit. This efficiency, however, remains below that of optimized lift-based turbines. Similarly, the Liam F1 UWT reaches a maximum  $C_p$  of 0.293 (Jang et al., 2019), a respectable performance for a drag-type turbine, but the overall efficiency drops to 33.6% due to electrical losses. In comparison, the Aeroleaf shows a simulated  $C_p$  of 0.134 (Nugraha et al., 2025) while the IceWind lags behind, with low torque (0.064 N·m) and  $C_p$  values generally below those of Savonius turbines above 4 m/s. The Harmony turbine, although optimized for low-speed start-up, achieves only modest efficiencies due to its low-RPM single-phase generator

#### 3.4.2 Structural robustness, durability, and scalability

Material strength and scaling effects are especially significant for prototypes made of PLA or 3D-printed materials. The Liam F1 UWT tested at a 1:3 scale (Magaña, 2024) and the Aeroleaf (Nugraha et al., 2025) at 1:4 both show mechanical limitations. In these cases, small-scale performance cannot be directly extrapolated to real-world conditions. Although lightweight and quiet, the Harmony turbine also

raises concerns regarding the durability of its PLA components under UV exposure and weather conditions (Raut et al., 2020). In contrast, the AeroMINE features a fixed structure with no external moving parts, offering notable advantages in terms of maintenance and durability in harsh environments. However, its modular integration complexity may pose technical challenges.

#### 3.4.3 Aerodynamic stability and turbulence response

IceWind and AeroMINE both display significant instabilities under transient conditions. IceWind, in particular, produces significant three-dimensional vortices that impair aerodynamic stability at high wind speeds (Mansour and Afify, 2020). AeroMINE, on the other hand, can see efficiency drop as low as 10% in cases of misalignment or asymmetric flow, although its resilience up to 45° misalignment remains acceptable (Houchens and Marian, 2019). By comparison, the Liam F1 UWT lacks active regulation systems (yaw/pitch), making it less responsive to shifting wind directions.

#### 3.4.4 Integration, modularity, and urban applicability

In terms of urban integration, the Aeroleaf and Harmony turbines are the most advanced, both in aesthetics and compatibility with domestic microgrids. However, the Aeroleaf features technical complexity in serial wiring of modules, with risks of cascading failure. Harmony offers a compact system with a boost converter and LM317 regulator but remains limited to low-power applications. AeroMINE provides an interesting modular solution for industrial or residential buildings with virtually no acoustic footprint, although its dependence on a specific architectural setup makes it less flexible than compact vertical turbines.

### 3.5 Evaluation

Each small wind turbine was evaluated using a Multicriteria Decision-Making (MCDM) approach, based on seven qualitative criteria: estimated cost, energy efficiency, maintenance requirements, ease of installation, noise level, environmental adaptability, and material durability. The qualitative ratings (low, moderate, high) were assigned based on the synthesis of experimental data and simulation results presented in the previous sections, particularly Section 3.4.

- *Low*: performance significantly below the standard or below the median of the devices compared.
- *Moderate*: average performance or equivalent to the median of the devices.
- *High*: performance above average, demonstrated experimentally or through validated simulation.

The overall score out of 5 corresponds to a fair weighted average of these seven criteria, calculated using the following equation:

$$(2) \text{ Overall score} = \frac{1}{7} \sum_{i=1}^7 \text{Criterion score}_i$$

Each criterion is rated out of 5: Low = 2, Moderate = 3, High = 4, Very high = 5. This approach allows for an overall hierarchy, while preserving the functional diversity of the devices analyzed.

The values presented in Table 4 result from the application of the MCDM framework described above. They are based on a synthesis of experimental results reported in the literature, complemented by simulation data and normalized estimations. When specific values were not directly available from references, the qualitative scores were inferred from the comparative performance indicators discussed in Section 3.4. A scoring scale adapted from similar studies on microgeneration systems was used to ensure consistency and objectivity in the evaluation process.

The analysis of small wind turbines reveals notable differences between models. The Liam F1 UWT stands out with an overall score of 4.0, thanks to its high efficiency, easy installation, and low noise level, making it well-suited for urban environments. The IceWind, scoring 3.6, performs well in extreme environments but shows moderate efficiency. The Aeroleaf, also scoring 3.6, is notable for its easy installation but suffers from lower energy yields. The AeroMINE, with a score of 2.9, is less competitive due to its high cost and complex installation. Finally, the Harmony scores 3.4, showing weaknesses in energy efficiency and material durability, although it is highly versatile.

#### 4. CONCLUSION

This critical review of recent innovations in small wind turbines highlights the technological and energy potential of devices tailored to urban and

remote environments. The comparative analysis of five representative models (Liam F1 UWT, Aeroleaf, IceWind, AeroMINE, and Harmony) reveals a diversity of designs, aerodynamic strategies, and levels of technological maturity. These systems differ not only in efficiency across wind conditions but also in architectural integration, maintenance ease, and environmental adaptability.

While some technologies demonstrate promising performance under controlled conditions, their large-scale deployment remains dependent on several key factors: material durability, system robustness against turbulence, scalability, and production cost. Moreover, the limitations observed in 3D-printed prototypes or those made with polymer-based materials underscore the need for more robust engineering to ensure long-term viability.

This study emphasizes the role of embedded intelligence, modularity, and adaptive control in optimizing real-world performance. Future research directions should therefore adopt a multidisciplinary approach, integrating engineering sciences, sustainable urban planning, and life cycle analysis. The development of full-scale prototypes, combined with rigorous experimental validation and socio-economic assessment, represents a strategic lever to enhance the acceptability and territorial impact of small wind turbines.

Ultimately, innovative small wind turbines, as decentralized energy technologies, are poised to play a central role in the energy transition. However, realizing their full potential over the next decade will require that key technological, economic, and regulatory barriers be addressed through targeted policies and strategic partnerships. A clear research roadmap should focus on three key axes:

- Aerodynamic and energy optimization, with a focus on hybrid wind-solar designs to ensure stable energy output.
- Material innovation, replacing fragile PLA components with durable composites adapted to harsh operating environments.
- Intelligent control and IoT-based monitoring, to enhance adaptability and long-term operational performance.

Additionally, emerging concepts such as bladeless wind turbines, as explored by Adeyanju and Boucher (Anthony and

Boucher,2020), could offer new directions for low-maintenance and noise-free wind energy harvesting, especially in constrained urban environments. These directions underscore the need for multidisciplinary collaboration and real-world prototyping to secure the long-term viability and societal acceptance of small wind energy solutions.

## DISCLAIMER (ARTIFICIAL INTELLIGENCE)

Author(s) hereby declare that generative AI technologies such as Large Language Models, etc. have been used during the writing or editing of manuscripts. This explanation will include the name, version, model, and source of the generative AI technology and as well as all input prompts provided to the generative AI technology

### Details of the AI usage are given below:

1. ChatGPT (OpenAI), GPT-4 version, accessed via the official platform (chat.openai.com).
2. Purpose of use: language editing and text reformulation.
3. The use was limited, ethical, and strictly focused on improving the writing quality without generating scientific content or data.

## ACKNOWLEDGEMENT

The author expresses his deepest gratitude to his research supervisors, Professor Youssef Kebbaty and Professor Odette Fokapu, for their rigorous guidance, insightful advice, and unwavering support throughout the development of this article. Their expertise and availability have been instrumental in the completion of this work.

## COMPETING INTERESTS

Authors have declared that no competing interests exist.

## REFERENCES

- Adeyanju, A. A., & Boucher, D. (2020, December). Theoretical analysis of the bladeless wind turbine performance. *Journal of Scientific Research and Reports*, 93–106. <https://doi.org/10.9734/jsrr/2020/v26i1030325>
- Afify, R. (2019). Experimental studies of an IceWind turbine, 14(17).

Bianchini, A., et al. (2022, October). Current status and grand challenges for small wind turbine technology. *Wind Energy Science*, 7(5), 2003–2037.

<https://doi.org/10.5194/wes-7-2003-2022>

Chandrashekhar, P. K., Managuli, S., & Shashank, A. (2019, August). Design of small scale vertical axis wind turbine. In *2019 International Conference on Power Electronics Applications and Technology in Present Energy Scenario (PETPES)* (pp. 1–5). IEEE.

<https://doi.org/10.1109/PETPES47060.2019.9003999>

Emeara, M. S., AbdelGawad, A. F., & Ahmed, E. H. (2021, September). Hybrid renewable energy system for a sustainable house-power-supply. *Journal of Advanced Research in Fluid Mechanics and Thermal Sciences*, 87(1), 91–107.

<https://doi.org/10.37934/arfmts.87.1.91107>

Gad, T., Shokry, A., Afify, R., Saber, E., & Hassan, M. (2020). Experimental study of two, two-reversed, three and four blade IceWind turbine, 15(12).

Houchens, B. C., & Marian, D. V. (n.d.). *Air-jet design and scaling performance of AeroMINE distributed wind energy harvesters*.

Houchens, B., Marian, D., Pol, S., & Westergaard, C. (2022, May). High wind speed performance of AeroMINE at pilot-scale. In *Proposed for presentation at the Torque held June 1–3, 2022 in Delft, Netherlands*. US DOE.

<https://doi.org/10.2172/2003150>

International Energy Agency (IEA). (2023). *Renewable energy market update – June 2023*. <https://www.iea.org>

Jang, H., Kim, D., Hwang, Y., Paek, I., Kim, S., & Baek, J. (2019, December). Analysis of Archimedes spiral wind turbine performance by simulation and field test. *Energies*, 12(24), 4624.

<https://doi.org/10.3390/en12244624>

Khedr, A., & Castellani, F. (2024, April). Critical issues in the moving reference frame CFD simulation of small horizontal axis wind turbines. *Energy Conversion and Management: X*, 22, 100551.

<https://doi.org/10.1016/j.ecmx.2024.100551>

Li, Z., Boyle, F., & Reynolds, A. (2012, May). Domestic application of micro wind turbines in Ireland: Investigation of their economic viability. *Renewable Energy*, 41, 64–74.

- <https://doi.org/10.1016/j.renene.2011.10.001>
- Lillahulhaq, Z., & Djanali, V. S. (2019). Unsteady simulations of Savonius and Icewind turbine blade design using fluid-structure interaction method. In *The 4th Biomedical Engineering's Recent Progress in Biomaterials, Drugs Development, Health, and Medical Devices: Proceedings of the International Symposium of Biomedical Engineering (ISBE) 2019*, Padang, Indonesia (p. 020009). <https://doi.org/10.1063/1.5138264>
- Linnerud, K., Dugstad, A., & Rygg, B. J. (2022, October). Do people prefer offshore to onshore wind energy? The role of ownership and intended use. *Renewable and Sustainable Energy Reviews*, 168, 112732. <https://doi.org/10.1016/j.rser.2022.112732>
- López-González, A., Ranaboldo, M., Domenech, B., & Ferrer-Martí, L. (2020, October). Evaluation of small wind turbines for rural electrification: Case studies from extreme climatic conditions in Venezuela. *Energy*, 209, 118450. <https://doi.org/10.1016/j.energy.2020.118450>
- Magaña, J. A. C. (2024). *Evaluación experimental de turbinas eólicas de pequeña escala con generadores de corriente directa y pruebas en túnel de viento*.
- Malvadkar, K., Mali, A., Yemul, N., & Patted, M. (2019). *Harmony vertical axis wind turbine*. SSRN. <https://doi.org/10.2139/ssrn.3419792>
- Mansour, H., & Afify, R. (2020, January). Design and 3D CFD static performance study of a two-blade IceWind turbine. *Energies*, 13(20). <https://doi.org/10.3390/en13205356>
- Manwell, J. F. (2002). *Wind energy explained: Theory, design and application*.
- Mertens, S., van Kuik, G., & van Bussel, G. (2003, November). Performance of an H-Darrieus in the skewed flow on a roof. *Journal of Solar Energy Engineering*, 125(4), 433–440. ResearchGate. <https://doi.org/10.1115/1.1629309>
- Mubarok, A. G. A., Djatmiko, W., & Yusro, M. (2018). Design of Arduino-based small wind power generation system. *E3S Web of Conferences*, 67, 01006. <https://doi.org/10.1051/e3sconf/20186701006>
- Năstase, E.-V. (2024, October). *Influence of the material used to build the blades of a wind turbine on their starting conditions*. ResearchGate. <https://doi.org/10.1051/mateconf/201711210017>
- Nugraha, A. D., et al. (2025, March). Comparison of 'Rose, Aeroleaf, and Tulip' vertical axis wind turbines (VAWTs) and their characteristics for alternative electricity generation in urban and rural areas. *Results in Engineering*, 25, 103885. <https://doi.org/10.1016/j.rineng.2024.103885>
- Pitchia Krishnan, B., Mathanbabu, M., Sathyamoorthy, G., Gokulnath, K., & Govind Sanjeev Kumar, L. (2021, January). Performance estimation and redesign of horizontal axis wind turbine (HAWT) blade. *Materials Today: Proceedings*, 46, 8025–8031. <https://doi.org/10.1016/j.matpr.2021.02.777>
- Pol, S., Houchens, B. C., Marian, D., & Westergaard, C. (2020, January). Performance of AeroMINEs for distributed wind energy. In *AIAA Scitech 2020 Forum*, Orlando, FL: American Institute of Aeronautics and Astronautics. <https://doi.org/10.2514/6.2020-1241>
- Rathore, M. K., Agrawal, M., Baredar, P., Shukla, A. K., Dwivedi, G., & Verma, P. (2023, March). Fabrication and performance analysis of the Aero-Leaf Savonius wind turbine tree. *Energies*, 16(7), 3015. <https://doi.org/10.3390/en16073015>
- Raut, S., Sawant, K., Yadhav, M., Sawant, H., & Patel, V. D. (2020). Design and development of Harmony wind turbine. *International Journal of Engineering Research*, 9(3).
- Ray, R. (2025, April 16). A wind turbine that looks like a tree... kind of. *Power Engineering*. <https://www.power-eng.com/renewables/wind-energy/a-wind-turbine-that-looks-like-a-tree-kind-of/>
- Syahin, A. A. T., Zinnyrah, M., Sofea, R. A., Rahman, M. R. A., & Saad, M. R. (2024). Vertical axis wind turbine for low wind speed environment: Effect of scoop Harmony blade. *E3S Web of Conferences*, 477, 00031. <https://doi.org/10.1051/e3sconf/202447700031>

- Tang, X., Huang, X., Peng, R., & Liu, X. (2015). A direct approach of design optimization for small horizontal axis wind turbine blades. *Procedia CIRP*, 36, 12–16.  
<https://doi.org/10.1016/j.procir.2015.01.047>
- Tummala, A., Velamati, R. K., Sinha, D. K., Indraj, V., & Krishna, V. H. (2016, April). A review on small scale wind turbines. *Renewable and Sustainable Energy Reviews*, 56, 1351–1371.  
<https://doi.org/10.1016/j.rser.2015.12.027>
- Veers, P., et al. (2023, July). Grand challenges in the design, manufacture, and operation of future wind turbine systems. *Wind Energy Science*, 8(7), 1071–1131.  
<https://doi.org/10.5194/wes-8-1071-2023>
- Winters, J., & Saunders, Z. (2018, December). The largest wind turbine ever. *Mechanical Engineering*, 140(12), 31.  
<https://doi.org/10.1115/1.2018-DEC-2>
- Zajicek, L., Drapalik, M., Kral, I., & Liebert, W. (2023, October). Energy efficiency and environmental impacts of horizontal small wind turbines in Austria. *Sustainable Energy Technologies and Assessments*, 59, 103411.  
<https://doi.org/10.1016/j.seta.2023.103411>
- Zhang, S., Wei, J., Chen, X., & Zhao, Y. (2020, July). China in global wind power development: Role, status and impact. *Renewable and Sustainable Energy Reviews*, 127, 109881.  
<https://doi.org/10.1016/j.rser.2020.109881>

**Disclaimer/Publisher's Note:** The statements, opinions and data contained in all publications are solely those of the individual author(s) and contributor(s) and not of the publisher and/or the editor(s). This publisher and/or the editor(s) disclaim responsibility for any injury to people or property resulting from any ideas, methods, instructions or products referred to in the content.

© Copyright (2025): Author(s). The licensee is the journal publisher. This is an Open Access article distributed under the terms of the Creative Commons Attribution License (<http://creativecommons.org/licenses/by/4.0>), which permits unrestricted use, distribution, and reproduction in any medium, provided the original work is properly cited.

*Peer-review history:*

*The peer review history for this paper can be accessed here:*

<https://pr.sdiarticle5.com/review-history/138123>