



HAL
open science

Sustainable Reinforced Concrete Beams: Mechanical Optimisation and 3D-Printed Formwork

Sébastien Maitenaz, Romain Mesnil, Paul Onfroy, Nicolas Metge,
Jean-François Caron

► **To cite this version:**

Sébastien Maitenaz, Romain Mesnil, Paul Onfroy, Nicolas Metge, Jean-François Caron. Sustainable Reinforced Concrete Beams: Mechanical Optimisation and 3D-Printed Formwork. Second RILEM International Conference on Concrete and Digital Fabrication, pp.1164-1173, 2020, 978-3-030-49916-7. 10.1007/978-3-030-49916-7_110 . hal-02485770v1

HAL Id: hal-02485770

<https://hal.science/hal-02485770v1>

Submitted on 20 Feb 2020 (v1), last revised 5 May 2021 (v2)

HAL is a multi-disciplinary open access archive for the deposit and dissemination of scientific research documents, whether they are published or not. The documents may come from teaching and research institutions in France or abroad, or from public or private research centers.

L'archive ouverte pluridisciplinaire **HAL**, est destinée au dépôt et à la diffusion de documents scientifiques de niveau recherche, publiés ou non, émanant des établissements d'enseignement et de recherche français ou étrangers, des laboratoires publics ou privés.

Sustainable Reinforced Concrete Beams: Mechanical Optimisation and 3D-Printed Formwork

Sébastien Maitenaz^{1,2}, Romain Mesnil¹, Paul Onfroy², Nicolas Metge², and
Jean-François Caron¹

¹ Laboratoire Navier, UMR 8205, ENPC, IFSTTAR, Université Gustave Eiffel,
CNRS, Champs-sur-Marne, France

sebastien.maitenaz@enpc.fr

² ISC, Vinci Construction France, Chevilly-Larue, France

Abstract. The embodied energy of a building is not only but essentially due to the quantity of material in its structure. Current fabrication techniques of optimised reinforced concrete (RC) structural elements have not proved sufficient economic competitiveness to be broadly accepted by the construction industry. This partly explains why the construction industry has not yet been able to reduce the embodied energy of newly-constructed buildings or civil works. However, most of the researches driven in the academic world on digital fabrication with concrete are focused on the construction of non-standard structures. Application of digital fabrication to standard structures could help bridge the gap between the need for lower-carbon structures and the economic interest of players in the construction industry.

This paper questions the compatibility of existing building codes with digital manufacturing techniques and presents a novel method for the fabrication of sustainable optimised reinforced concrete beams, compliant with EN 1992-1-1 design requirements.

Keywords: Digital Fabrication · Concrete printing · Reinforced Concrete · Structural Optimisation · Strut and Tie Method

1 Introduction

Reinforced concrete (RC) construction, whether it is for buildings or civil works, is still arguably comparable to crafts. Burdensome and time consuming site work directly impacts the design of RC elements. Structural engineers often tend to simplify their design to ease the fabrication process on the one hand, and to avoid possible dramatic fabrication mistakes on the other hand [7]. RC structures built at the beginning of the XXth century when concrete was an expensive resource, such as bridges from Maillart [4], however proves the possibility to build lighter sustainable structures. Two pathways with different time frames can be explored if we are to spare inefficiently consumed concrete. The long term research line concerns the exploration of mechanical optimisation applied to RC elements

outside the bounds of the current standards both on a purely theoretical [8,2,5] and applied [3] point of view. In the shorter term, some standard compliant solutions can be found.

This paper intends to present a new design and fabrication workflow that takes advantage of digital fabrication to manufacture Eurocode 2 compliant optimised beams. By using 3D printed concrete moulds to protect the hollow parts of truss-like beams, we are able to address the geometric complexity of the formwork. This process drastically reduces the wastes as compared to those that would be produced with a traditional formwork. Section 2 introduces the design methodology based on a struts optimisation approach. Section 3 presents the fabrication of a 3-meter-long beam illustrating the feasibility of the proposed method. Eventually, in section 4 we discuss the potential material savings at stake as well as the levers to enhance the fabrication process in the perspective of its application in the industry.

2 Design methodology

2.1 Computational workflow

The whole design and fabrication process is automated under the computational workflow presented in Figure 1. Based on design requirements, a preliminary EC2 calculation results in the generation of a family of optimal designs from which one is selected based on material savings and manufacturing considerations. A finite element assessment of this design, not considered in this paper, could then be provided before the fabrication phase. This paper focuses on the printing of the formwork which is therefore the only criterion considered to assess the constructability of the design. As discuss in section 4.2, more criteria would have to be taken into account for industrial applications.

2.2 Reinforced concrete beam design at EC 2

Traditional RC beam design involves three main steps. Firstly, longitudinal reinforcements are calculated based on mid-span section equilibrium considerations at ULS and SLS requirements such as maximum displacement, cracks opening, rebars and concrete constraints. Subsequently, shear reinforcements are calculated to provide minimum shear resistance at ULS. The calculation is performed with discrete values of shear force taking the minimum design value V_{Ed} over a beam portion with a length of $zcot\theta$ (see Figure 3 for notations). Lastly, it is possible to perform longitudinal rebar curtailment. In practice, this step is often neglected so as to simplify the rebar cage preparation. It is worth precising that although minimal steel sections are structural requirements consequences, effective reinforcement is highly impacted by the geometric constraints (notably the width of the beam) as well as the fabrication method.

As presented in Figure 2, we propose a new EC2 compliant approach for the shear design of RC beams. This approach is detailed in section 2.3

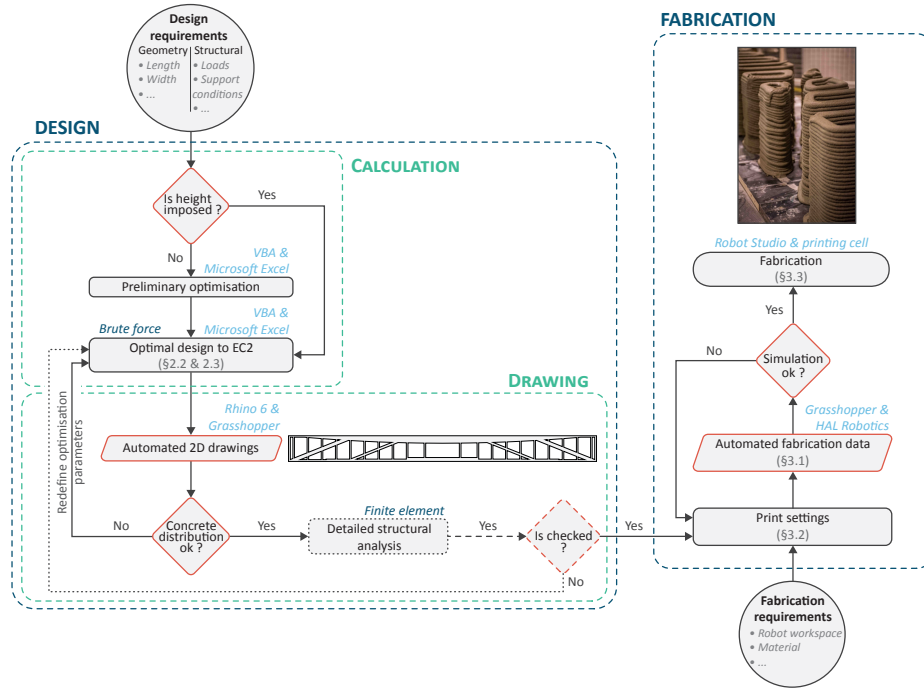

Fig. 1: Computational workflow.

2.3 Shear strength of reinforced members in the Eurocode 2

The shear strength design methodology prescribed by the EC2 for RC elements is based on the Variable Strut Inclination Method (VSIM) [1] applied to a strut-and-tie model of the given element, see Figure 3. In this method, derived from the first truss analogy models proposed by Ritter [9] and Mörsh [6] the direct contribution of concrete to the shear resistance is ignored. The shear strength of the element is thus given by the minimum between the compressive strength of the concrete (namely the struts, Eq. 1) and the tensile strength of the stirrups (namely the ties, Eq. 2).

$$\begin{aligned}
 V_{Rd,max} &= \sigma_c b_w \cos\left(\alpha + \theta - \frac{\pi}{2}\right) \cdot l_w \sin\theta \\
 &= \underbrace{a_{cw} \nu_1 f_{cd}}_{\text{max. stress}} \underbrace{b_w z \cdot \frac{\sin(\alpha + \theta)}{\sin\alpha}}_{\text{width and height of the strut}} \cdot \sin\theta
 \end{aligned} \quad (1)$$

$$V_{Rd,s} = \frac{A_{sw}}{s} f_{ywd} z (\cot\theta + \cot\alpha) \cdot \sin\alpha \quad (2)$$

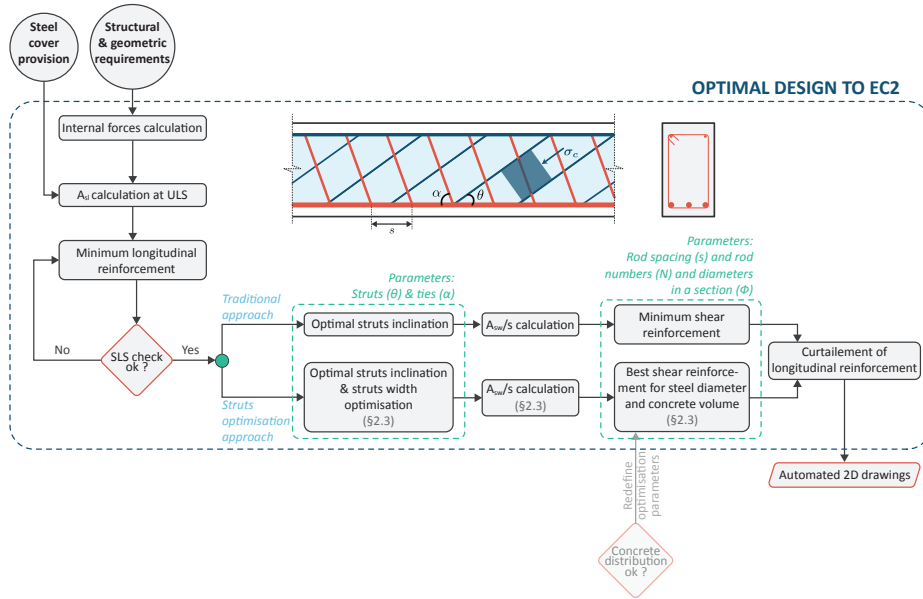

Fig. 2: Eurocode 2 beam design workflow.

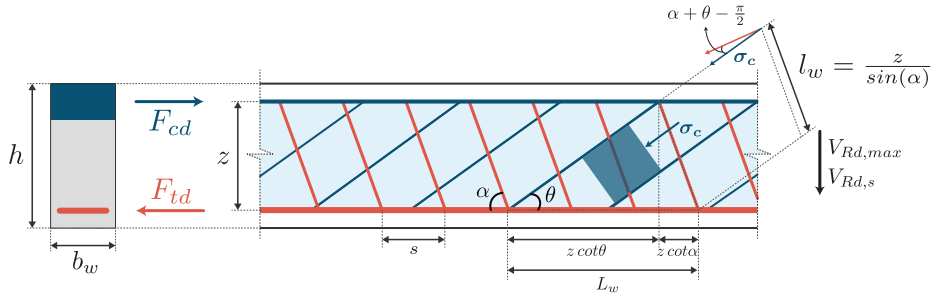

Fig. 3: Eurocode 2 strut-and-tie model for RC elements with shear reinforcements.

In the spirit of the EC2, an engineer is only given design freedom through the choice of the inclination of both the struts ($21,8^\circ \leq \theta \leq 45^\circ$) and the ties ($45^\circ \leq \alpha \leq 90^\circ$) within some empirically determined limits. All other parameters values are set by the mechanical properties of the materials: f_{ywd} and f_{cd} ; by the state of stress in the section: a_{cw} and ν_1 ; and by the geometry of the section and the previous design steps: b_w and z (inner lever arm for a member with constant depth).

In practice, an engineer would first optimise A_{sw} by properly defining the number and diameter of rods in a section as well as the spacing s between two reinforced section. He would then only check that $V_{Ed} \leq V_{Rd,max}$. Otherwise, he

would increase the strut angle θ . However, as written in Equation 1, the strength of the struts involves the compressive strength of the concrete as well as their width and depth letting one the opportunity to optimise over b_w or z . Our design proposal is based on the struts height optimisation. The minimum strut height is thus given by Equation 3. Figure 4 presents a schematic representation of a beam designed with this method and following the steps detailed in section 2.2.

$$z_{opt} = z \cdot \frac{V_{Ed}}{V_{Rd,max}} \quad (3)$$

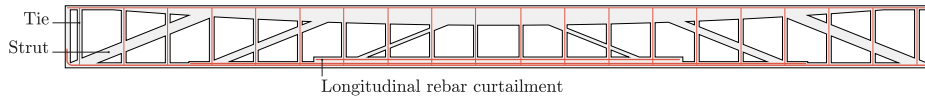

Fig. 4: Schematic representation of a beam designed with the struts optimisation approach.

The next section presents the fabrication of prototype designed with the struts optimisation method.

3 Case study: Concrete printed formwork for a 3m-long beam

3.1 Automated fabrication data generation

The beams EC2 design is done on Excel based on calculation sheets developed by ISC. The results are then exported to Grasshopper. A first set of ‘shop’ drawings is automatically generated to check the concrete distribution on the one hand and serve as a basis for the fabrication data generation on the other hand. From this stage, everything is managed with the HAL Robotics plug-in using Rhino 6 to visualise the data. Hence, the workflow is fully automated from the calculation to the export of the robot procedure. Figure 5 features some examples of 2D beam drawings automatically generated with the workflow.

3.2 Experimental setup & Fabrication

The fabrication process can be divided into two parts: the preparation of the formwork and pouring of the concrete. The formwork contour and lost casing were made with sheets of plywood while the inner formwork pieces were directly printed on the lost casing within our 3d concrete printing cell equipped with a Xtree printing head. The Xtree’s technology demands to keep a constant time frame between each extruded layer. For such an application, this time constraint raises issues in terms of concrete and accelerator flow rate management as well as for the robot speed. For instance, for the prototype, the ratio between the longest

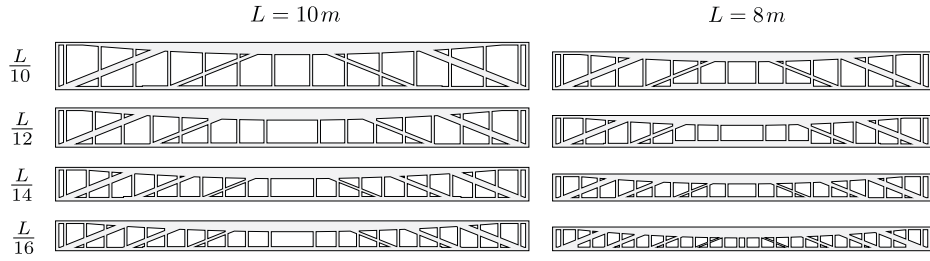
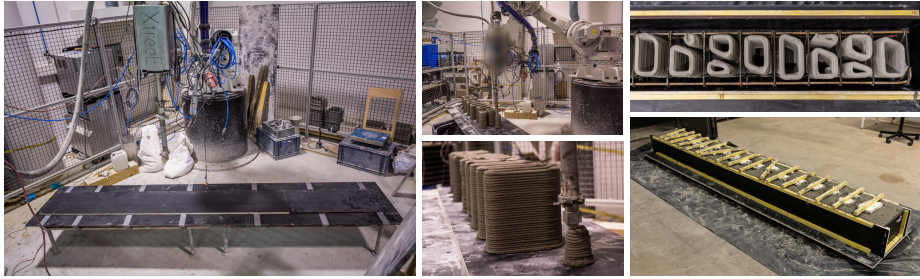

Fig. 5: Benchmark of automatically generated ‘shop’ drawings.



(a) Fabrication of the prototype with, from left to right, preparation of the printing cell, printing of the formwork, final preparation of the formwork and, pouring of the concrete



(b) Demoulding of the beam

Fig. 6: Fabrication of the 3m-long beam prototype

printed piece perimeter and the shortest one was of 4.46. However, pouring concrete remained the biggest challenge. It is well known that the EC2 includes a large amount of rules driven by the need for the concrete to set evenly in the formwork: minimum spacing between the rebars, etc. Here, the narrowness between the rebar cage, the printed pieces and the plywood sheets augments the necessity for carefully formulating the concrete. For this case study, typical distances between the surface of two printed pieces were of 6cm with a rebar (HA 6) in between. The formwork required 80 minutes of printing for a total of 93kg of printed concrete. Additionally, 359kg of concrete was poured. The steel ratio for the prototype is 66 kg/m^3 .

The next section tackles the potential material savings and the fabrication implications at stake.

4 Discussion on the Potential Material Savings & on the Fabrication Process

4.1 Potential material savings with the struts optimisation approach

Loads and material properties All the beam designs presented in this section were done with the same hypothesis. The beams are considered to be simply supported and are subjected to uniformly distributed dead and live loads. The dead loads include the self-weight of the beam and that of a 17cm thick concrete slab with a span of 5m. The live loads have a characteristic value of 1.5 kN/m². Appropriate ULS and SLS combinations are taken into account. We consider a concrete of class C30/37 with a density of 2500 kg/m³ and a steel of class B500B.

Optimisation results Figure 7 presents ratios between concrete volumes in beams designed with the struts optimisation approach and those of their equivalent prismatic beams. The evolution of this ratio with the span is read horizontally while its evolution with the slenderness is read vertically. The smaller the dots and the lighter the shade, the lower the ratio. And, the lower the ratio, the higher the concrete savings.

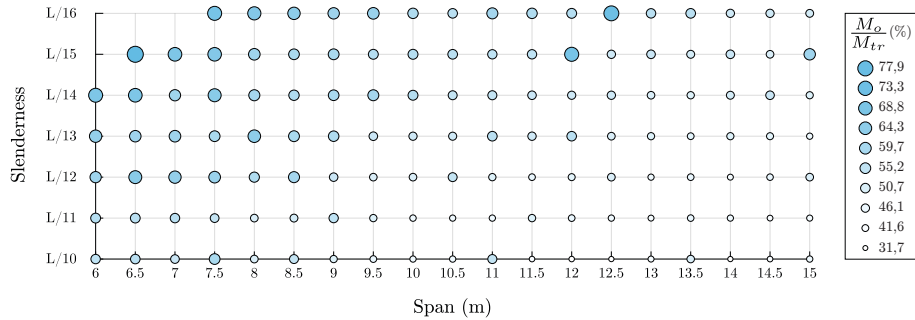

Fig. 7: Evolution of the weight gain with the span and the slenderness (M_o - mass of the optimised beam, M_{tr} - mass of the traditional prismatic beam).

As expected, the potential concrete savings increase with the span and the slenderness. Some a priori unpredictable peaks can however be observed (11m - L/10 and 12m - L/15 for instance). Those peaks reflect the way the effective shear reinforcements are calculated. As presented in Figure 2, there are three optimisation parameters, the number of rods in a reinforced section, the diameter of those rods and the spacing between two reinforced section. The peaks are due to particular cases for which the minimum possible effective shear reinforcement was obtained for small spacings between two adjacent reinforced sections. This

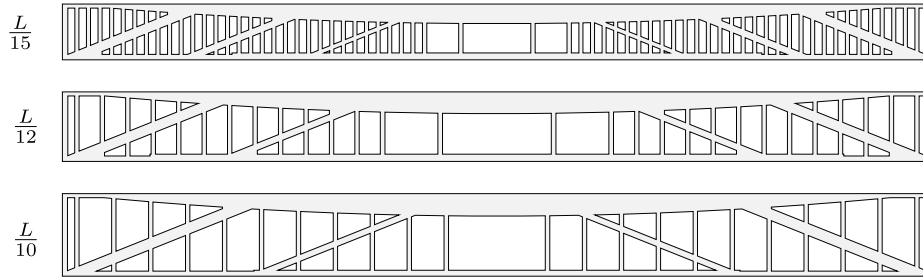

Fig. 8: Examples of beam designs obtained when the only criterion for the optimisation of the ties is the effective steel section.

results in a high consumption of inefficiently used concrete. Figure 8 gives a schematic representation of some beam designs for a span of 12m. The first beam ($L/15$) highlights this phenomenon. A reformulation of this problem, in the form of a multi-objective optimisation problem taking into account both the effective steel section and the spacing, allows for a better control of the concrete savings.

Concrete savings Most importantly, Figure 7 shows ratios between 31,7 to 77,9% and thus demonstrates a weight gain in the range of 22 to 68%. In reinforced concrete buildings, beams commonly have a slenderness of about $L/10$ to $L/12$ and a span of 6 to 9m, a range for which our approach leads to considerable savings of about 32 to 58%. Those values of slenderness are not considered to be optimised from a mechanical point of view but they provide an important lever arm. This enables to have low ratios of steel which tends to ease the fabrication process both in terms of assembly of the rebars and pouring of the concrete. But even for lower slenderness, the savings remain important, ranging from 22 to 45%.

These gains need to be seen in perspective. For traditional office buildings, for which the frame is the predominant structural design, there is a direct saving but also an indirect saving through a global reduction of the self weight of the structure. This notably contributes to a reduction of the foundations sizing. For acoustic reasons, traditional housing buildings are more often designed as wall-slab structures. From a purely mechanical point of view, this seems nonsensical in the current context. We see here a challenge that remains unsolved.

4.2 Discussion on the fabrication

Several technical issues were raised during the construction of the prototype. Firstly, as mentioned in the previous section, the layers length distribution is critical and would be even more complex to manage for real applications. Typically, for a 7m-long beam with a slenderness of $L/15$, the ratio between the longest printed piece perimeter and the shortest one would be 7.18. Then, the

order of magnitude for the precision of the rebars placement, which were manually assembled on a work site, was ten times higher than that of the formwork (both plywood and concrete parts). It was impossible to insert the rebar cage inside the formwork at first. For future applications, it will be necessary to better control each stage of the process, notably by automating the assembly of the rebars. Similarly, an easily replicable method has yet to be found to prevent the displacement of the printed pieces during the vibration of the formwork without making their retrieval too complicated in the hypothesis of a fully recyclable 3D printed formwork.

From an economical point of view, it is clear that a simpler but more robust printing technology should be used. Typically, a 3-axis robot would be more appropriate. The biggest lever however remains the printed material. Currently, a major part of the formwork cost (both economic and environmental) is in the printed concrete.

5 Conclusion & Perspectives

Reinforced concrete construction industry is marked by an over and inefficient consumption of concrete. This paper presented a strut optimisation approach, compliant with EC2 requirements at ULS, SLS and for construction detailing. This method results in up to 60% raw material savings. The associated fabrication process is enabled by digital fabrication and 3D printing. A 3m-long prototype was built to prove the constructability of beams designed with the proposed method.

The construction industry is to face major challenges, notably the environmental crisis and the population growth, in the coming years. We believe that it is necessary to find applicable solutions in the very short term. But, the development and transfer of such solutions to the industry will be determined by the ability of all players at stake to rally around a common purpose. Environmental experts are needed to assess the soundness of digital fabrication processes and economists to assess their viability, structural and material specialists are required to propose new ways of building and confirm the proper mechanical behaviour of their proposals, contractors must ensure their implementation at large scale, ... Our proposal is part of this ongoing effort.

Acknowledgment The authors are grateful to Léo Demont, Paul Carneau and Nicolas Ducoulombier for their help during the printing of the formwork. We sincerely thank Christophe Bernard for his technical assistance during the whole fabrication process.

This work was made during Mr. Maitenaz doctorate within the framework of an industrial agreement for training through research (CIFRE number 2018/1055) jointly financed by the company VCF TP IDF SA (Vinci Construction France), and the National Association for Research and Technology (ANRT) of France.

References

1. EN 1992-1-1: Eurocode 2 - Design of concrete structures - Part 1-1: General rules and rules for buildings. Standard, European committee for standardization, Brussels (2004)
2. Amir, O.: A topology optimization procedure for reinforced concrete structures. *Computers & Structures* **114-115**, 46–58 (Jan 2013). <https://doi.org/10.1016/j.compstruc.2012.10.011>
3. Asprone, D., Auricchio, F., Menna, C., Mercuri, V.: 3D printing of reinforced concrete elements: Technology and design approach. *Construction and Building Materials* **165**, 218–231 (Mar 2018). <https://doi.org/10.1016/j.conbuildmat.2018.01.018>
4. Billington, D.P.: *Robert Maillart and the Art of Reinforced Concrete* (1991)
5. Gaynor, A.T., Guest, J.K., Moen, C.D.: Reinforced concrete force visualization and design using bilinear truss-continuum topology optimization **139**(4), 607–618. [https://doi.org/10.1061/\(ASCE\)ST.1943-541X.0000692](https://doi.org/10.1061/(ASCE)ST.1943-541X.0000692)
6. Mörsch, E.: *Der Eisenbetonbau, seine Theorie und Anwendung*. Wittwer, Stuttgart (1908)
7. Orr, J., Drewniok, M.P., Walker, I., Ibell, T., Copping, A., Emmitt, S.: Minimising energy in construction: Practitioners’ views on material efficiency **140**, 125–136. <https://doi.org/10.1016/j.resconrec.2018.09.015>
8. Querin, O.M., Victoria, M., Martí, P.: Topology optimization of truss-like continua with different material properties in tension and compression **42**(1), 25–32. <https://doi.org/10.1007/s00158-009-0473-2>
9. Ritter, W.: Die Bauweise Hennebique (Hennebique’s Construction Method). *Schweizerische Bauzeitung* **33**(7), 59–61 (February 1899)