

VI seminario Ostiense

Ostia-Portus, hub de l'empire romain

10/11 aprile 2019

Parco Archeologico di Ostia Antica – École française de Rome

MARCELLO TURCI

Dinamiche urbane pre-adrianee nel settore costiero della città di Ostia.

Nuovi dati dai contesti delle Terme Marittime e delle Terme di Porta Marina





Base Google Earth



1. dinamiche di superamento delle mura tardo repubblicana;
2. linee di sviluppo del quartiere (fine I sec. a.C. – inizi II sec. d.C.);
3. Modalità di cantiere in epoca adrianea

“Questo quartiere prospiciente al mare si sviluppa sotto Traiano con l’impianto delle due insule adiacenti alla Domus Fulminata, ..., ma è soprattutto con Adriano che la zona accresce il suo carattere monumentale colla costruzione della grande piazza porticata...”

GIOVANNI BECATTI, *Scavi di Ostia. VI*, p. 51.

Terme Marittime (VIII, III, 2)

LEGEND

Before "Terme Marittime"	"Terme Marittime"	After "Terme Marittime"
Phase 0-1 1st century BC	Phase 1 Hadrian's reign	Phase 6 4th century AD
Phase 0-2 1st century BC	Phase 1b	
Phase 0-3 first half of 1st century AD	Phase 2 late Antoninus Pius's reign	
Phase 0-4 late 1st century AD	Phase 3 early Caracalla's reign	
Phase 0-5 early 2nd century AD	Phase 4 Alessandro Severo's reign	
	Phase 5 late 3th/early 4th century AD	



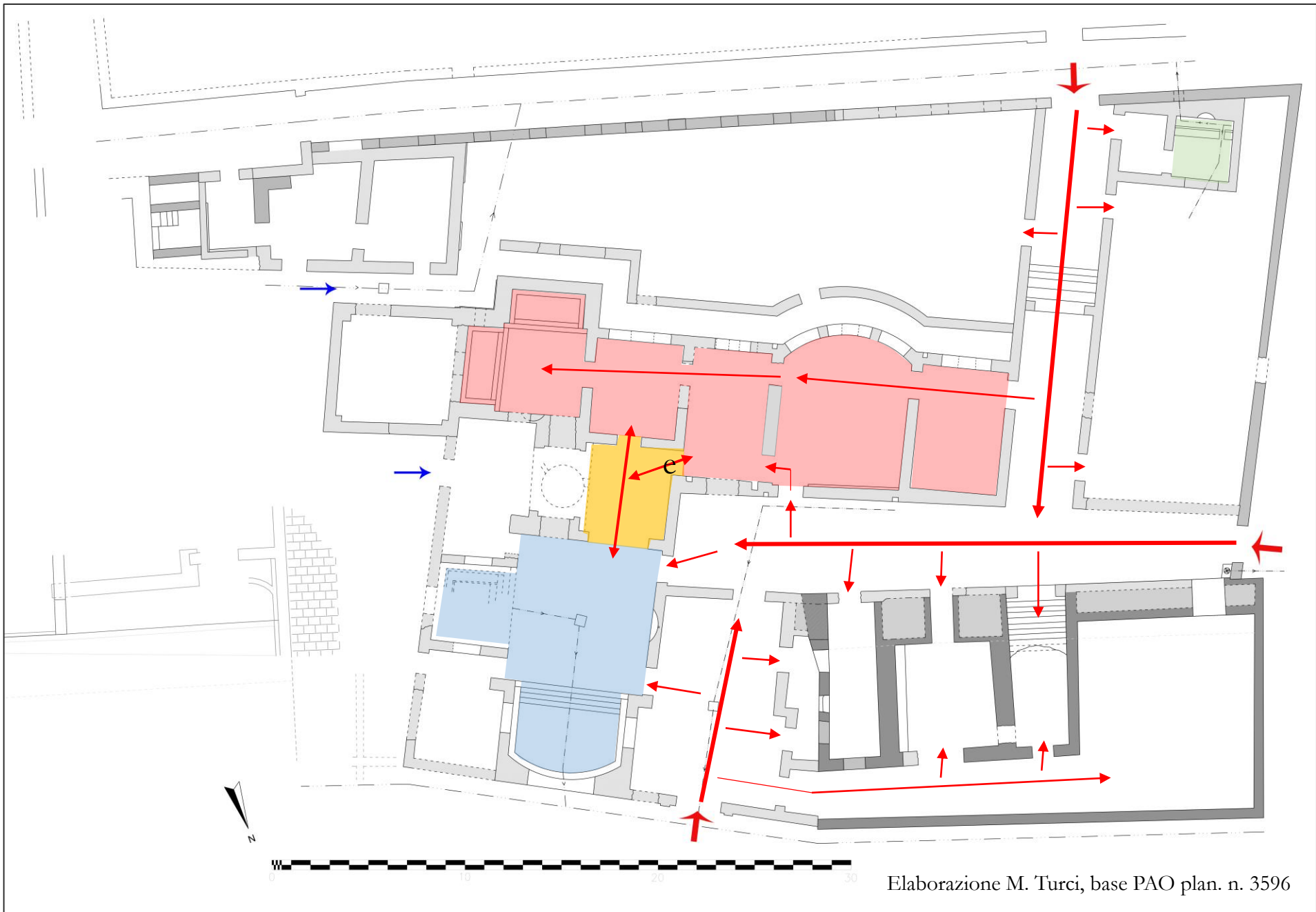

Elaborazione M. Turci, base PAO plan. n. 3596



Elaborazione M. Turci, base PAO plan. n. 3596

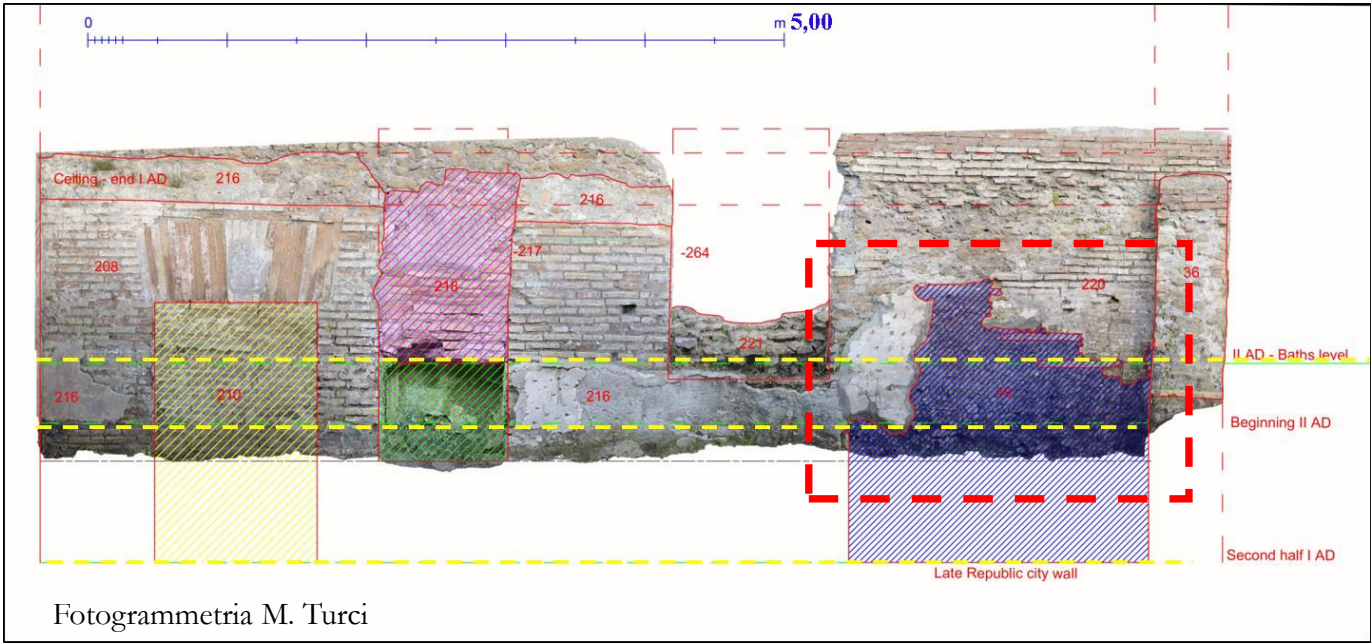
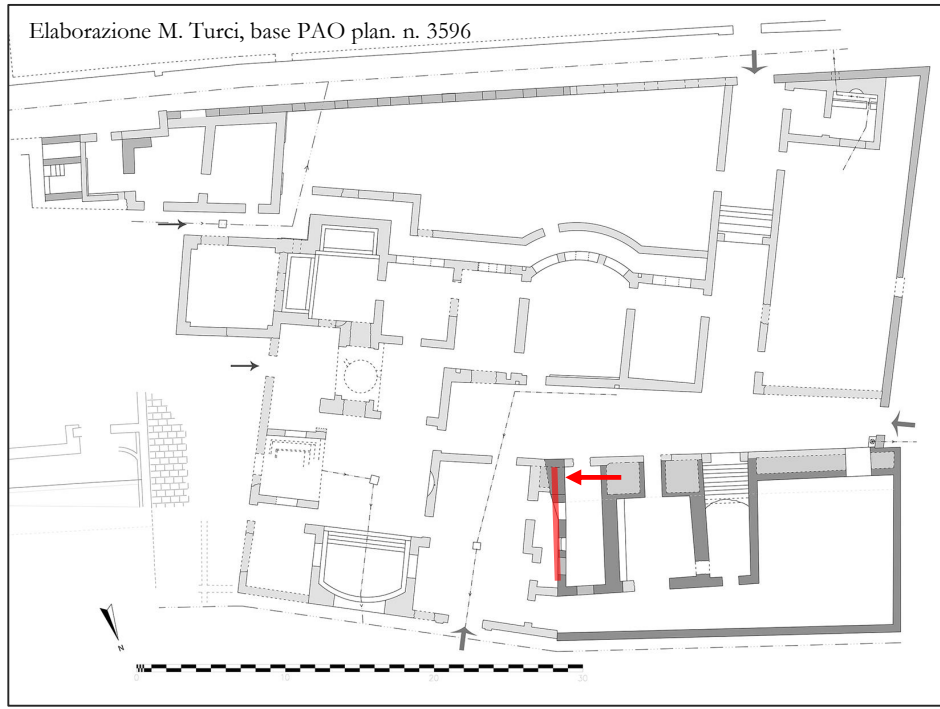



Elaborazione M. Turci, base PAO plan. n. 3596

Terme Marittime (VIII, III, 2): amb. 33

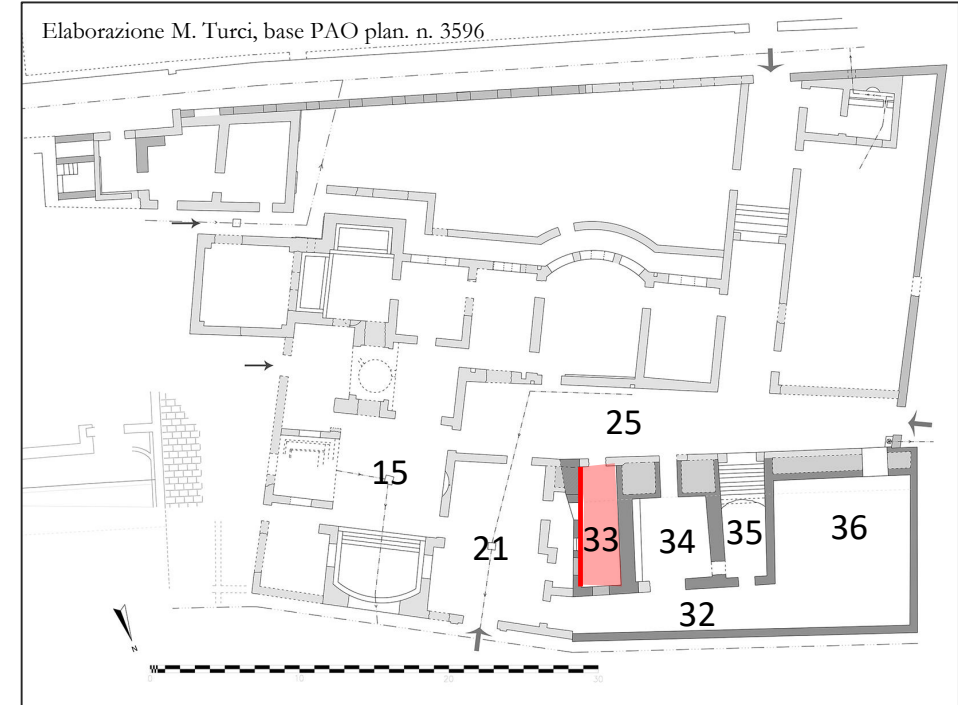
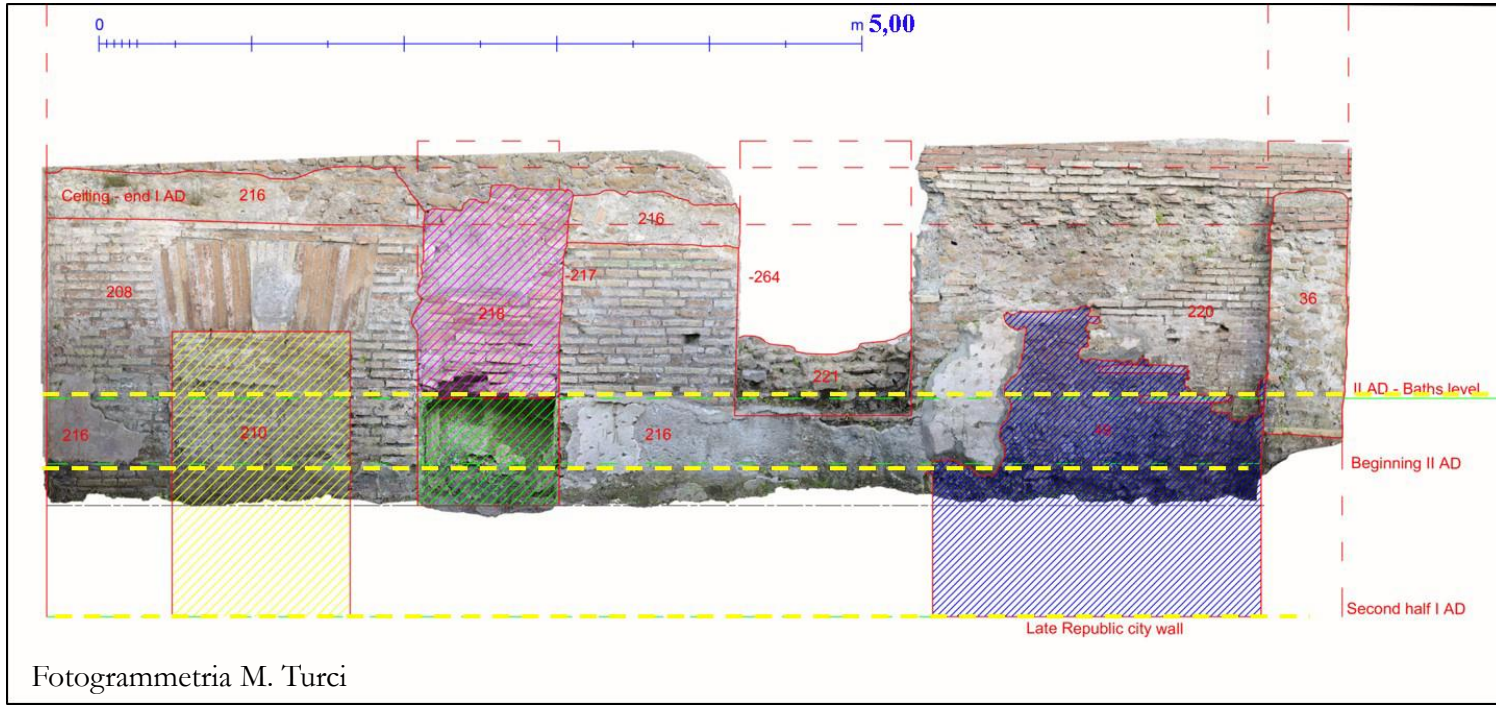

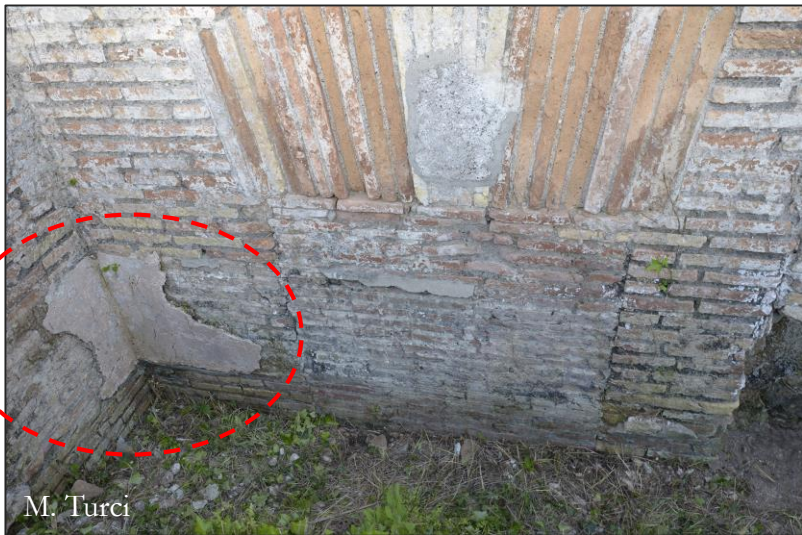
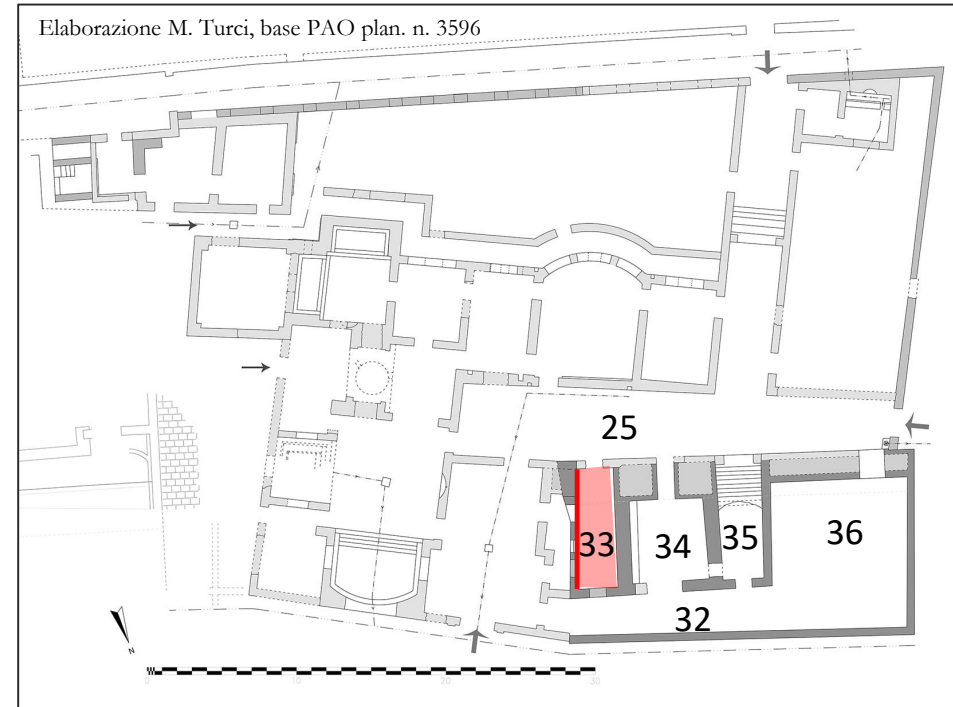
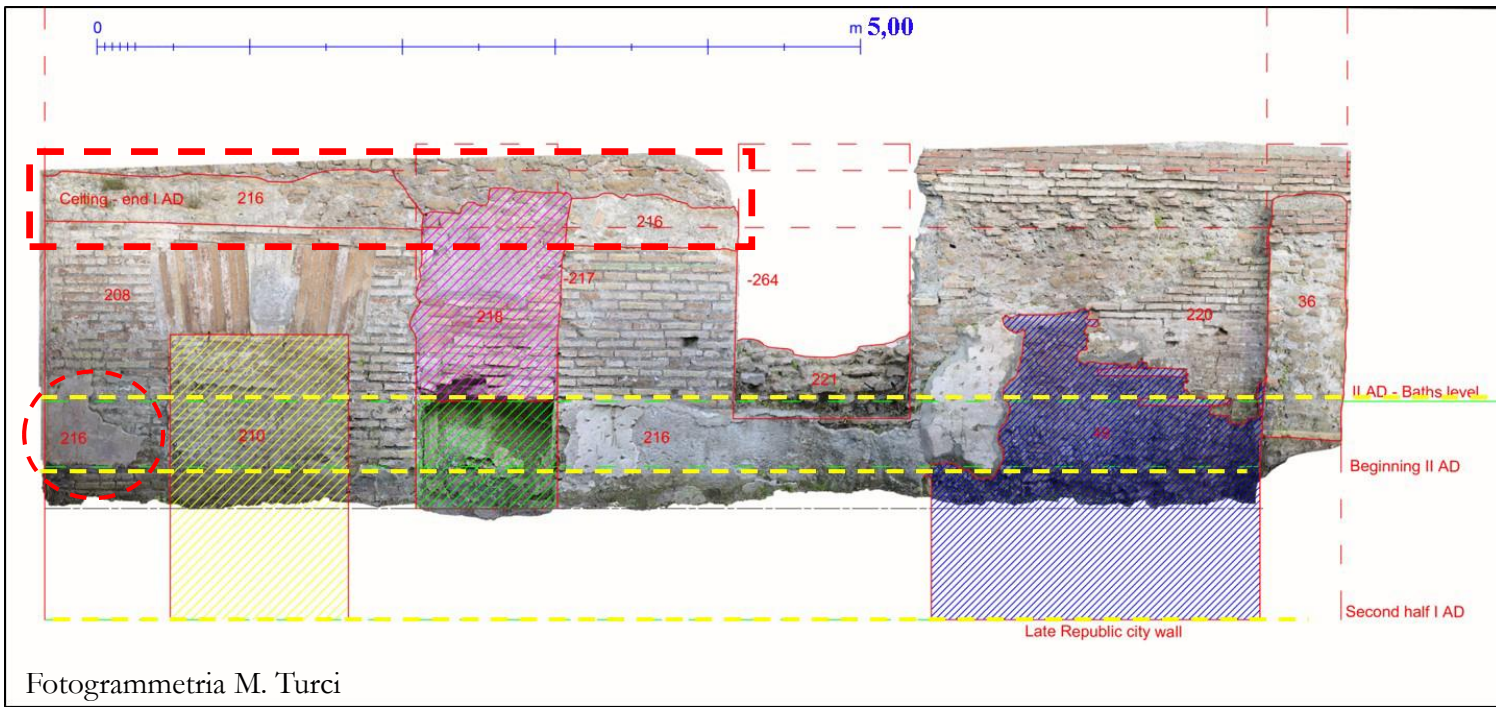

Terme Marittime (III, VIII, 2): ampliamento dell'età di Caracalla

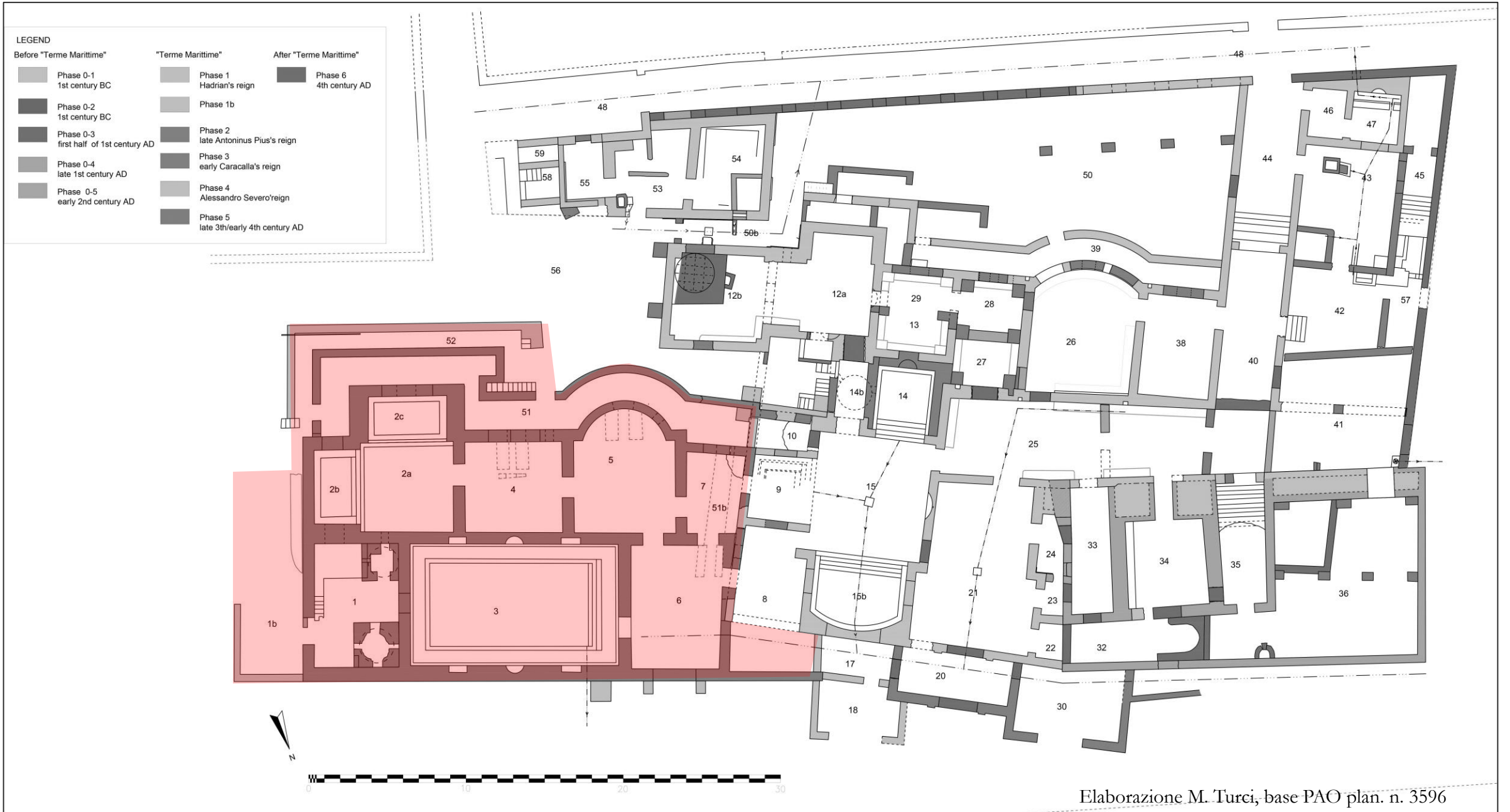





Elaborazione M. Turci, base PAO plan. n. 3596

Terme Marittime (III, VIII, 2), amb. 2

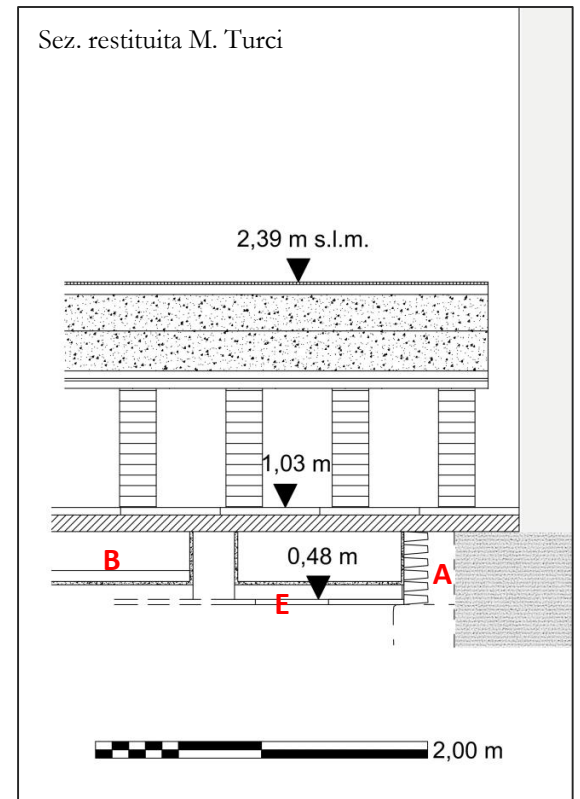
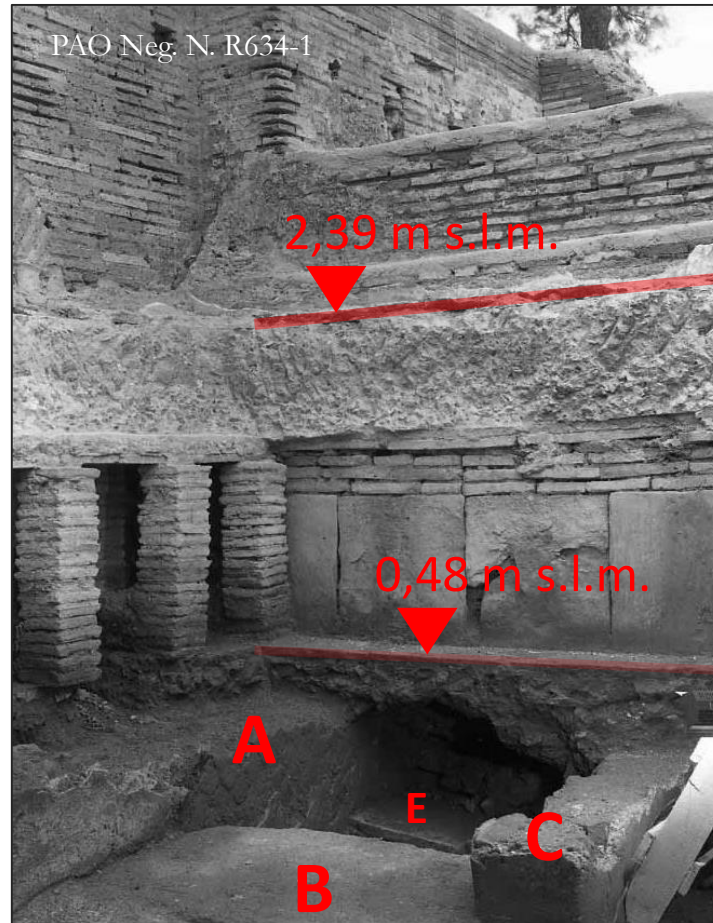
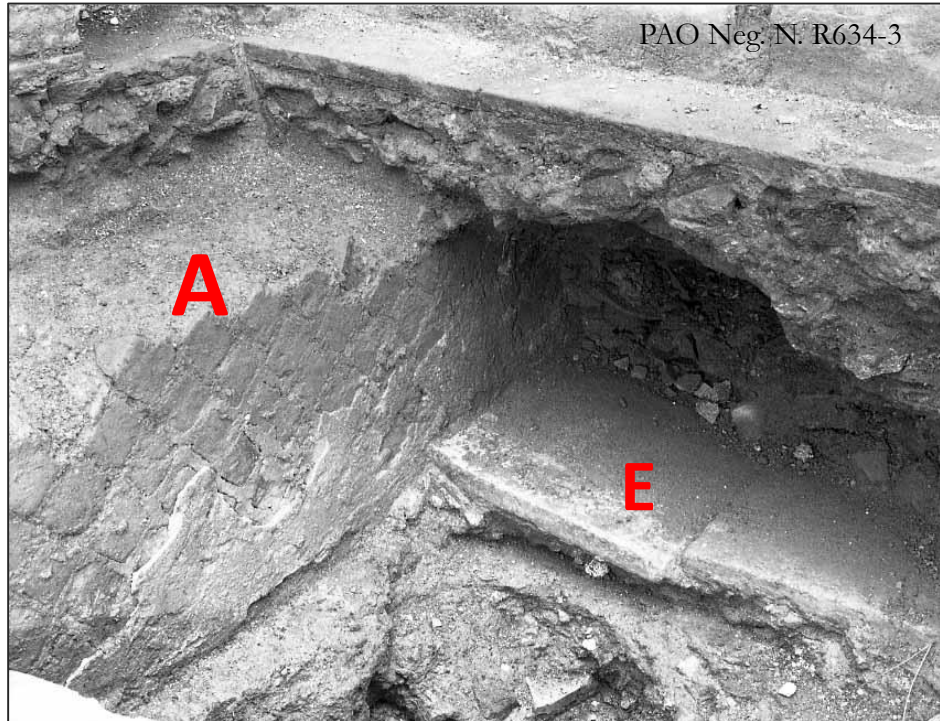
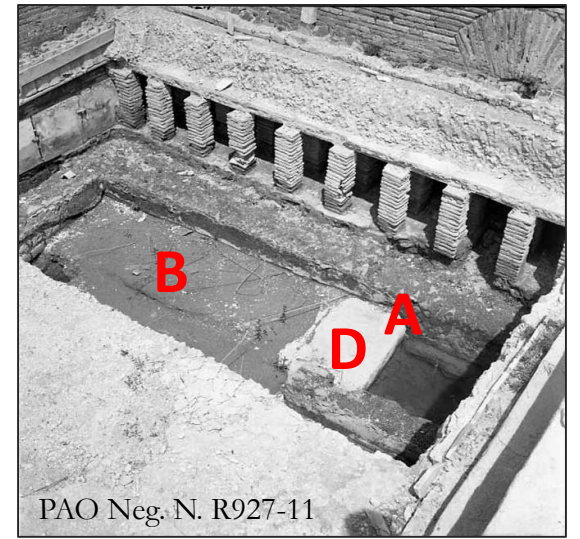



Elaborazione M. Turci, base PAO plan. n. 3596

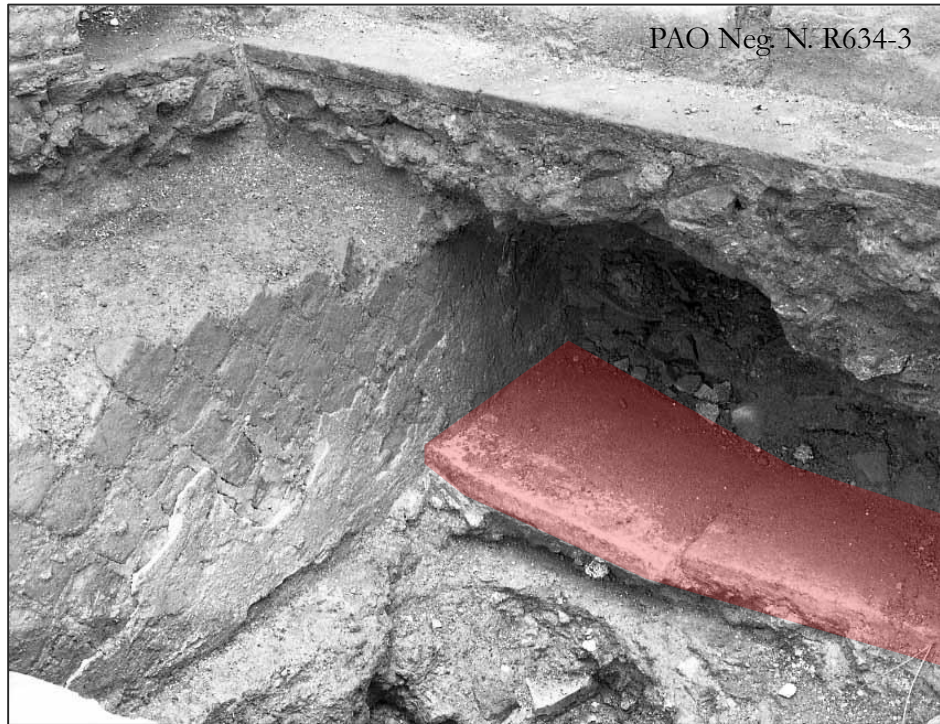

PAO Neg. N. R634-3

Terme Marittime (III, VIII, 2)
Amb. 2

Sez. restituita M. Turci

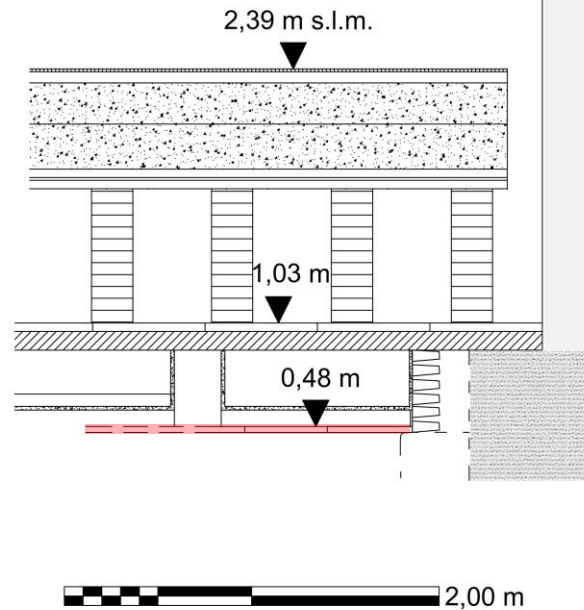

[---] *artus(?) fecit*

St(ati) Marci Neonis
Atimetus fec(it) <r. p. ss.>



(CIL XV 1280 - GATTI 1950)

Chrsidi P^hilomsi

L. A^rr^un^ti P^hiloxeni



(CIL XV 839)

Terme Marittime (III, VIII, 2), amb. 2



Elaborazione M. Turci, base PAO plan. n. 3596

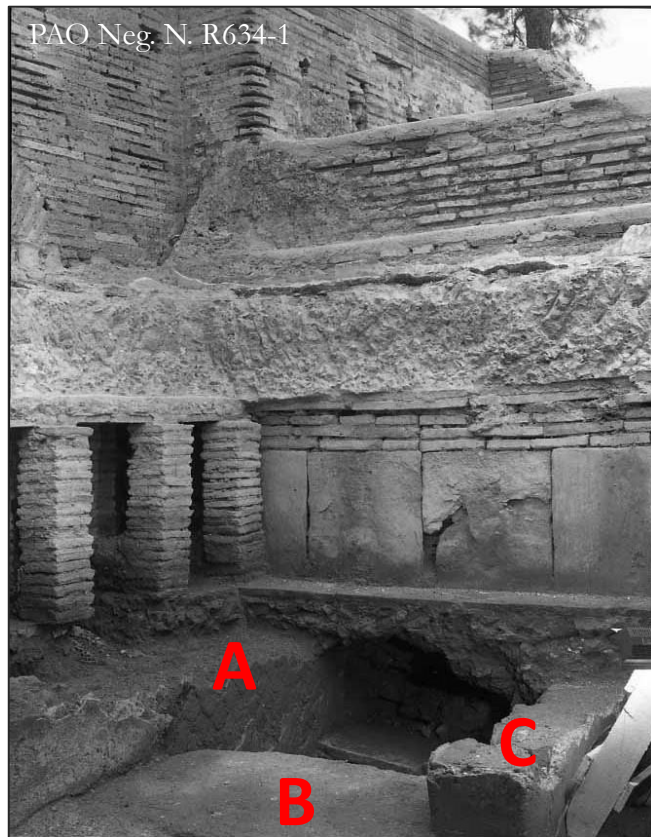

PAO Neg. N. R634-1



PAO Neg. N.596-10

Terme Marittime (III, VIII, 2), amb. 4



Elaborazione M. Turci, base PAO plan. n. 3596



PAO Neg. N. R599-4

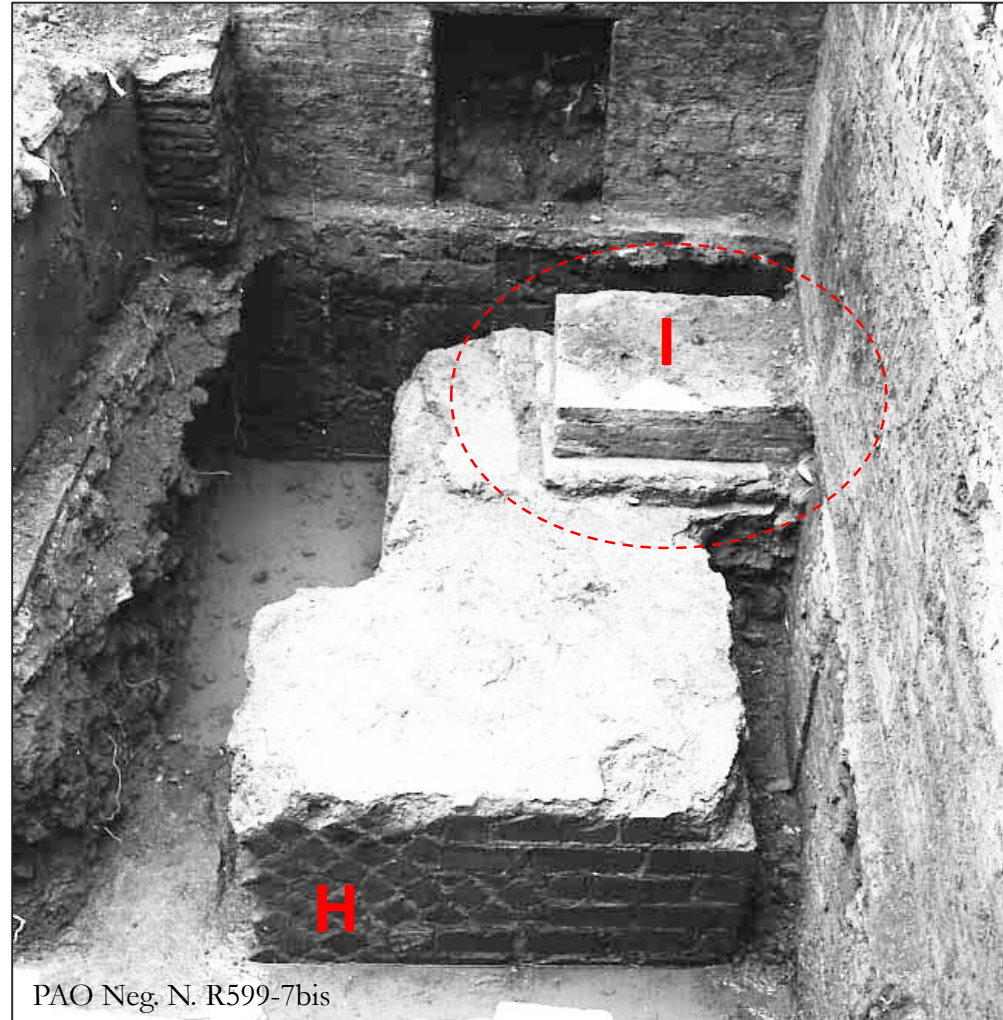

PAO Neg. N. R599-7bis

PAO Neg. N. R636-5

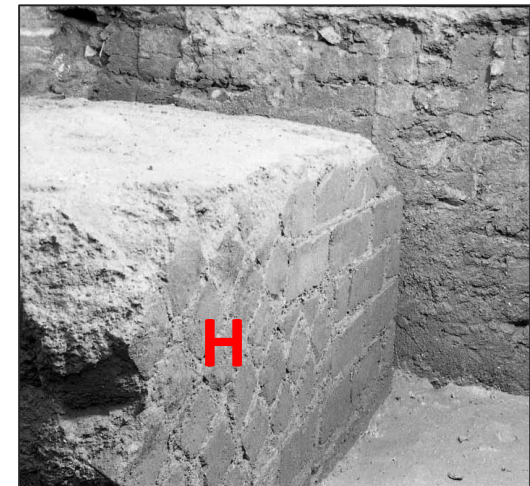

Terme Marittime (III, VIII, 2), amb. 5



Elaborazione M. Turci, base PAO plan. n. 3596

Terme Marittime (III, VIII, 2), amb. 4

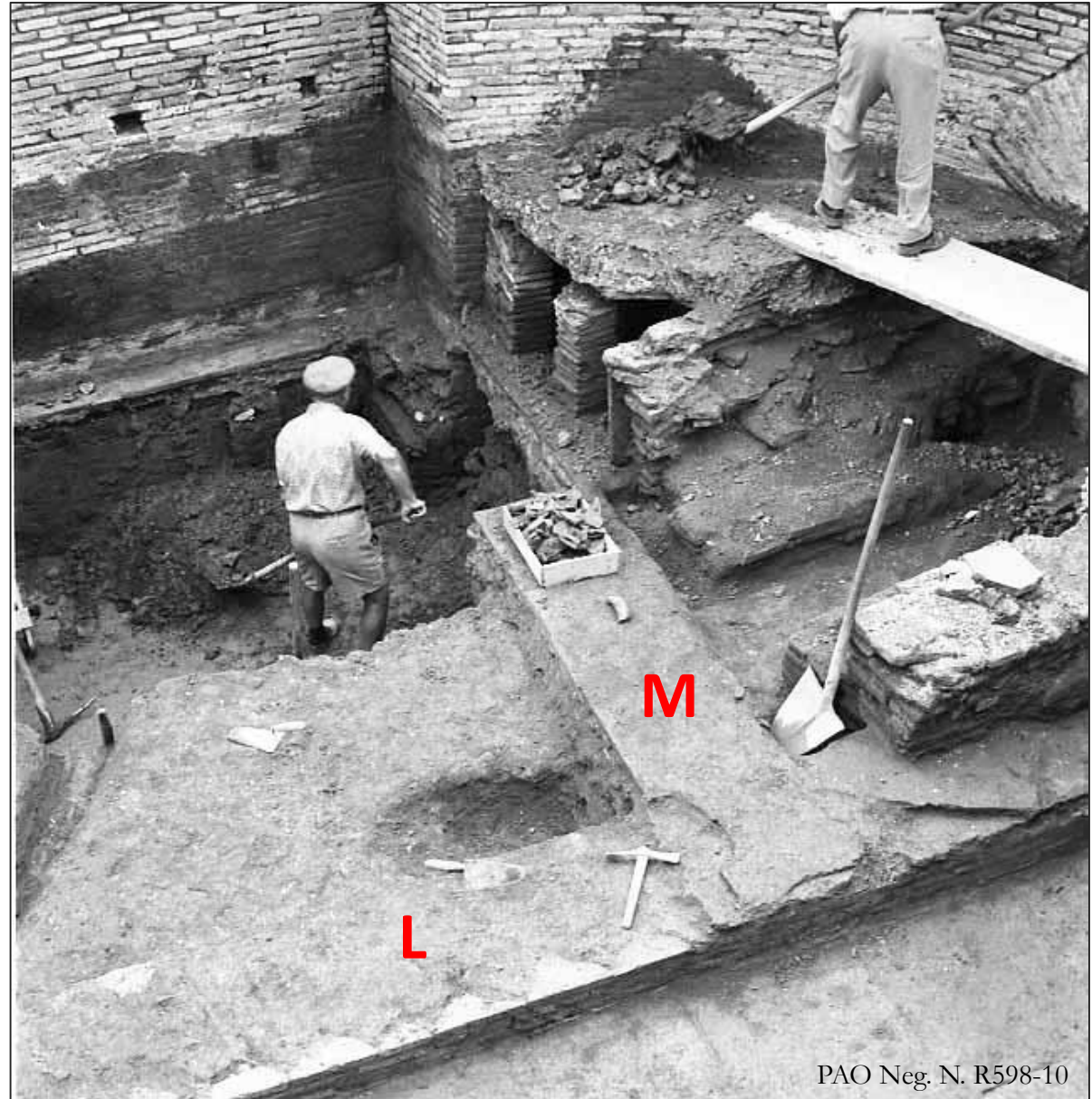
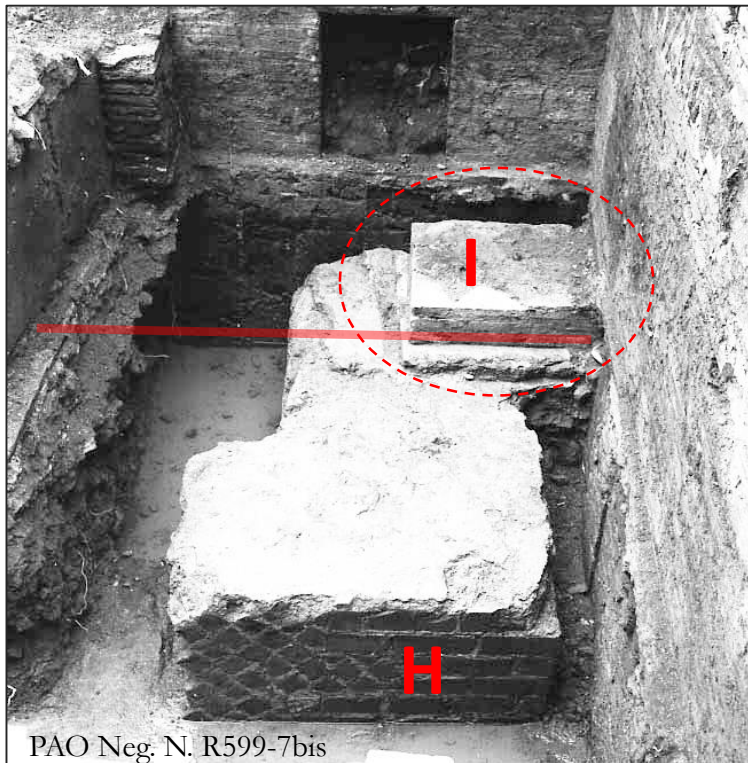

Terme Marittime (III, VIII, 2), amb. 5



Elaborazione M. Turci, base PAO plan. n. 3596

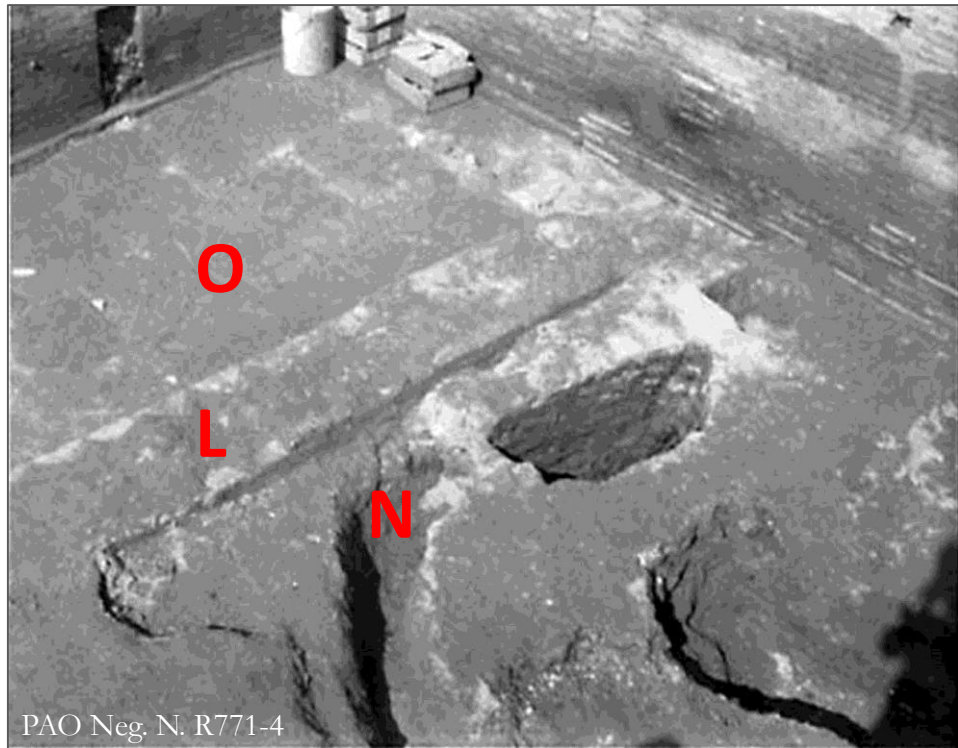

PAO Neg. N. R771-4

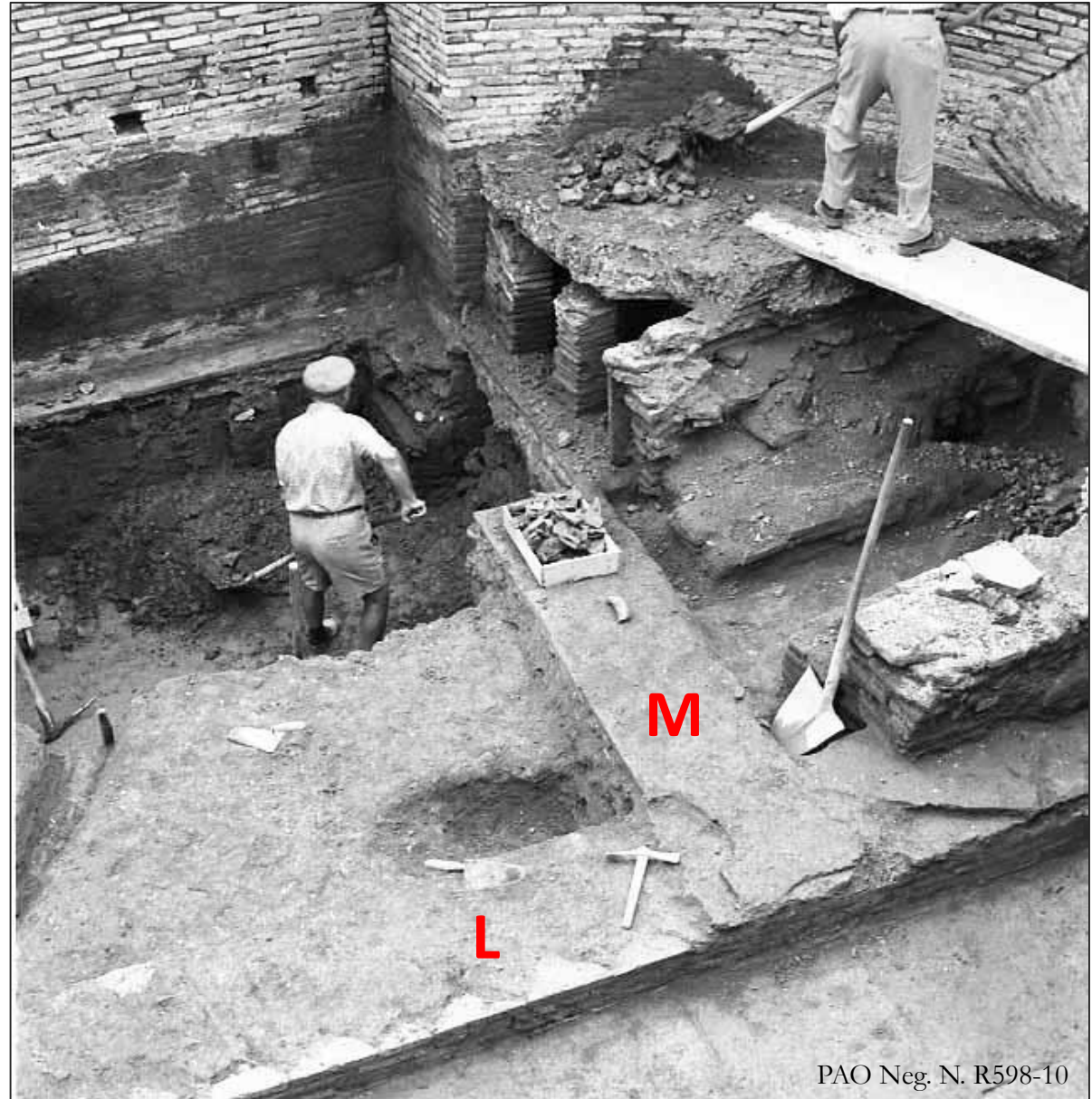

PAO Neg. N. R598-10

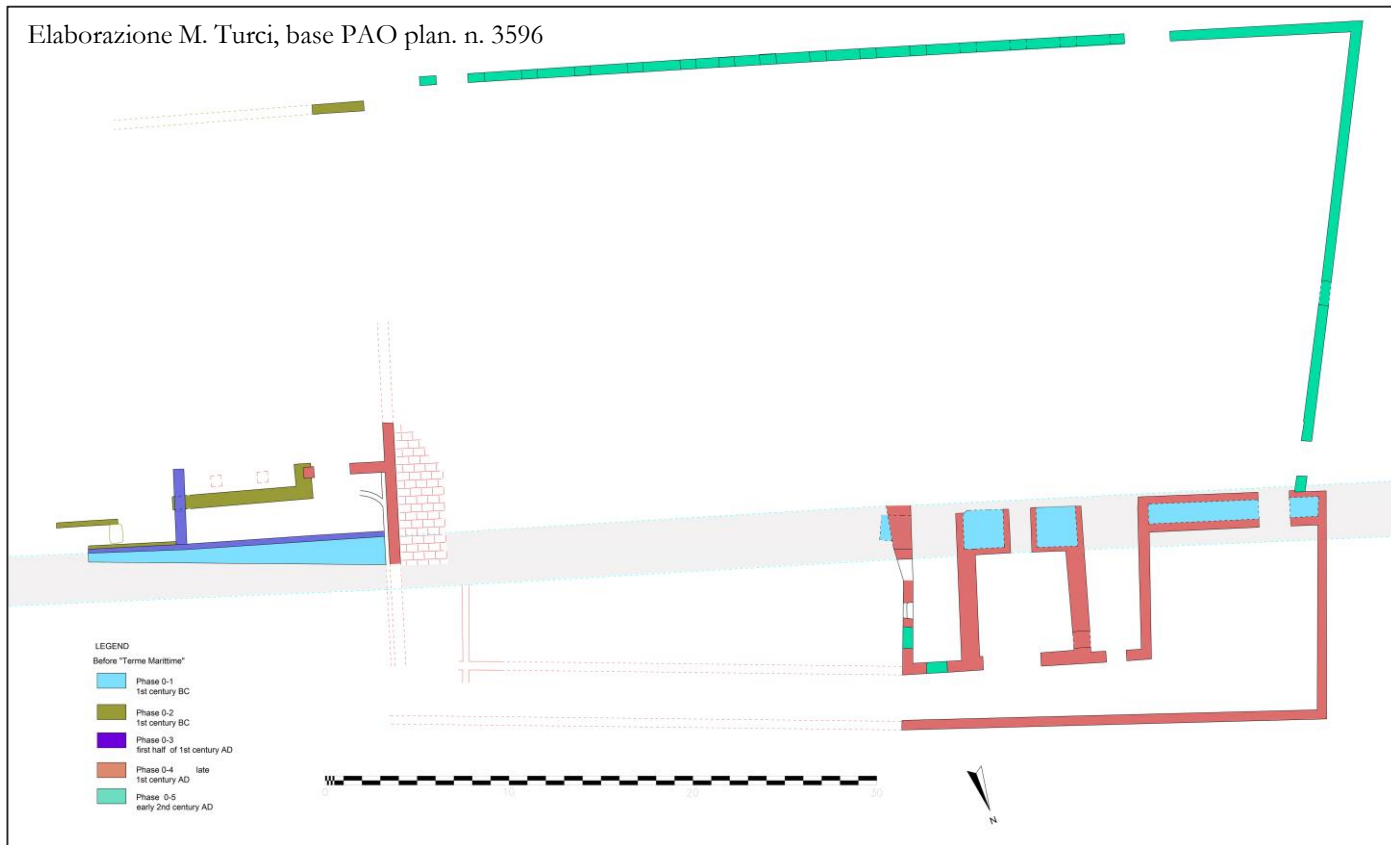

1. Mura tardo-repubblicane
- 2a. Inizi I sec. d.C.
- 2b. 37-41 d.C.
3. Terzo quarto I sec. d.C.
4. Fine I - inizi II sec. d.C.

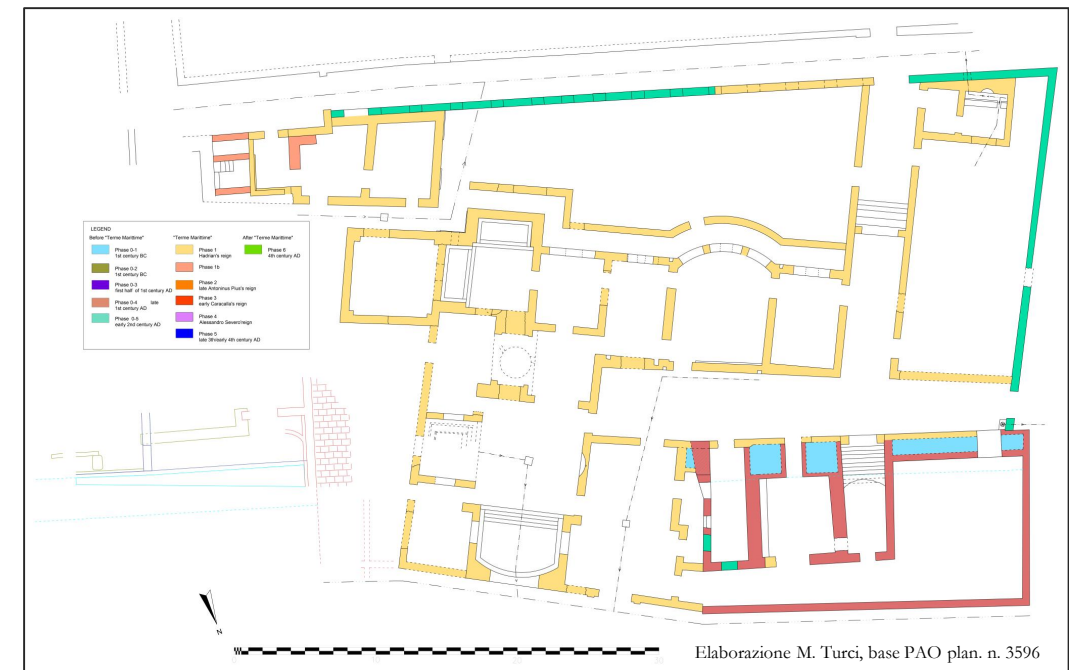

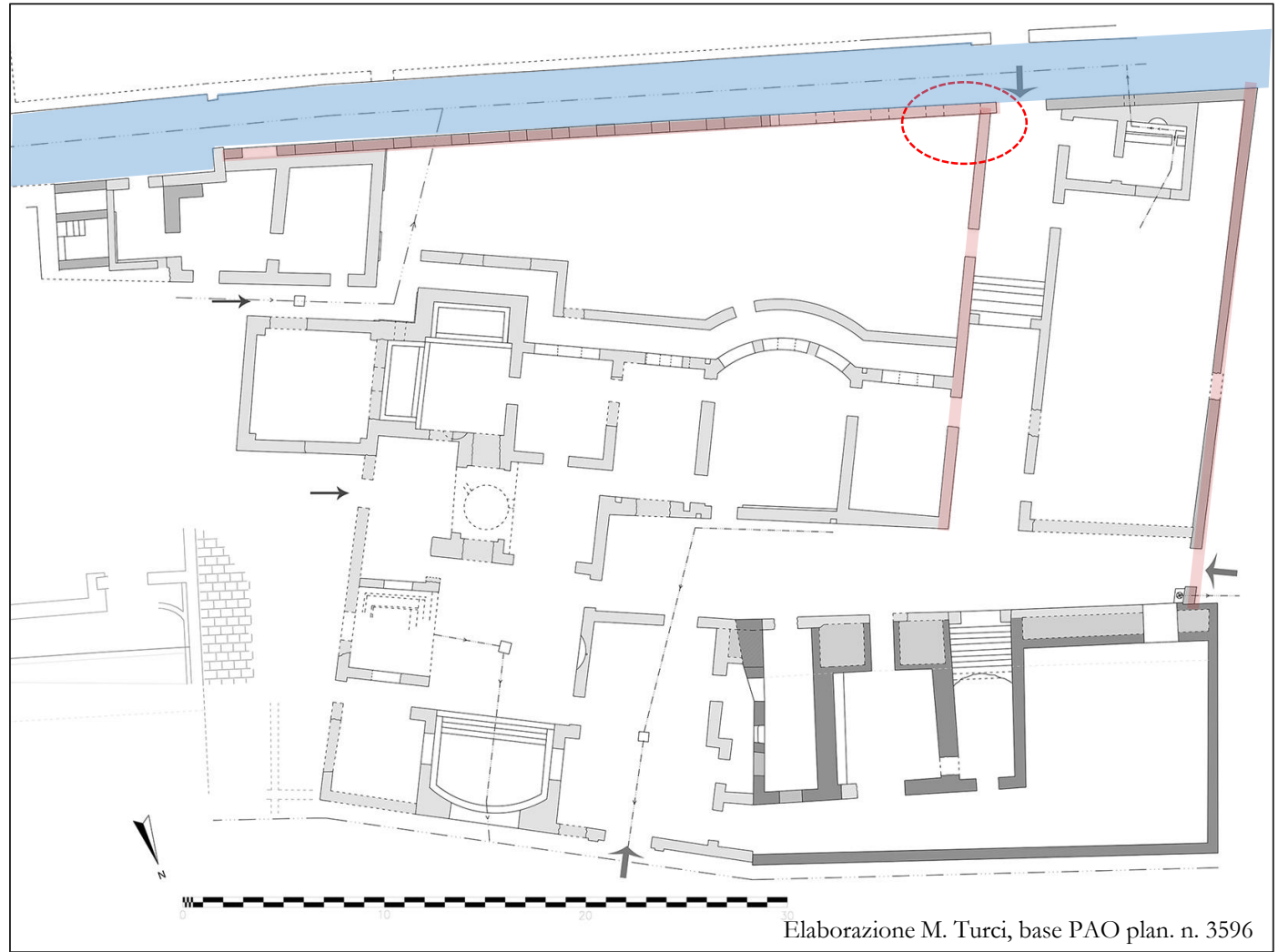

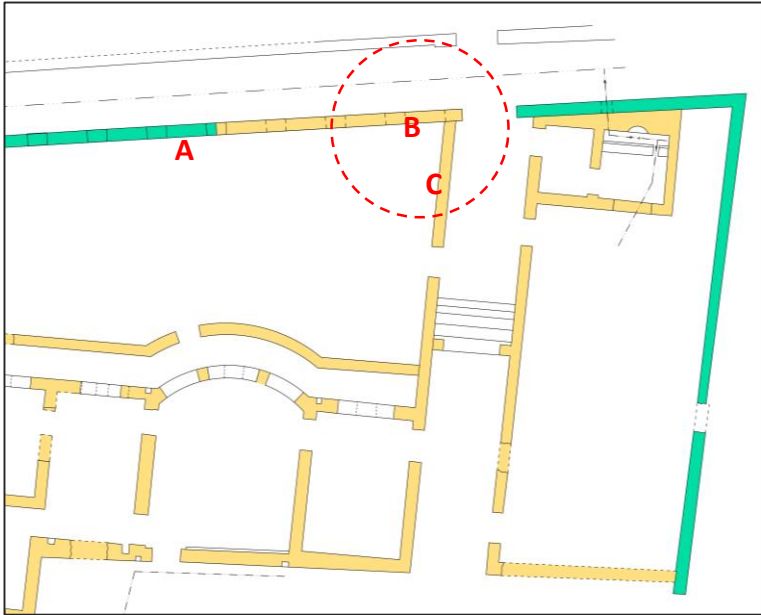

Elaborazione M. Turci, base PAO plan. n. 3596

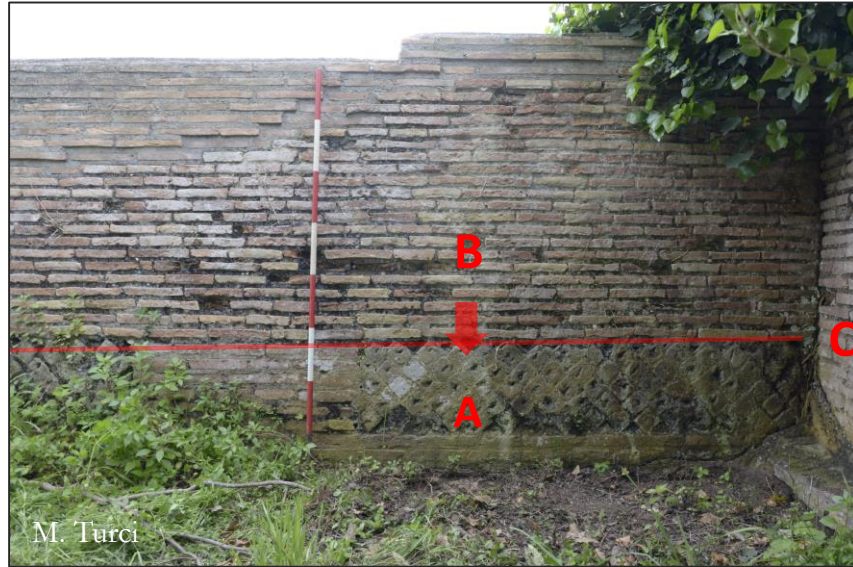

M. Turci

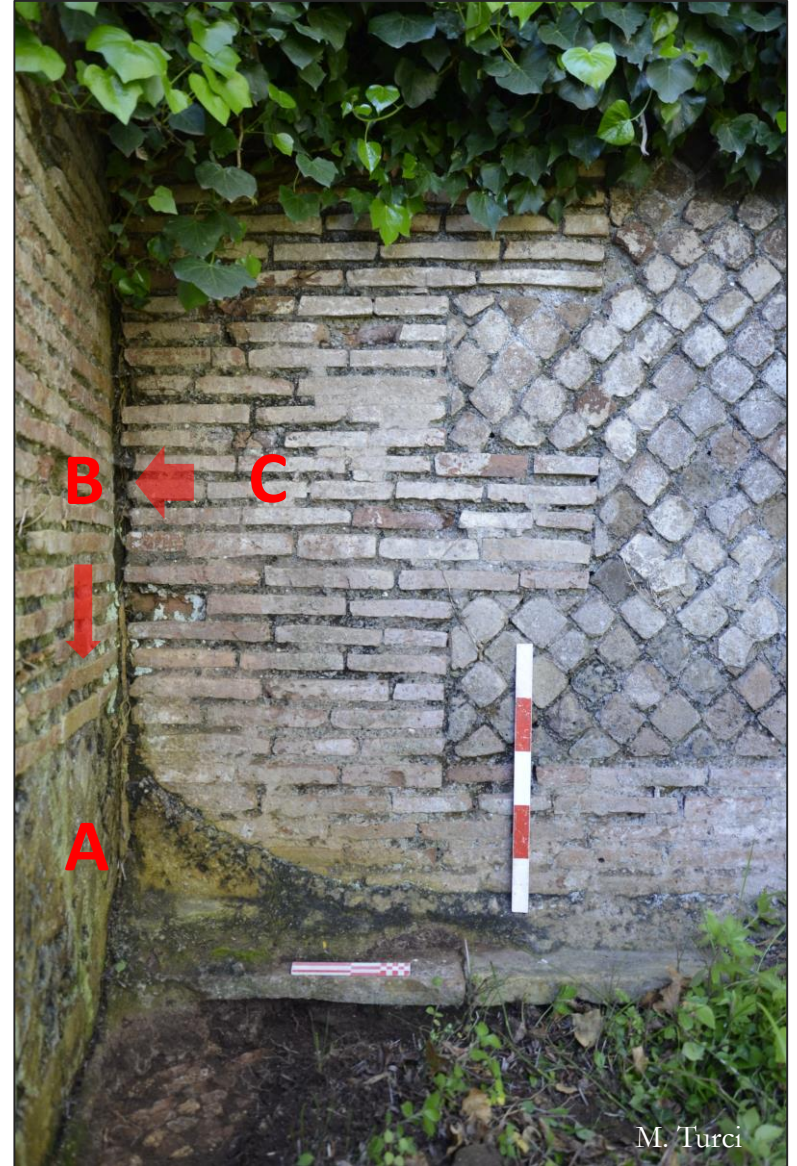

M. Turci



M. Turci

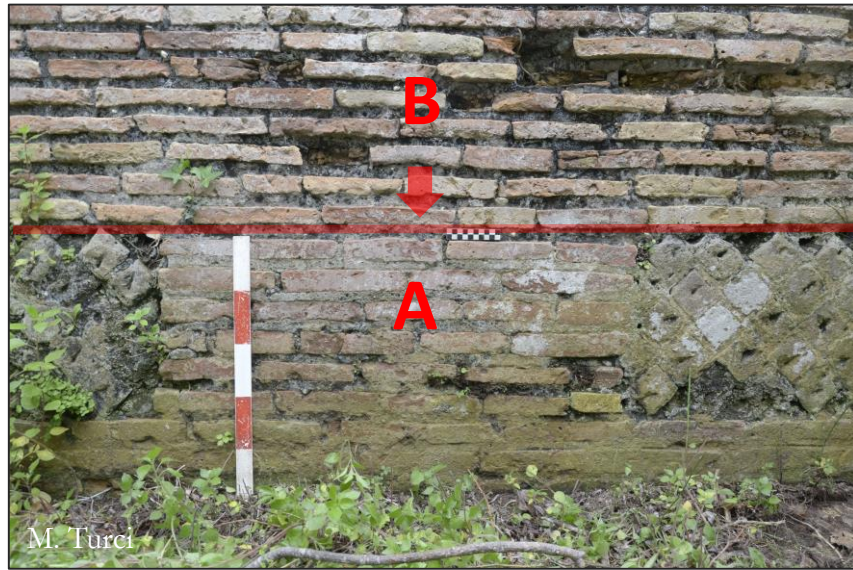

M. Turci

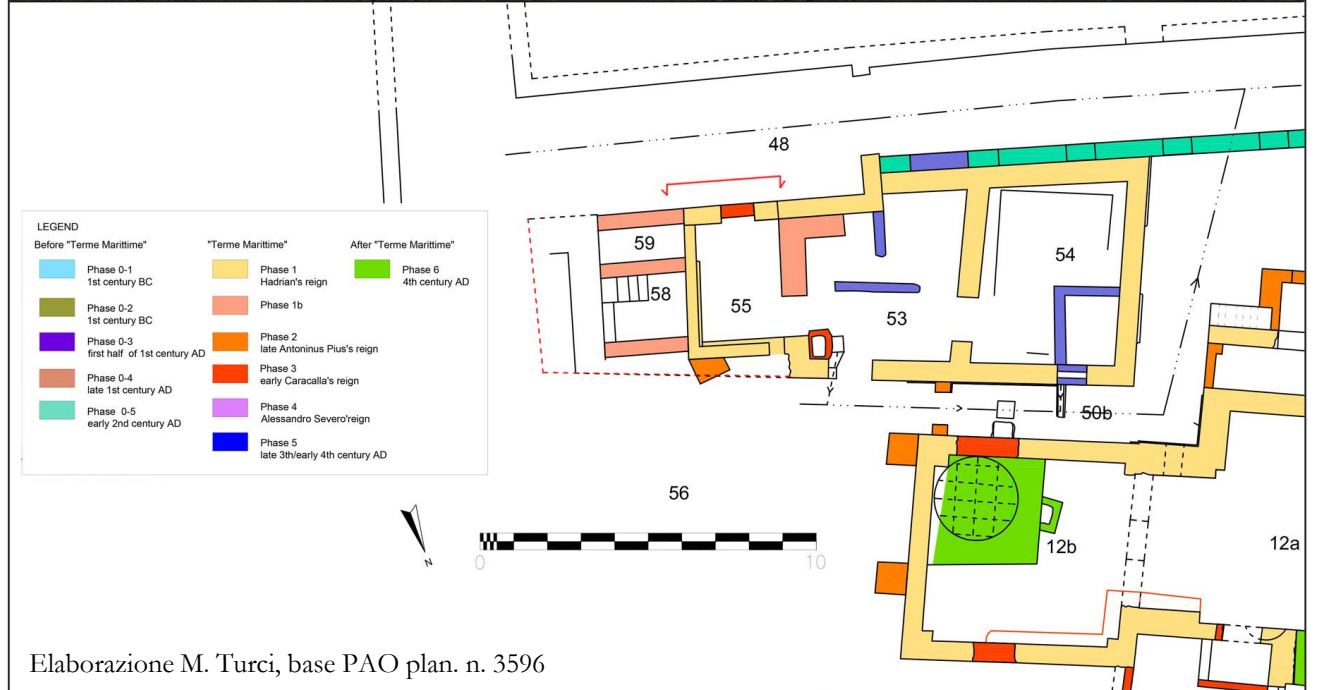
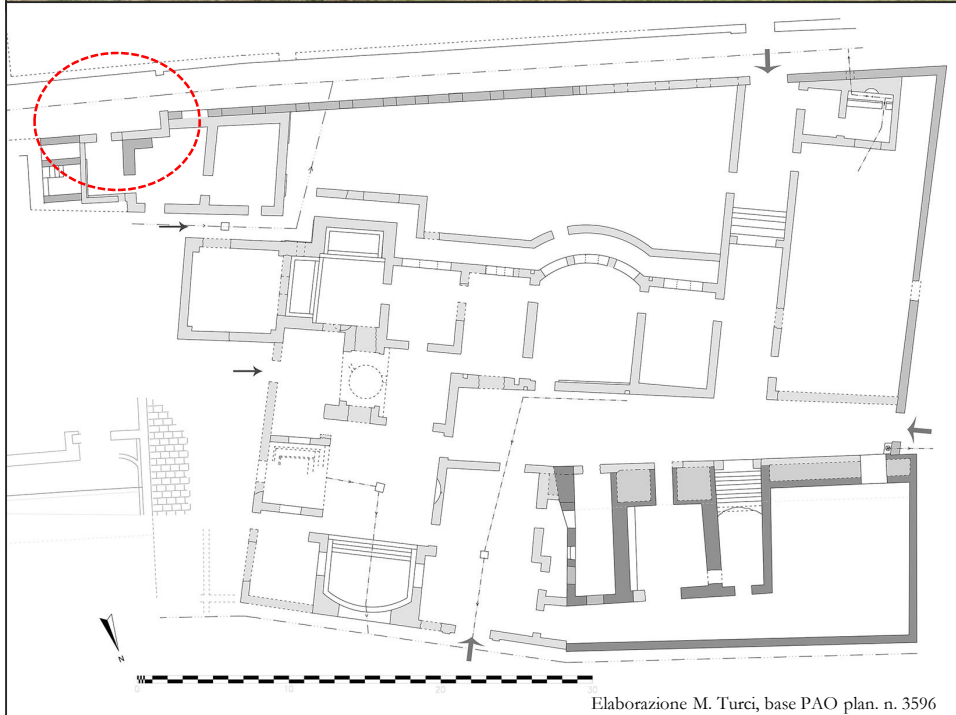
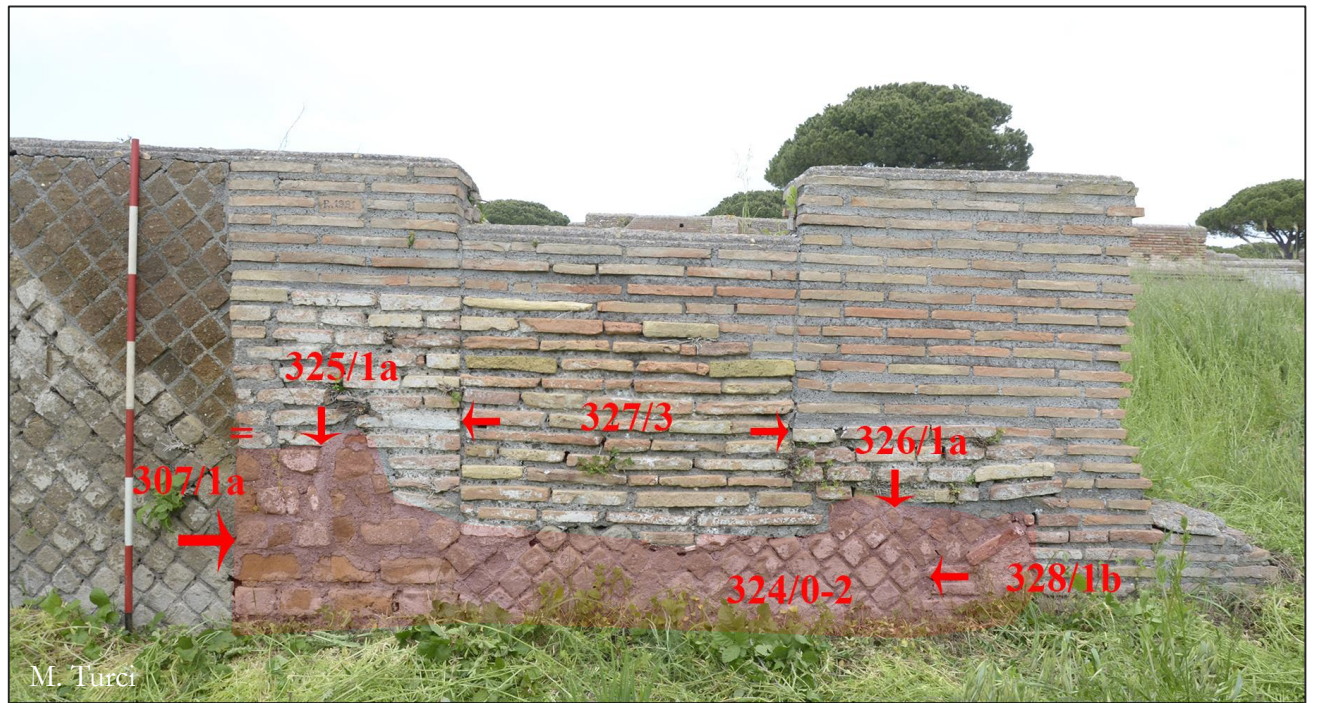

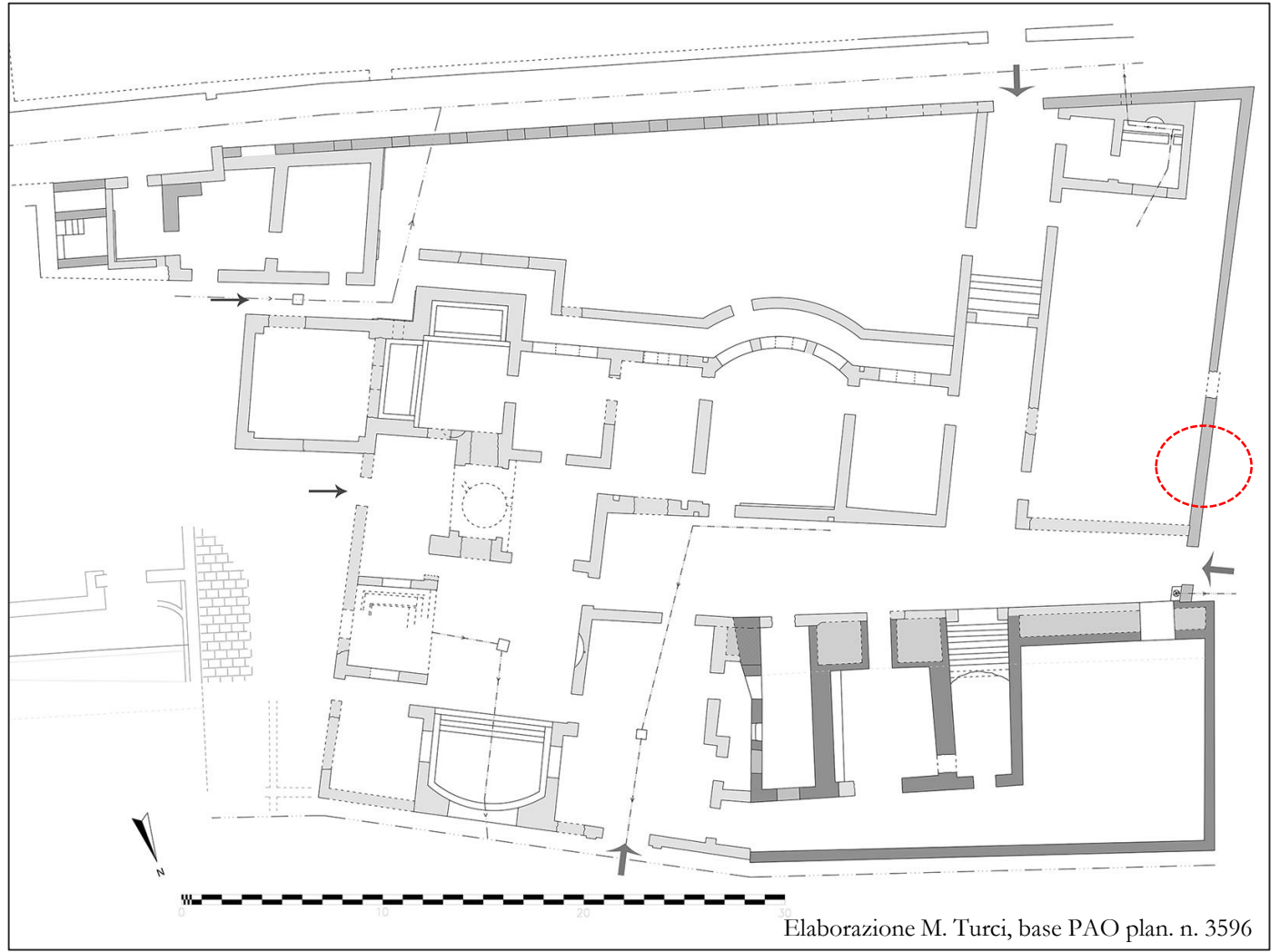

Elaborazione M. Turci, base PAO plan. n. 3596

Terme Marittime, fase 1 (età adrianea)

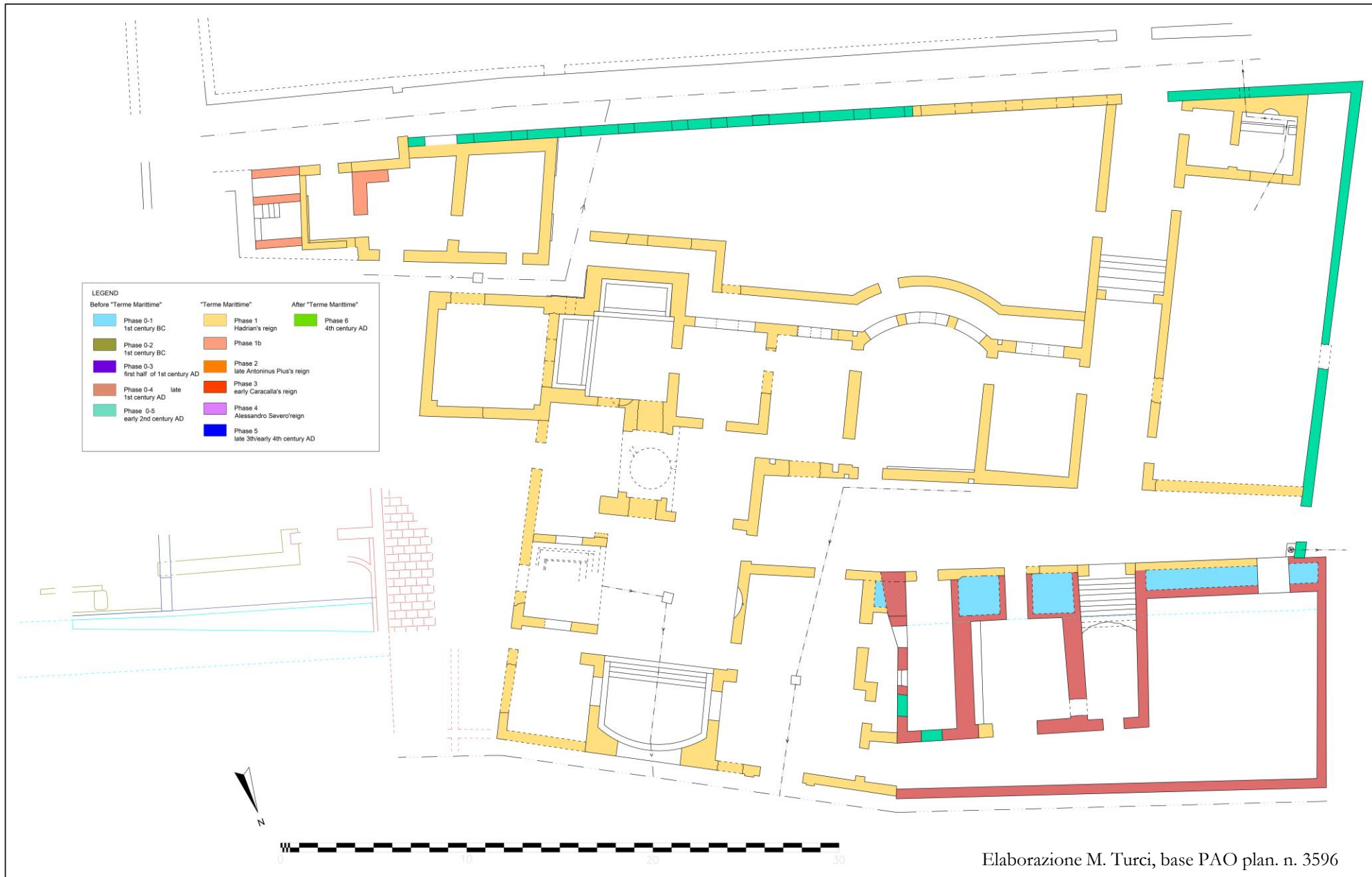

Elaborazione M. Turci, base PAO plan. n. 3596

Terme di Porta Marina (VIII, III, 2)

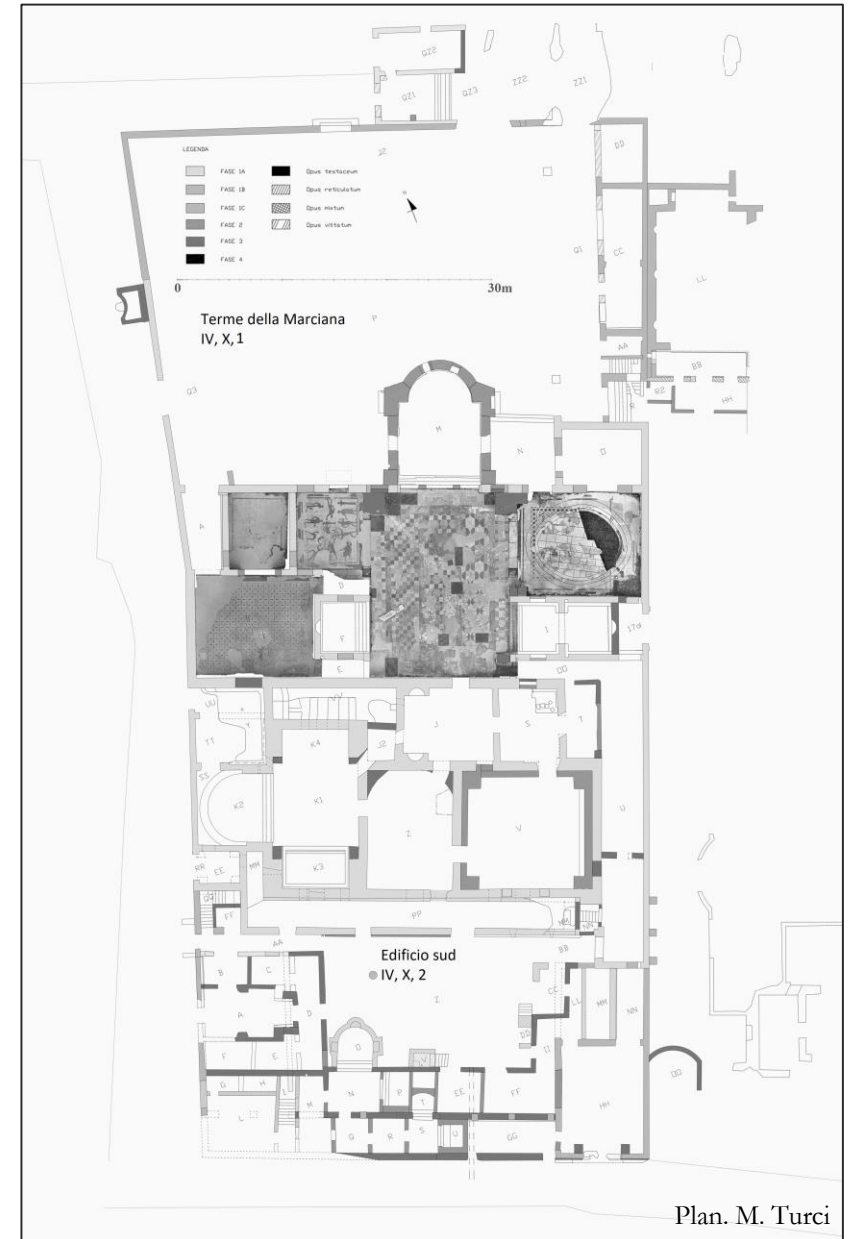
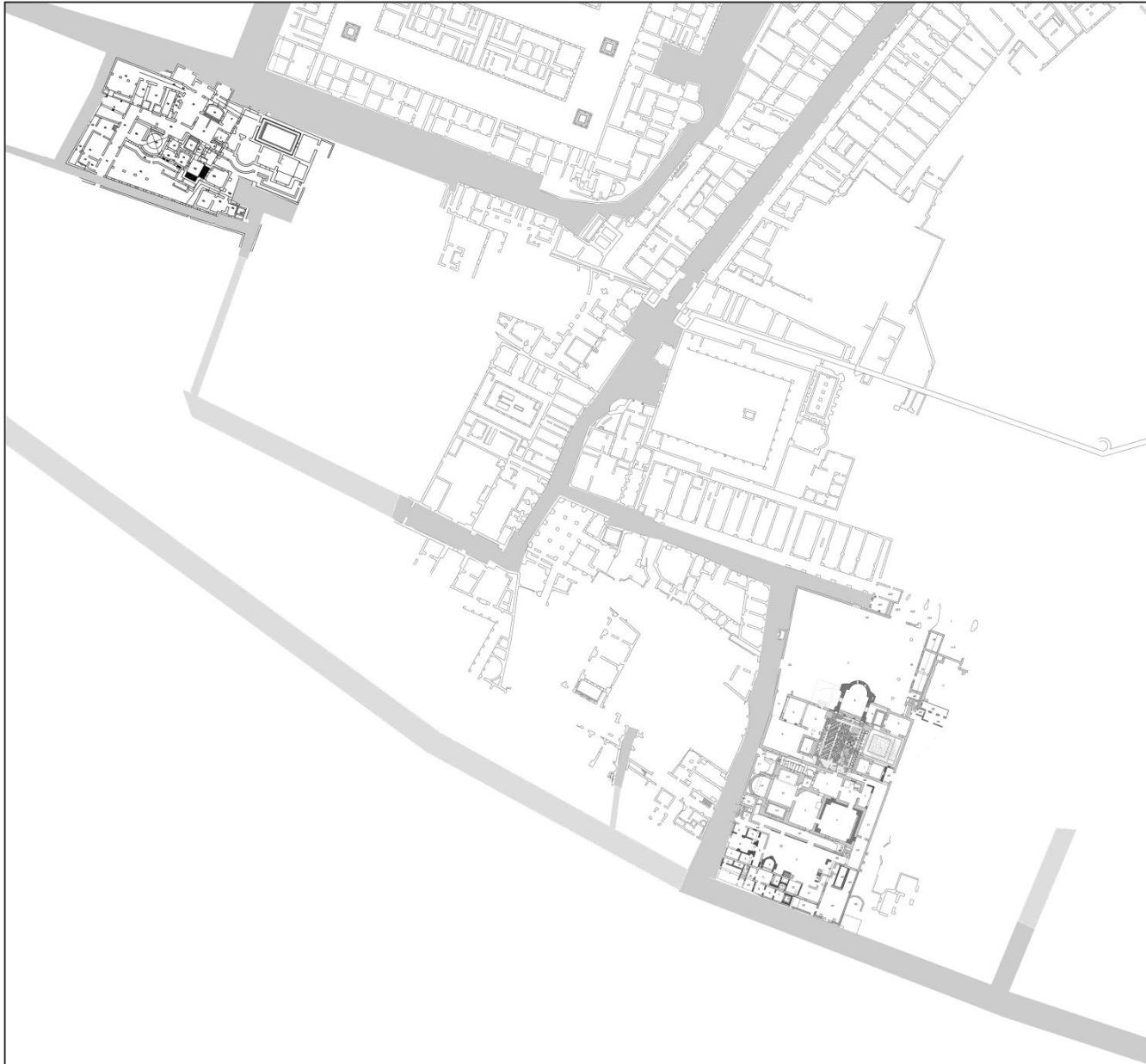

CIL XIV 98 (a139 d.C.)

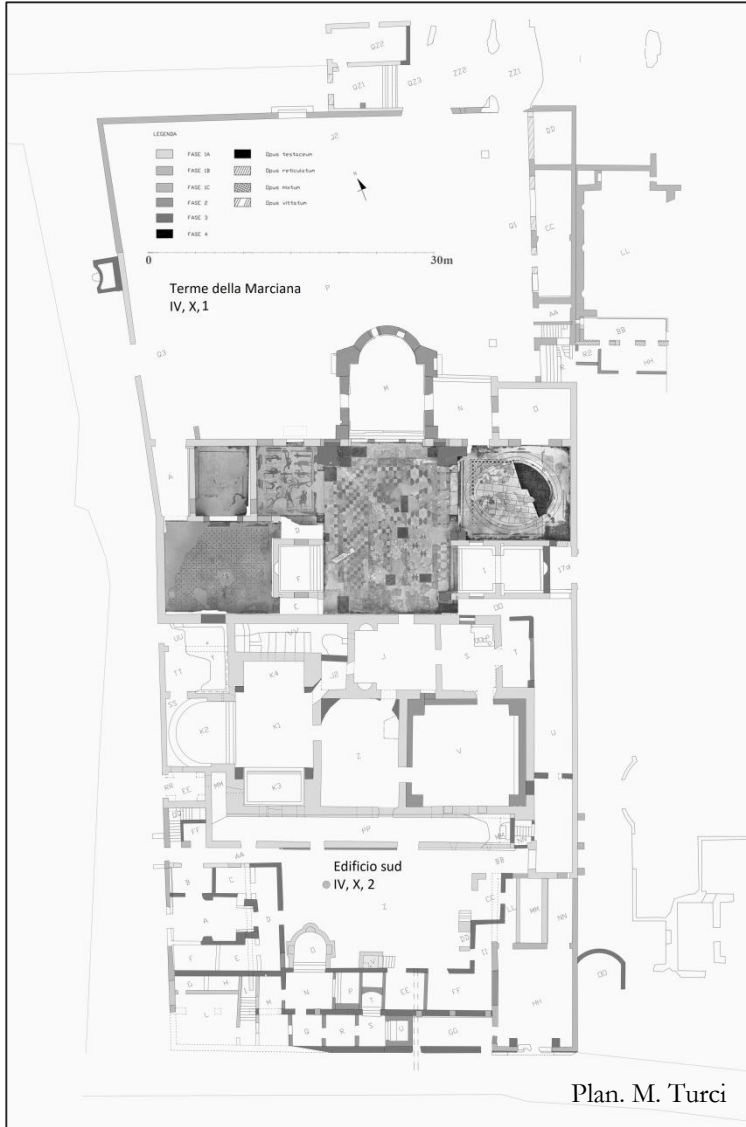

CIL XIV 137 (375-378 d.C.)

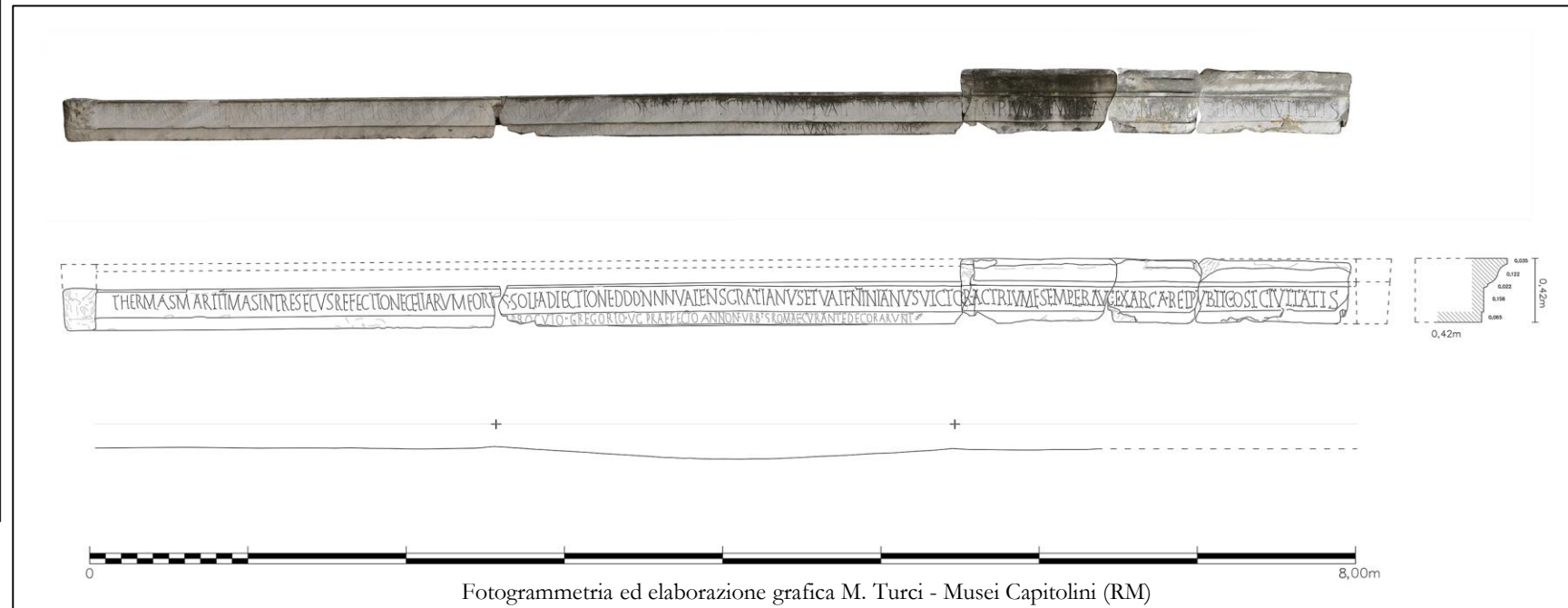

CIL XIV 137

Inv. n. 11850



Rilievo M. Turci

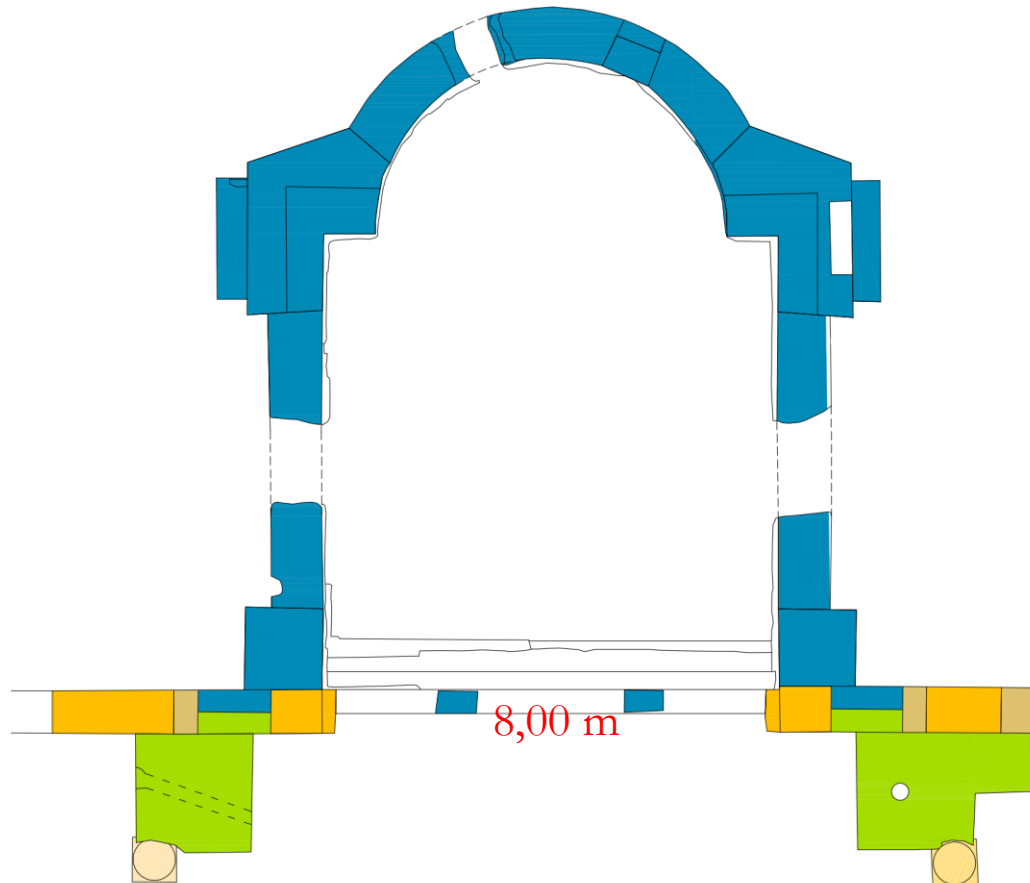

M. Turci

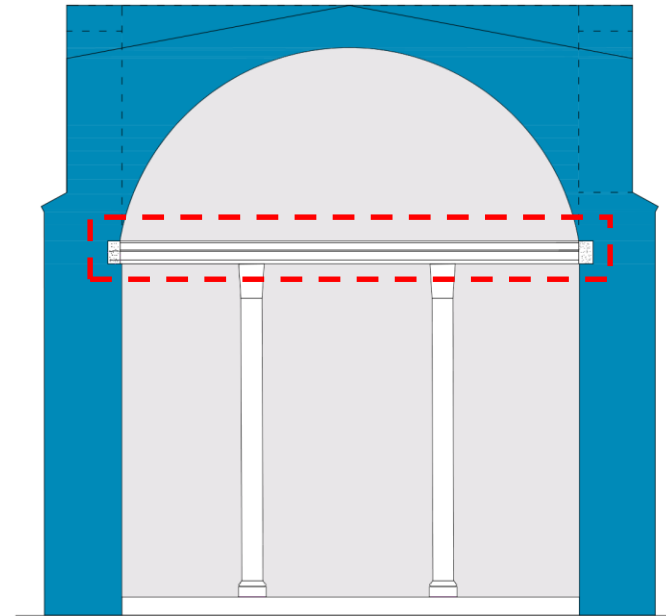

Restituzione alzato M. Turci

LEGENDA

- FASE 1A
- FASE 1B
- FASE 2
- FASE 3
- FASE 4
- FASE 5

Thermes de la Porte Marina (IV, x, 1)



Foto M. Turci © Governatorato dello S.C.C. - Direzione dei Musei Vaticani

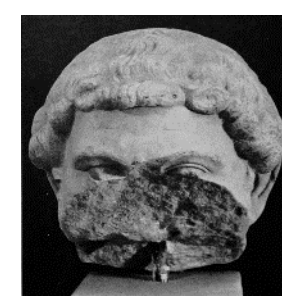

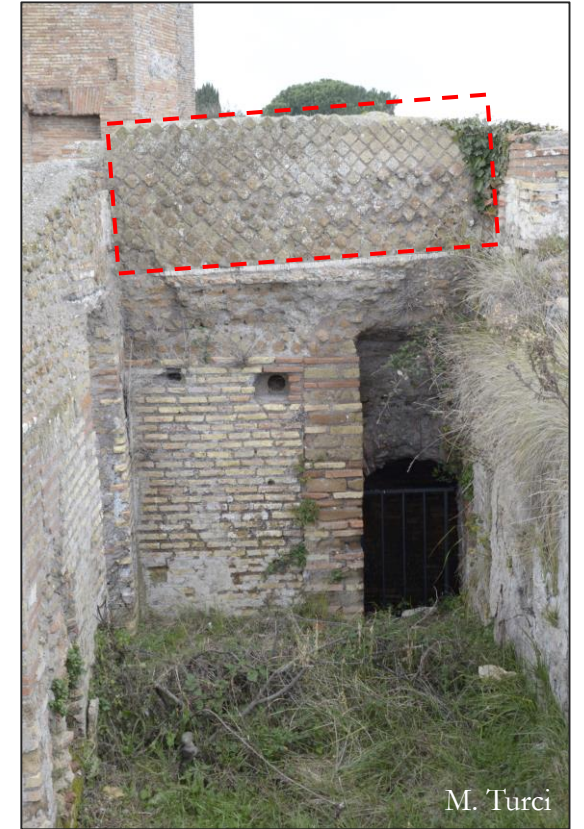
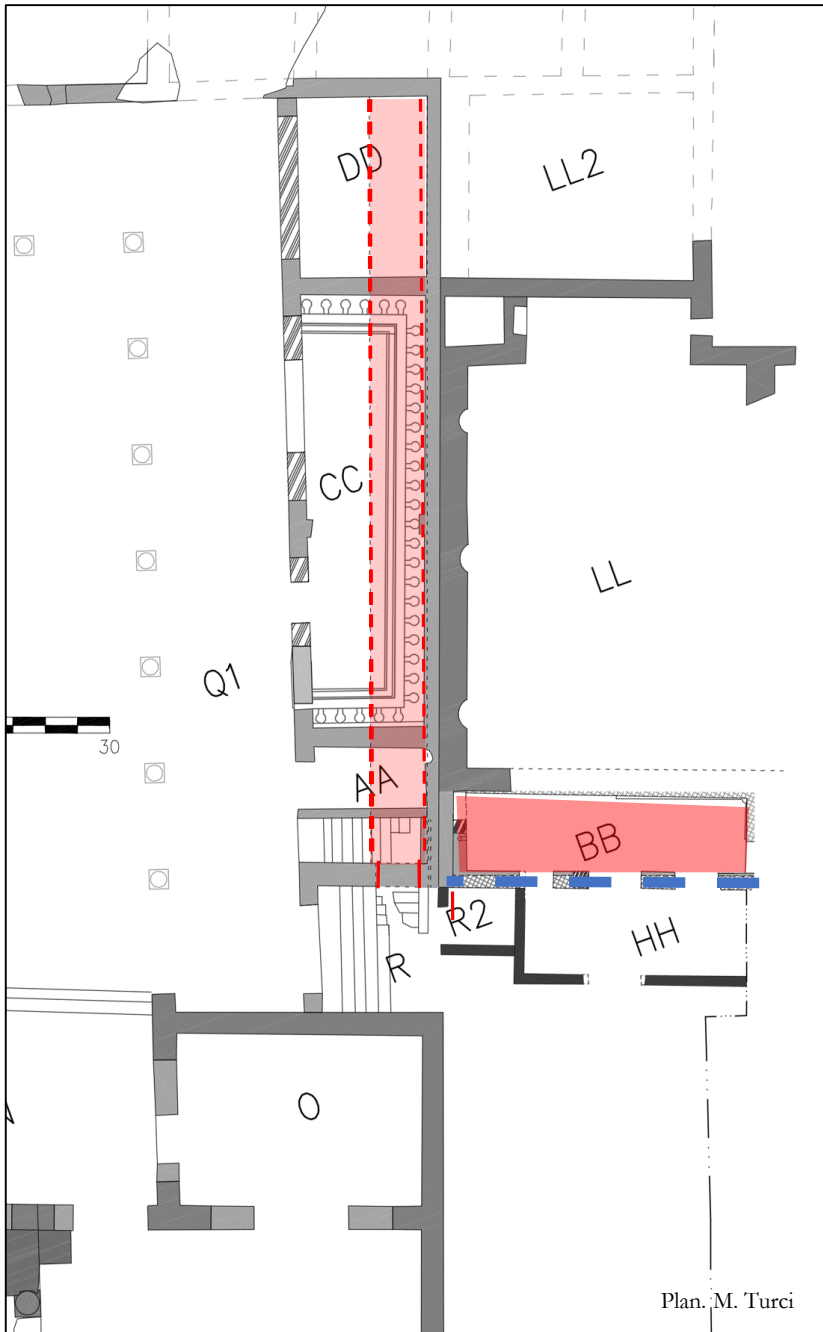

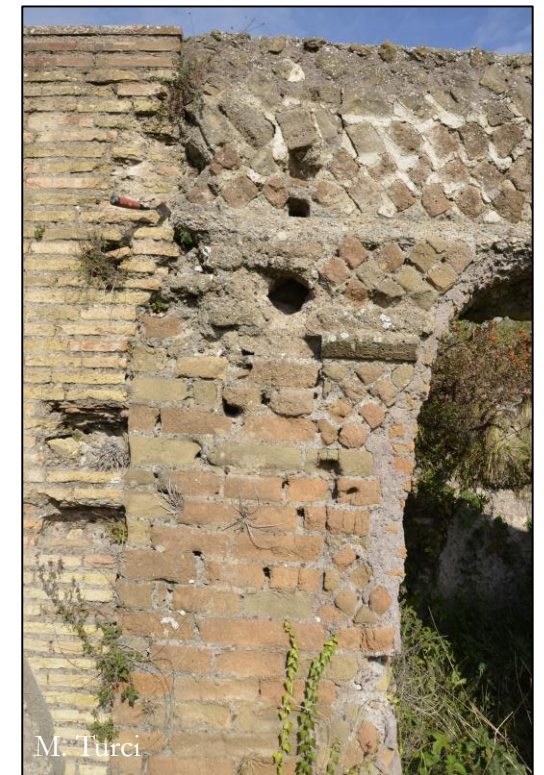
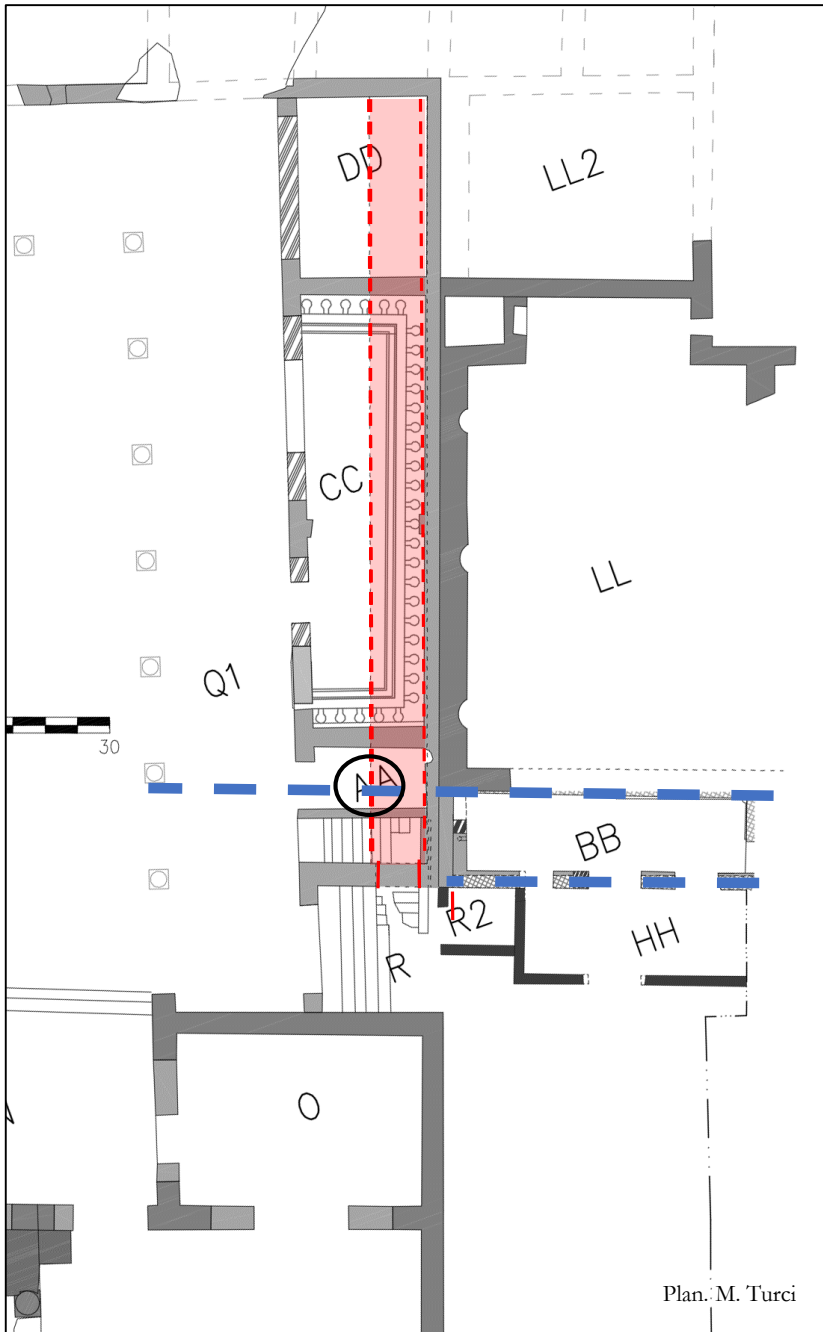

Plan. M. Turci

Q3





Elaborazione M. Turci, base PAO plan. n. 4264



PAO Neg. N. R2076-3



PAO Neg. N. R2076-5

Elaborazione M. Turci, base PAO plan. n. 4264

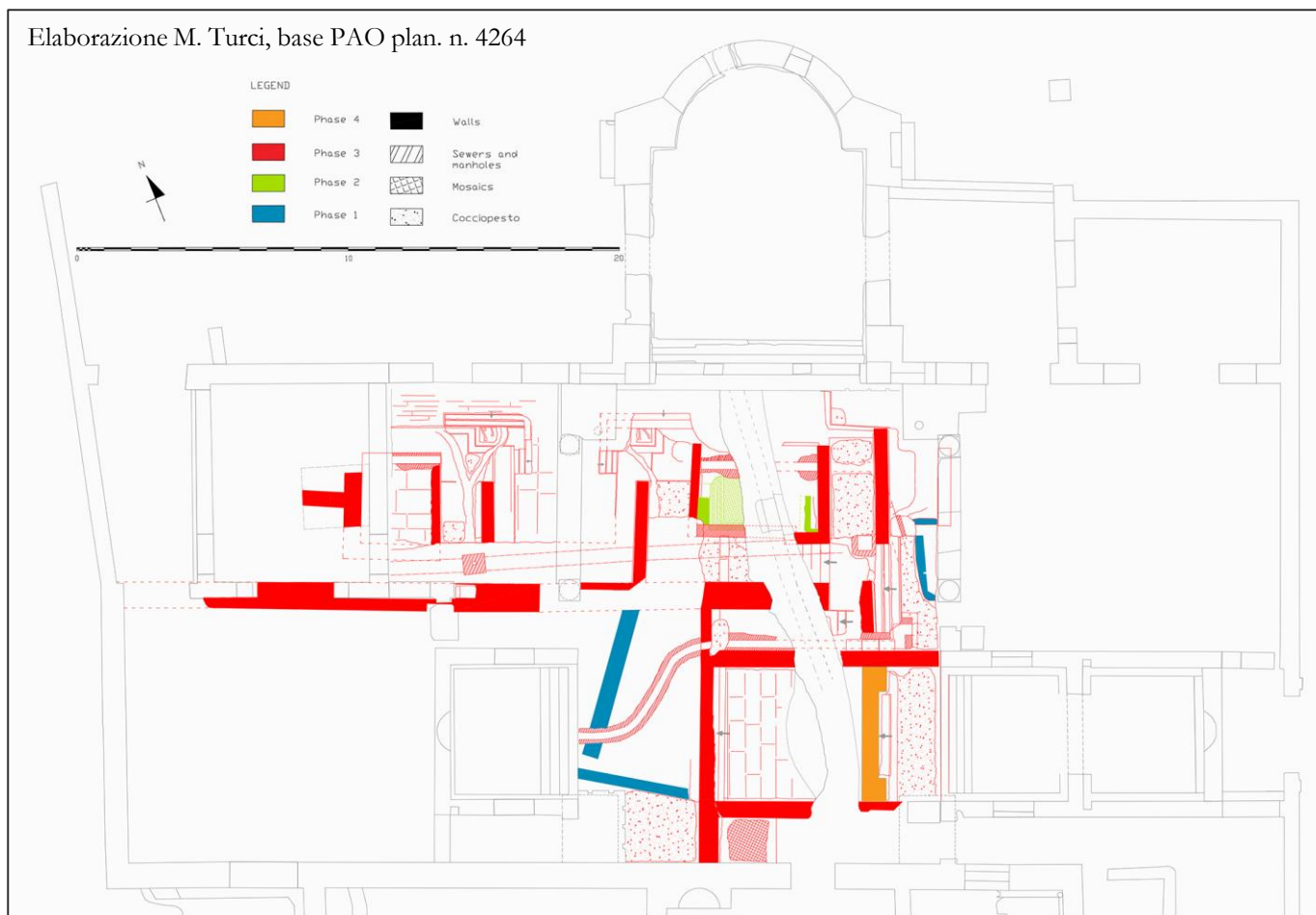

PAO Neg. N. 2069-4

PAO Neg. N. 2069-3

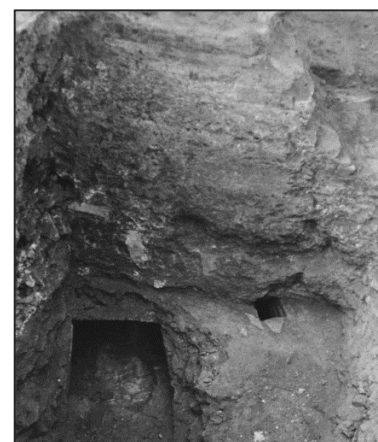

PAO Neg. N. 1999-12

PAO Neg. N. 1994-8

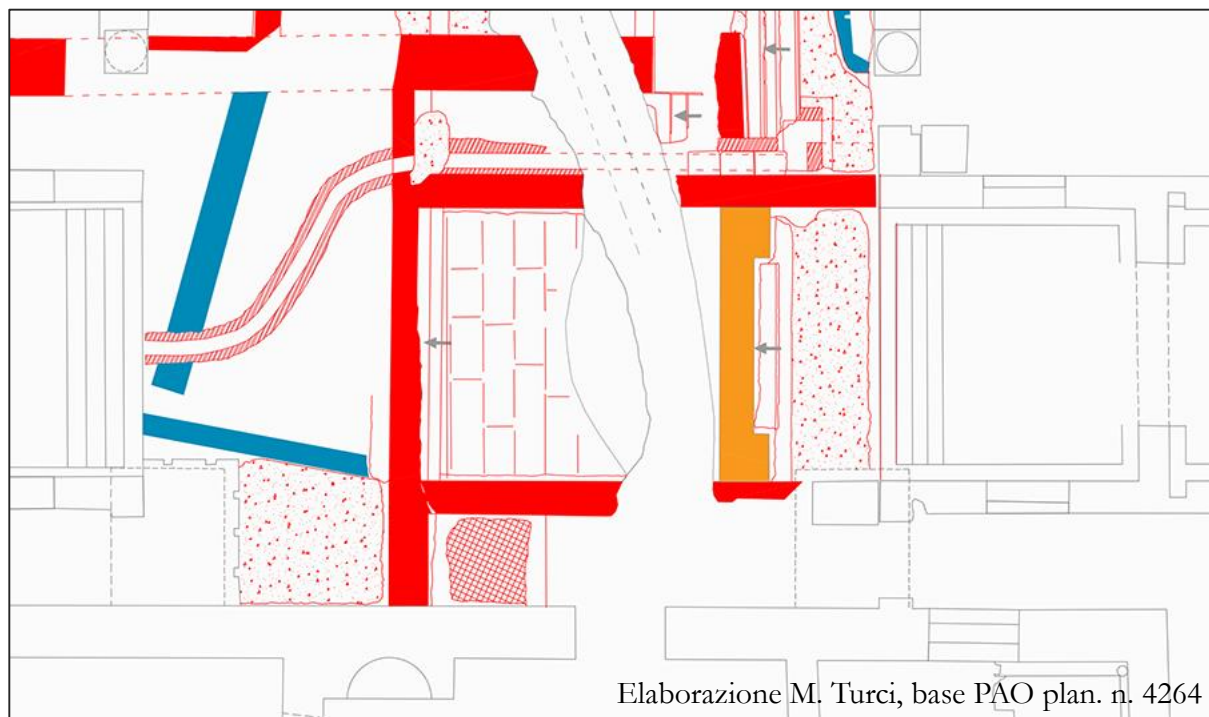

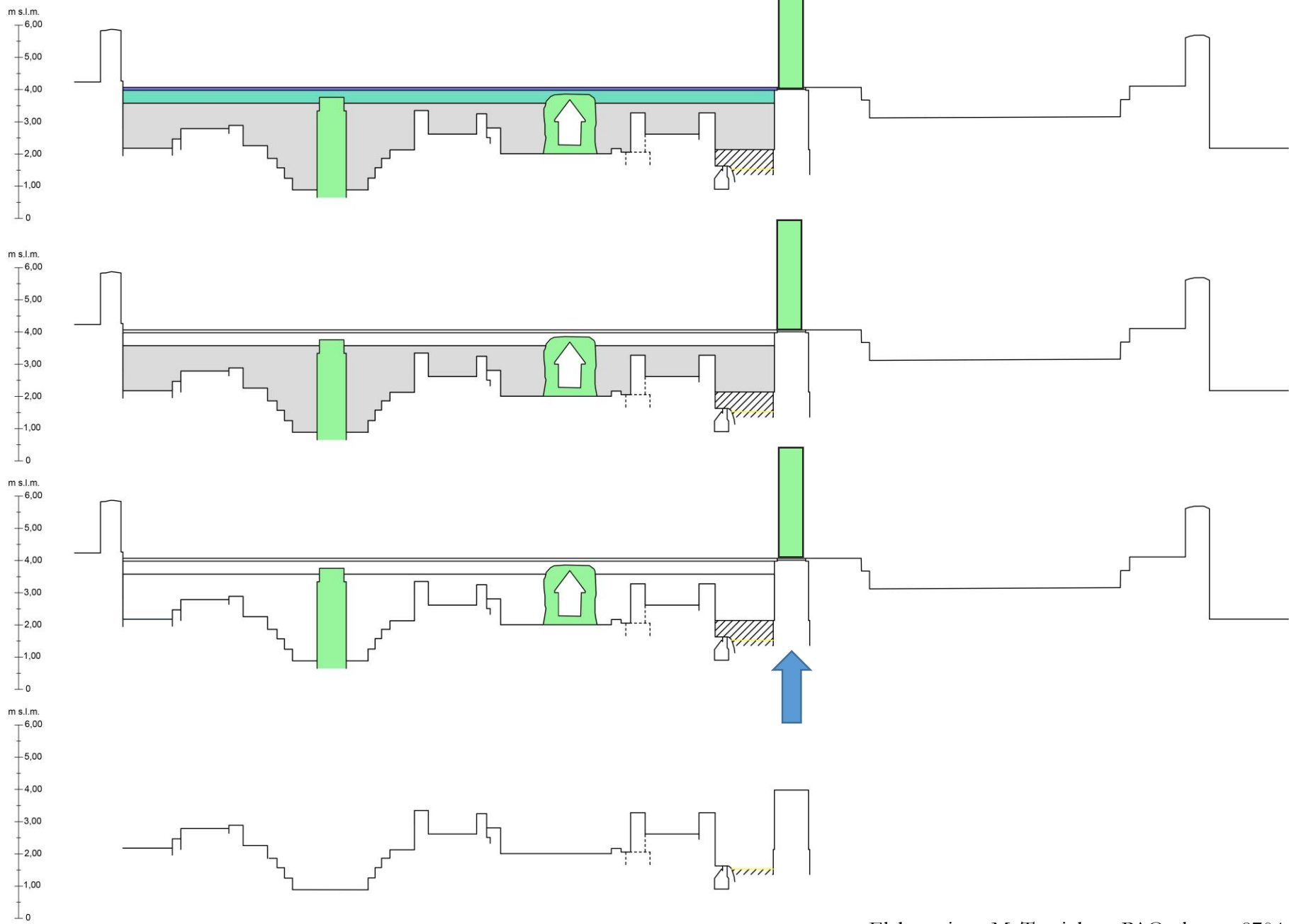

4

3

2

1

Età proto-augustea



Elaborazione M. Turci, base Atlante 1995

Prima metà I sec. d.C.



69-96 d.C.



Elaborazione M. Turci, base Atlante 1995

Terme pubbliche di Ostia in epoca antonina

- 1) Terme di Nettuno
- 2) Terme del Foro
- 3) Terme di Porta Marina

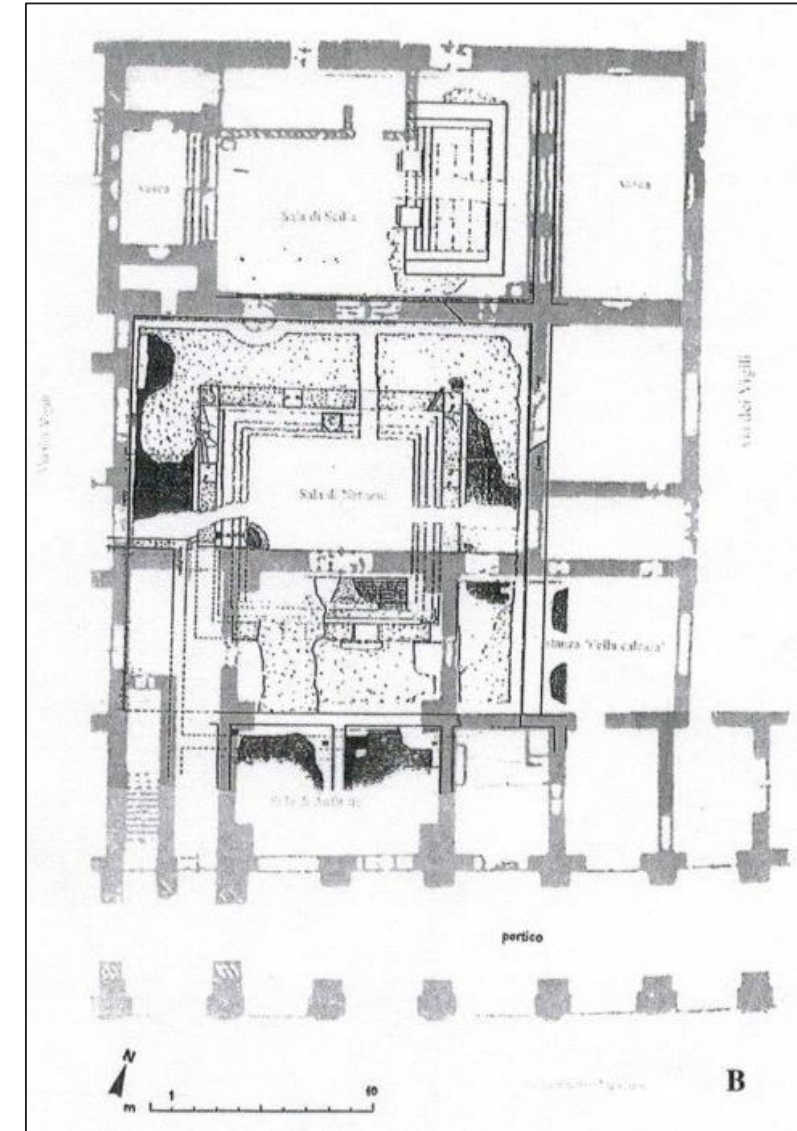
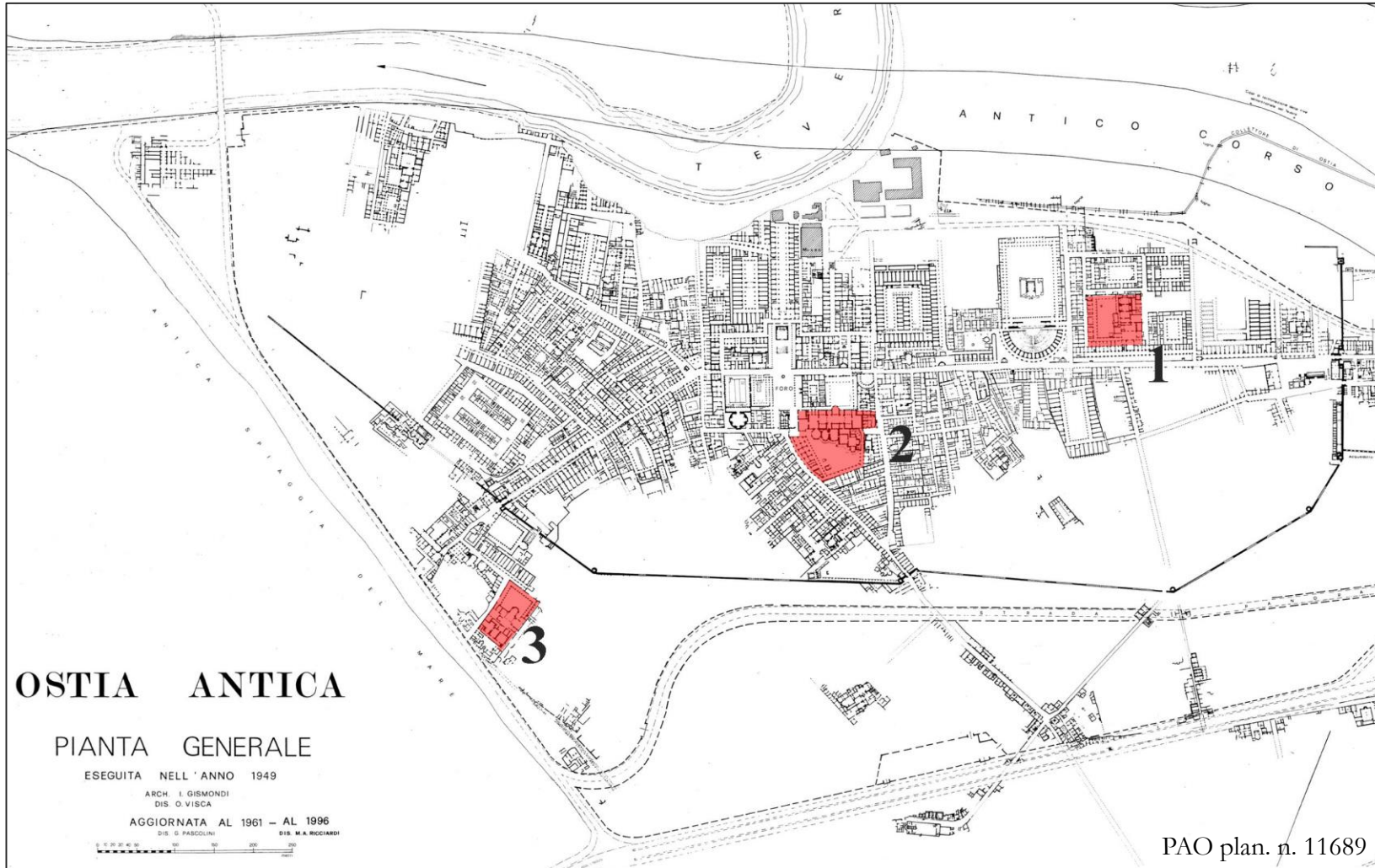

Terme di Nettuno, impianto di epoca domiziana
Da PENSABENE 2007

Fine I secolo d.C.

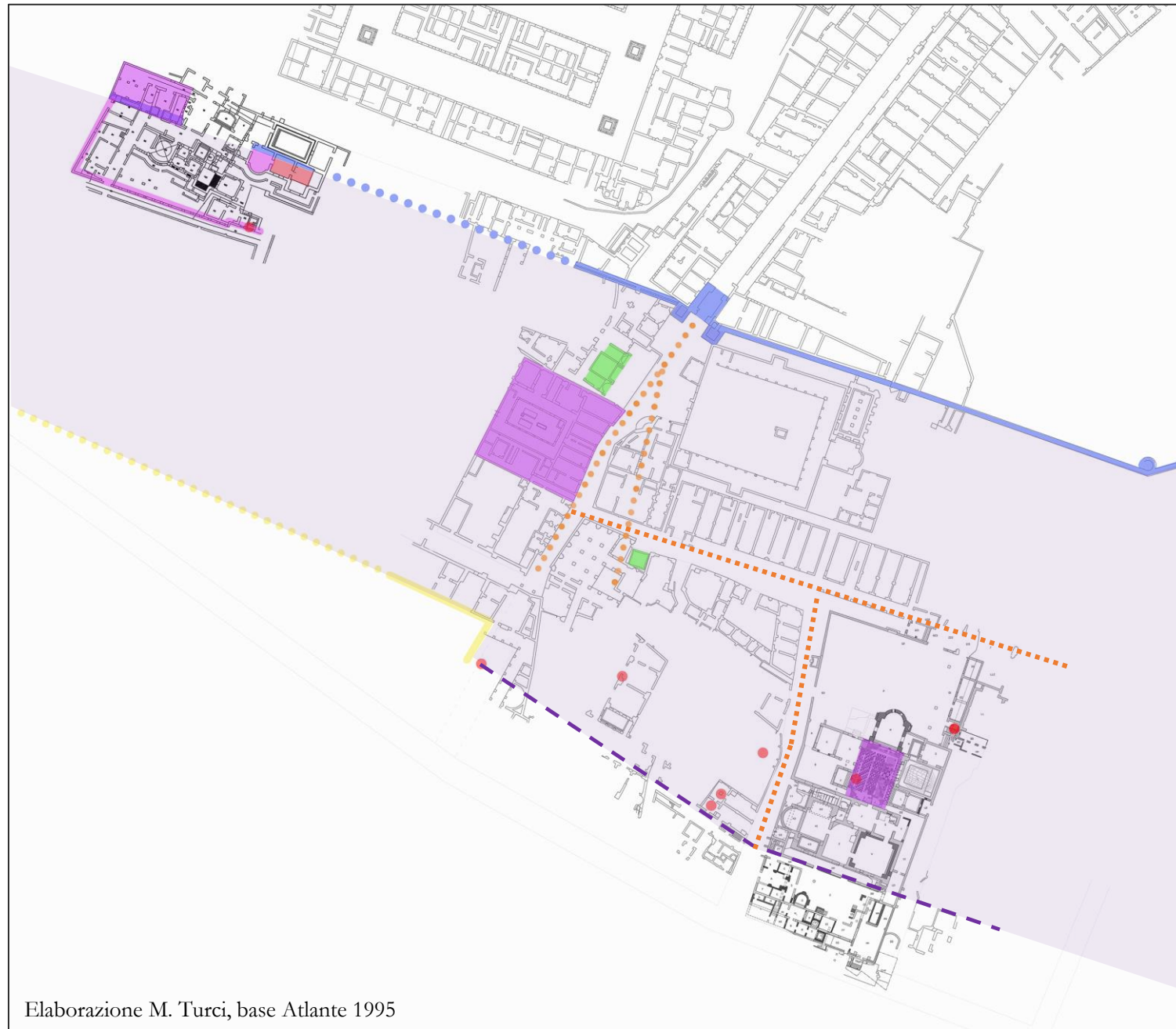

Elaborazione M. Turci, base Atlante 1995