



HAL
open science

Energy and material flow modelling of additive manufacturing processes

Mazyar Yosofi, Olivier Kerbrat, Pascal Mognol

► **To cite this version:**

Mazyar Yosofi, Olivier Kerbrat, Pascal Mognol. Energy and material flow modelling of additive manufacturing processes. *Virtual and Physical Prototyping*, 2018, 13 (2), pp.83 - 96. 10.1080/17452759.2017.1418900 . hal-01921334

HAL Id: hal-01921334

<https://hal.science/hal-01921334>

Submitted on 26 Nov 2018

HAL is a multi-disciplinary open access archive for the deposit and dissemination of scientific research documents, whether they are published or not. The documents may come from teaching and research institutions in France or abroad, or from public or private research centers.

L'archive ouverte pluridisciplinaire **HAL**, est destinée au dépôt et à la diffusion de documents scientifiques de niveau recherche, publiés ou non, émanant des établissements d'enseignement et de recherche français ou étrangers, des laboratoires publics ou privés.

Energy and material flow modelling of additive manufacturing processes

Mazyar Yosofi*, Olivier Kerbrat, Pascal Mognol

Institut de recherche en génie civil et mécanique, Ecole normale supérieure de Rennes, Université Bretagne-Loire, Avenue Robert Schuman 35170 Bruz, France

M. Yosofi is with the Institut de recherche en génie civil et mécanique, Ecole normale supérieure de Rennes, Université Bretagne-Loire, Avenue Robert Schuman 35170 Bruz, France (phone: +330290091182; e-mail: mazyar.yosofi@ens-rennes.fr).

O. Kerbrat is with the the Institut de recherche en génie civil et mécanique, Ecole normale supérieure de Rennes, Université Bretagne-Loire, Avenue Robert Schuman 35170 Bruz, France (phone: +330299055275; e-mail: olivier.kerbrat@ens-rennes.fr).

P. Mognol is with the the Institut de recherche en génie civil et mécanique, Ecole normale supérieure de Rennes, Université Bretagne-Loire, Avenue Robert Schuman 35170 Bruz, France (+330299059301; e-mail: pascal.mognol@ens-rennes.fr).

Energy and material flow modelling of additive manufacturing processes

Additive manufacturing processes allow fabrication of 3 dimensional complex parts. Due to the exact amount of material used during the manufacturing step, these new manufacturing processes offer great opportunities for sustainable manufacturing. However, existing studies on these processes focus mainly on energy consumption and information about resources consumptions and waste flows are still lacking. This study aims to quantify with accuracy inventory data of additive manufacturing processes during the manufacturing step of the life-cycle of a products. In order to accurately assess the environmental impact of a product, a generic method for acquisitions and characterizations of inventory data for parts made by additive manufacturing processes is proposed. This methodology not only focuses on the electrical energy consumption but also on material consumption. This paper also describes the development of a parametric process model, which provide to an operator, an accurate estimations of the environmental performances of fused deposition modeling process.

Keywords: Additive manufacturing; life-cycle inventory; fused deposition modeling; energy and resource efficiency; environmental sustainability

1. Introduction

The life-cycle assessment of products is increasingly common today in the development activities and industrialization of products (Wohlers 2015). This is indeed a major strategic issue for manufacturing industries. In this way, the knowledge of the level of environmental performance of manufacturing processes is a necessary step before considering action for improvement.

This knowledge is essentially based on the inventory data of manufacturing processes contained on databases where the quantification of consumption and emissions to air, water and soil are informed. These data are process-dependent and are insufficiently informed today for innovative processes (such as additive manufacturing technologies). Indeed, these “3D-printing” processes could be seen as mature from a technical point of view (Lee et al. 2017; Lee et al. 2016) but the environmental analysis of the processes are still lacking.

In this paper, the research focus on the acquisition of the inventory data of Additive Manufacturing (AM) processes. Depending on the AM process studied, there are sometimes no details about other resources consumptions such as material used during the manufacturing step, process emissions or waste flows. Indeed, existing studies on AM processes are mainly focused on energy consumption. Nowadays, Life-Cycle Analyses (LCA) experts realize LCA of parts made by additive manufacturing processes even if the flows during the manufacturing step are not well informed. However, in order to be the most realistic as possible, an LCA should take into account all the input and output flows during the life-cycle of products (Figure 1).

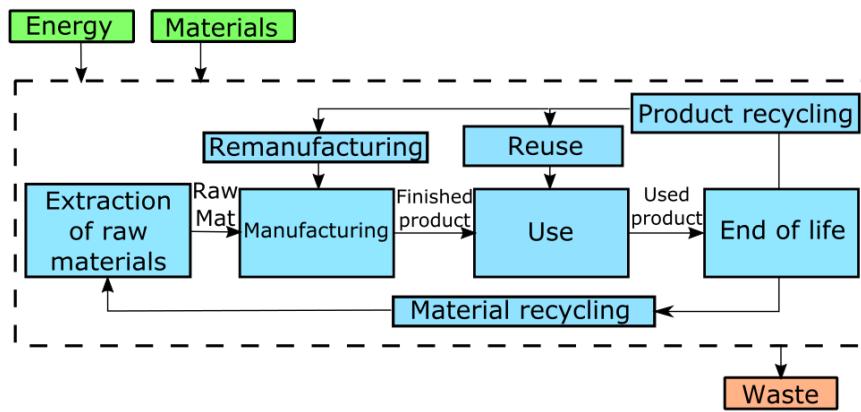

Figure 1. Life-cycle of a product

Because of those reasons, it seems important to evaluate with accuracy the inventory data during the manufacturing step considering all the input and output flows. In this paper, the considered flows during the manufacturing step are the electrical energy consumption, primary material and support material consumption (waste material). Process emissions during the manufacturing step, environmental impact of all the provisions and facilities use during the recycling of waste materials during the manufacturing step and raw material transformation are not taken into account. Thus, this paper focus on the development of a generic method to assess the life cycle inventory of additive manufacturing processes during the fabrication step in order to take into account all the inputs and outputs flows.

2. State of the art

Nowadays, AM techniques have been applied in various domains such as biomedical, aerospace and automotive industry. The capacity of AM to build parts directly from a Computer Aided Design (CAD) model with only one manufacturing step makes it an excellent alternative compared to Conventional Manufacturing (CM) processes such as machining, thermoforming and injection molding (Bourell et al. 2009). Indeed, one of the many advantages of AM process is the possibility to manufacture products with complex geometry that would be difficult or impossible with CM processes. Some AM processes

have also the capability to repair and remanufacture tooling in order to eliminating the supply chain operation of materials. Those new manufacturing processes are generally more environmentally friendly because they only use the exact amount of material to build product. That makes AM technologies good for reducing the life-cycle material mass and energy consumed. Other environmental advantages can be found in the reduction of extracting raw materials and its transportation.

The first study on the environmental analysis of AM processes were performed by Luo et al. (1999). Their works focused on the energy consumption of three AM processes: vat photopolymerization, powder bed fusion and material extrusion. The authors reported the processes energy consumption in terms of Specific Energy Consumption (SEC). The concept of SEC was used to facilitate comparisons between manufacturing processes and its units are kWh/kg. These studies took into account the energy consumption of the manufacturing process by considering only the machine. Indeed, all the parameters that can modify the SEC like the shape or the position of the part were not considering. Electrical energy comparison between machines of the same process has been done for one part.

Baumers et al. (2011) explored the SEC of material extrusion and four powder bed fusion processes. They studied the effect of the part geometry and the packing density of the space machine on the electrical energy consumption of these AM processes. They determined that the SEC decreased when multiple parts are manufactured in the same time. In another study, Baumers et al. (2010) compared the energy consumption of selective laser melting (SLM) and electron beam melting (EBM) processes for two different materials, respectively stainless steel and titanium, with a focus on manufacturing stage. In their studies, EBM process had lower energy consumption due to differences in material and layer thickness.

Mognol et al. (2006) analyzed the energy consumption of three AM processes: material jetting (Thermojet), material extrusion (FDM 3000) and a powder bed fusion (EOS M250) process. In this case, the authors studied the influence of the part orientation on the build platform. Thus, it was possible to save 43 % of electrical energy for the EOS, 45 % for the Thermojet and 61 % for the FDM 3000 with a good set of parameters. They also determined that the heating system of each process is the largest energy consumer. The work realized by Baumers et al. and Mognol. et al bring to light the importance of the consideration of the manufactured part in the electrical energy consumption analysis of AM processes.

Junk and Côté (2012) compared the energy consumption of material extrusion and material jetting. Compared to some authors, they did not study the SEC only during the stage of fabrication but they considered the entire energy consumption cycle. Indeed, they included the preparation and the post-processing steps to calculate the SEC. They also studied the influence of the position of one part on the build platform and on the energy variation (Junk and Côté 2013). They found that the energy consumption of a manufactured part is lower when the part is built near the machine zero point.

Sreenivasan and Bourell (2009) studied the energy consumption of a powder bed fusion process during the fabrication stage. Then they translate the energy measured into environmental impact. In a second study, Sreenivasan et al. (2010) worked on a way to reduce the energy consumption in SLS of porous non-polymeric materials. The method consisted of mixing a binder with material, to create an SLS part and then to remove the connected porosity. Finally the part was densified by chemical deposition within the pore network.

Balogun et al. (2014) compared the energy consumption of three material extrusion machines with different hardware. They noted that the energy required for the manufacturing step changes for the three machines.

The authors mentioned above studied exclusively the energy consumption of AM processes. There are also available studies of multiple processes comparison.

Yoon et al. (2014) compared the SEC of a same part build with AM (material extrusion) and CM (machining and injection molding) processes. They show that for one part, the SEC of AM process is lower than CM processes for fifteen parts, the SEC of CM processes are a hundred times lower than AM processes.

Morrow et al. (2007) compared an AM process (Direct Metal Deposition, DMD) with machining. They studied for both processes the electrical energy consumption for a mold insert and a mirror. Their work revealed that the energy consumption between DMD and machining is influenced by the solid-to-cavity volume ratio. At high ratios, the Computer Numerical Control (CNC) machining pathway minimizes energy consumption and emission while at low ratios DMD pathway minimizes energy consumption and emission.

Telenko and Seepersad (2012) studied the comparison of energy consumption between SLS and injection molding of nylon parts. They concluded that manufacturers can save energy using SLS process for parts with small production volume. For the part they studied, the volume production at which SLS and injection molding consumed equivalent amounts of energy ranged from approximately 150 to 300 parts. Other studies can be found in (Burkhart and Aurich 2015; Huang et al. 2015; Wilson et al. 2014; Wittbrodt et al. 2013).

Based on this literature review, Table 1 does a comparative review of the different SEC. In this table, the large difference between the values, even for similar machines with the same technology, cannot lead to a conclusion on what technology is best from an

environmental point of view. In this table, five technologies have been studied and shows the electrical energy consumption due to the manufacturing phase of each process. It is difficult to know which machine has the lower environmental impact, considering that these machines may have different set of parameters during the manufacturing of parts, the material used is different and most importantly, the parts are not the same between studies.

A lot of articles focus mainly on the energy consumption during the manufacturing step. But the SEC is not enough to predict the environmental impact caused by processes. Some data such as resource consumption, emissions, waste flows or recycling are still lacking. For some years, the authors have tended to a more global vision of environmental impact. Meteyer et al. (2014) created a binder jetting process model to predict the electrical and material consumption during a manufacturing process.

Le Bourhis et al. (2014) made a predictive model for the environmental assessment of a laser cladding process. Besides the electric consumption, they took into account the atomization of the raw material, fluid and material consumption and the recycling of lost powder.

Kellens et al. (2012a) used the UPLCI methodology to study the environmental impact of two powder bed fusion processes. This methodology allows an accurate environmental assessment for manufacturing processes (Kellens et al. 2012b).

Characterizations of the environmental performances of AM processes have many times focused on electric energy consumption. However, it is important to take into account all the flows through the process in order to assess the environmental performance of a machine precisely. It is more true for material deposit processes (Fused deposition modeling, Material jetting) and material projection processes (directed energy deposition) where most of the studies are focused on energy consumption. That is why this paper

focuses on the development of a generic method to assess the life cycle inventory of additive manufacturing processes during the fabrication step in order to take into account all the inputs and outputs flows.

Process categories	AM technology	Machine	Material	Specific energy consumption (kWh/kg)	Reference	
Material extrusion	FDM	FDM 1650	ABS	346	Luo et al.1999	
		FDM 2000		116		
		FDM 8000		23		
		FDM Quantum		164		
		FDM 3000		697		
		Dimension SST 1200 es		47.6 – 60.8		
		FDM 400 mc	Polycarbonate	149	Baumers et al.2010	
		Dimension SST 768	ABS P400	191,3	Yoon et al.2014	
VAT photopolymerization	SLA	SLA - 250	epoxy resin	33	Luo et al.1999	
		SLA - 3000		41		
		SLA - 5000		21		
Binder jetting	CJP	Z printer	ABS	14.5 – 17.2	Junk and Côté.2012	
Powder bed fusion	SLS	EOSINT M270	Stainless steel	114	Baumers et al.2010	
		EOSINT M250	metal powder (bronze + Ni)	710	Mognol et al.2006	
		EOSINT P390	PA 12	1346	Baumers et al.2010	
		Vanguard HiQ		15	Sreenivasan et al.2009	
		Sinterstation DTM 2000		40	Luo et al.1999	
		Sinterstation DTM 2500		30		
		EOSINT pP760		PA 2200 (0,12 mm)	39	Kellens et al.2010
				PA 2200 (0,15 mm)	40	
			PA 3200 GF (0,15mm)	36		
		Sinterstation HiQ	PA	68	Telenko et al.2012	
	SLM	MTT, SLM 250	Stainless steel 316L	31	Baumers et al.2010	
		M3 linear		164		
	EBM	Arcam A1	T1 -6Al -4V	50		
Directed energy deposition	LENS	Huron kX8	metal powder	24.2	Le Bourhis et al.2014	
		Optomec lens 750	Stainless steel 316L	385	Wilson et al.2014	

Table 1. SEC for various additive manufacturing processes

3. Methodology

This section presents the methodology developed to assess the environmental performance of AM processes. This methodology is divided into several major steps. Firstly, the manufacturing process is decomposed into different stages, including the CAD file preparation, the heating stage, the forming stage and the finishing process. Secondly, the electrical energy is measured for each stage of the manufacturing process. Thirdly, the electrical measurement is performed many times to have reliable data. Fourthly, the material and support quantity of the part are evaluated mathematically. Fifthly, data processing. Sixthly, all these acquired and calculated data are used to create a predictive model of the inventory data for any part geometry. Finally, in step 7 and 8, comparison between the estimated and measured inventory data for different parts is conducted. Figure 2 shows the methodology used in this paper to characterize the inventory data.

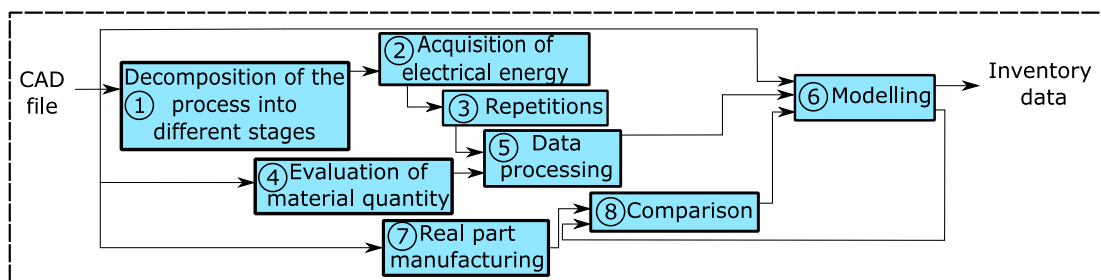

Figure 2. Methodology proposed

One of the main original point of the methodology in this approach is to combine a global view of the manufacturing process and local analyses of the different production stages. Thus, the manufacturing process is not divided into different features (motors, nozzle, etc.) but into different manufacturing stages (Figure 3).

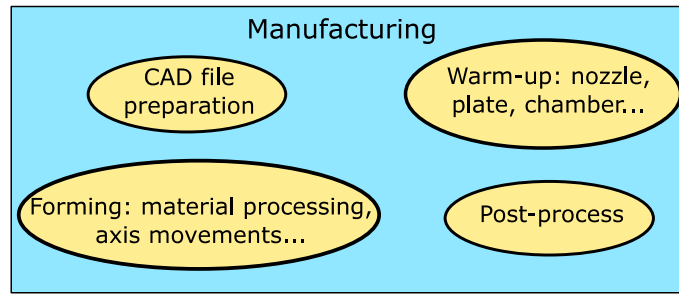

Figure 3. The four manufacturing stages

The first stage of the manufacturing process is the CAD file preparation. In this stage, the CAD file is prepared and sent to the machine. The warm-up stage initiates the manufacturing of parts. This second stage can be assimilated to a preparation mode. Indeed, before proceeding with parts fabrication, some components like the chamber, the plate, the nozzles need to be heated for the material processing. If the machine is equipped with a chamber or a plate, generally, it is warmed-up first. Then, the nozzles are warmed-up. Their temperatures are then maintained during the forming stage. Finally, when the temperature set points are reached, the forming stage can start to build the part layer by layer. Some parts may require a post-treatment after the build. This last production stage is for most of AM processes done by an external device. For all the AM processes, these four stages are always present regardless of the machine. Thus, this methodology is applicable to any AM machine. In every AM machine, there is also an idle mode. In this mode, the machine is switched on but all the components that participate in the material processing are powered off. Figure 4 shows the different manufacturing stages of AM process in the chronological order as well as the duration of each stage.

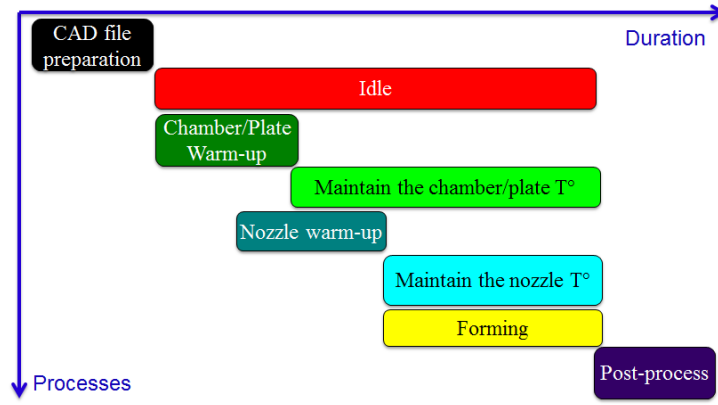

Figure 4. Manufacturing stages of AM processes

Once the decomposition of the process into different stages is done, the second step of the methodology is to acquire the electrical energy consumption. The acquisition is made by an external device plugged into the machine for measurement and a computer for saving data. The electrical study for each stage of AM processes is divided into two points. First a power study for all stages is realized and then a time study is conducted. Power study consists in the calculation of an average power of each stage and time study is performed only for warm-up stages because times of other stages are depending on the forming stage. In the third step of the methodology, these measurements are repeated several times in the same initial conditions to have reliable data. In the meantime, information about material and support quantity is calculated with equation (1) and (2) in step 4.

$$M_{part} = \frac{\rho_{part} \cdot V_{layer} \cdot H_{part}}{H_{layer}} \quad (1)$$

$$M_{support} = \frac{\rho_{support} \cdot V_{layer} \cdot H_{part}}{H_{layer}} \quad (2)$$

In these two equations, ρ_{part} and $\rho_{support}$ represent respectively the material density used for the part and the support processing. V_{layer} represents the volume of material used per layer, H_{part} is the total height of the part and H_{layer} is the layer thickness. These two

equations have been taken from previous work made by Meteyer et al. (2014). There are a lot of studies in the literature that give an accurate estimation of the material quantity during the manufacturing step of AM processes. However, we choose this study because of the versatility of these two equations. Indeed, they are applicable for all the AM processes.

Once steps three and four of the methodology are finished, an average power and duration is associated to each stage as well as an estimated material and support quantity for the part. Figure 5 **Erreur ! Source du renvoi introuvable.** shows an overview of the type of results obtained for the energy study after the data processing (step 5). Power values of all these manufacturing stages can vary because each power level stage will depend on the process and the machine used. Concerning the duration of each stage, only warm-up stages are not part-dependent and well known thanks to measurements. CAD file preparation and post-process stages require a human intervention. The two maintaining temperature stages and the idle stage are depending on the geometry of the manufactured part. Thus, the duration of these stages can vary.

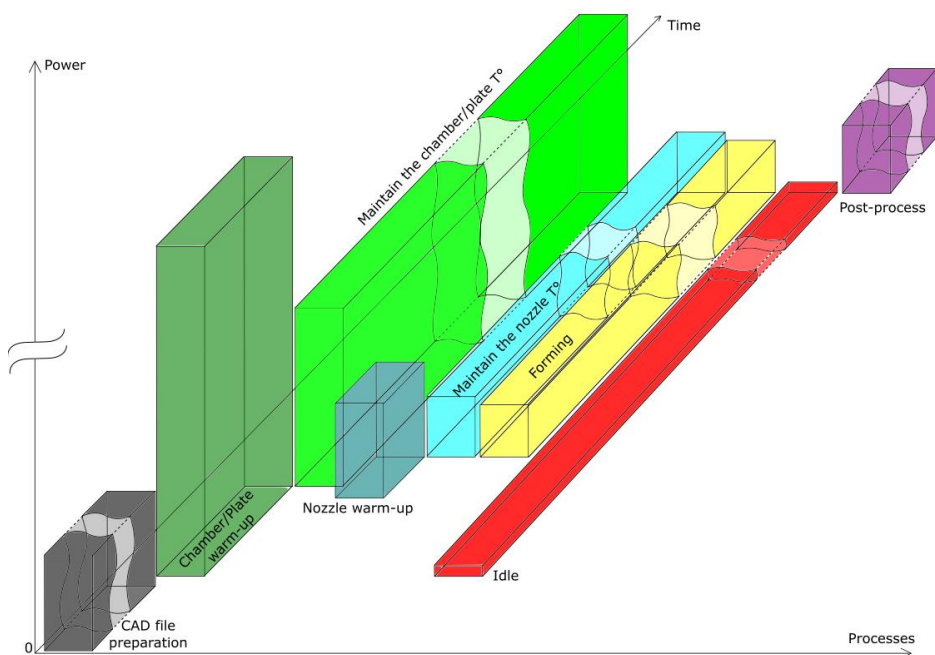

Figure 5. Overview of the results

With the power and the duration of each stage known, total electrical energy is calculated in kilowatt hour with equation (3) **Erreur ! Source du renvoi introuvable.** Figure 6 shows how electrical energy of each stage is obtained.

$$E_{total} = E_{cad} + E_{idle} + E_{chamber/plate} + E_{maint_chamb/pla} + E_{nozzle} + E_{maint_nozzle} + E_{forming} + E_{post-process} \quad (3)$$

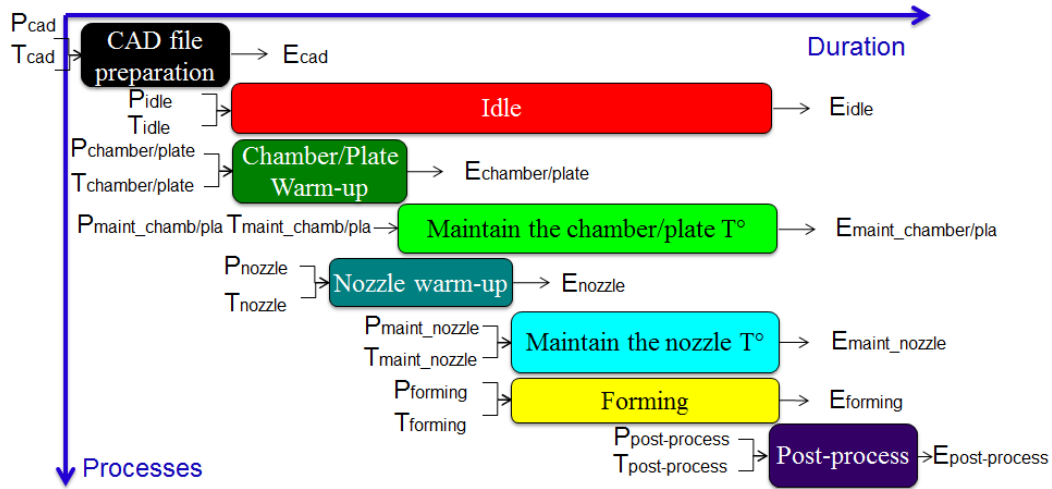

Figure 6. Electrical energy of each stage

Considering also the total amount of material used during the manufacturing of parts, the SEC of the couple part/process is calculated thanks to the equation (4).

$$SEC (kWh/kg) = \frac{E_{total} (kWh)}{mass\ of\ the\ part\ (kg)} \quad (4)$$

Then the sixth step of the methodology is a modelling step. With all these information about the electrical and material consumption during the manufacturing of a part, a predictive model of the inventory data is set up thanks to all the power and stage duration measurements. This model estimates the electrical energy and the material consumption of each manufacturing strategy. The operator has to inform the computational demonstrator about the total manufacturing time and the amount of material for parts and

for support. Information about build duration is given by the preparation software for the parts. Indeed, the software estimates a manufacturing time after placing the part on the virtual machine space of the software and selecting all the manufacturing parameters. From these estimated values of build duration and material quantity, it is possible to compute, before starting a build, the expected specific energy consumption.

Finally, in step 7 and 8 of the methodology, comparison of values between the predictive model and part manufactured are done to check the robustness of the model.

In this paper, the methodology is applied to the Fused Deposition Modeling (FDM) process. Thus, following sections present the methodology on this process.

4. Fused deposition modeling process

FDM is an additive manufacturing process that allows the fabrication of complex three dimensional parts directly from a computer-aided design model. The process was widely used for prototyping but following several years of development, FDM process has evolved from application used in rapid prototyping to functional parts of polymeric objects. This process is based on the extrusion of heated plastic filaments through a nozzle which deposits the melted polymeric material onto a platform to build parts layer by layer. Thermoplastic filament is pushed from a spool into the extruder by motors and rolls. The filament is heated into a semi-liquid state and then is extruded on a build platform. If necessary, support material is pushed from another spool into another extruder and is deposited on the build platform. Different kind of thermoplastic filaments are currently existing, going from the most used Acrylonitrile Butadiene Styrene (ABS) to Polylactic Acid and even Polyamide. Architecture of FDM machines is often the same: a three-axis machine which each axis is controlled by one motor. The nozzle moves thanks to position information directly read in the CNC program. Build chamber can be heated at a certain temperature depending on the machine. Entry level FDM machines have heated bed plate

instead of a heated chamber, some do not have a heated bed. When the part is finished, it is removed from the build plate. If there is a support structure, it can be removed by breaking it away from the part or dove into a chemical solution that separate it from the part without damaging the main part.

5. Results and discussion

5.1 Decomposition of the process into different stages

This methodology has been applied to a middle-range open source machine, Makerbot Replicator 2X (Makerbot Industries, 2009). Two stepper motors displace the nozzle. Each axis is controlled by one motor. This machine is also equipped with a movable (up and down) heat bed plate and a heating resistor on the extruder that rise respectively their temperature to 110 °C and 230 °C. Table 2 lists the parameters used in this study.

Machine	
Model	Makerbot
Year	2012
Nozzle T° (°C)	230
Plate T° (°C)	110
Material	ABS
Filament diameter (mm)	1.75
Process	
Layer height (mm)	0.2
Infill (%)	100
Number of shell	2
Travel speed (mm/s)	150
Extrusion speed (mm/s)	90
Raft	off
Support	off

Table 2. FDM machine parameters

The part used in this study is a parallelepiped of 30 mm x 30 mm x 10 mm made in ABS (Figure 7).

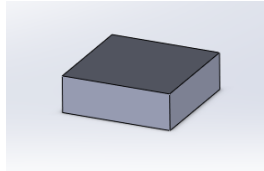

Figure 7. Studied academic parallelepiped

According to FDM machine manufacturers, different machines may have different configuration than that of the Makerbot one. Indeed, the material and the equipment vary from a machine to another. Sometimes, the heat bed plate is replaced by a heat chamber or nothing for low-cost machine. Thus the order of the different stages during the manufacturing steps can change depending on the machine. The different manufacturing stages of the Makerbot replicator 2X are represented in Figure 8. The figure below is a mono material representation. Only one nozzle is heated during the process.

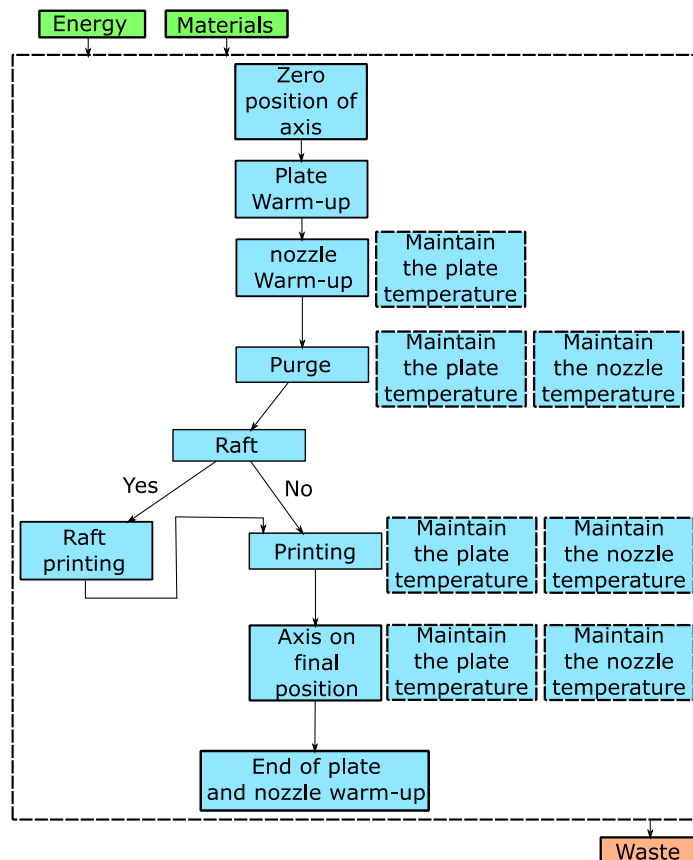

Figure 8. Overview of the different steps of the Makerbot Replicator 2X

Figure 9 represents the different manufacturing stages in the chronological order as well as the duration of each stage. The post-process stage does not appear because the part studied (Figure 7) does not require post-treatment.

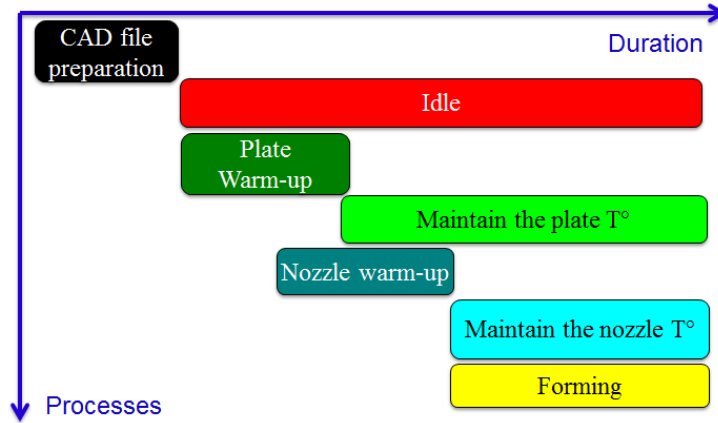

Figure 9. Manufacturing stages

After the CAD file is sent to the machine, the warm up stage starts with the rising temperature of the heat bed plate. When the temperature set point of the plate is reached, the nozzle begins to heat. While the nozzle is heating, the warm up of the heat bed plate continue for a few seconds and then its temperature is maintained during the rest of the manufacturing step. After the nozzle reached its temperature set point, the material extrusion starts. During the whole forming stage, the nozzle is maintained to its set point temperature. The environmental performance of the whole process can be now acquired starting by the electrical energy consumption and then the material consumption.

5.2 Acquisition of electrical energy

Electrical energy measurements were performed with a Norma 4000 power measurements three-phase power analyzer. Voltage probe was plugged in power socket in order to measure the voltage value in real time. Current clamp was plugged directly in the stripped supply power cable in power socket exit. This current sensor has an accuracy

of 1 % of reading ± 2 mA and a resolution of ± 1 mA. Hence, energy loss due to the electric transformer was taken into account for the electrical energy study. Instant power is calculated directly by the power meter by multiplying the rms-voltage, rms-current and power factor value. Then all the data were saved and processed to the power meter software on a computer. Figure 10 shows the electrical assembly diagram.

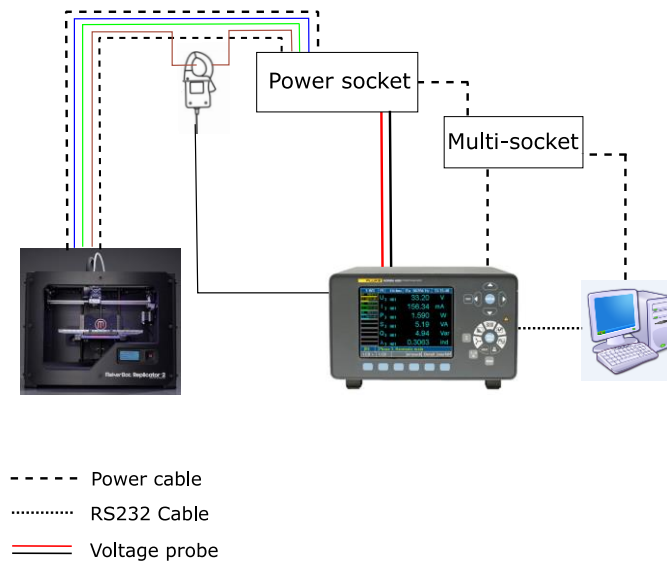

Figure 10. Electrical assembly diagram

Figure 11 shows a representative power measurement from the Makerbot replicator 2X cycle without the CAD file preparation. The electrical consumption of the CAD file preparation stage was measured separately on the computer where the file is prepared.

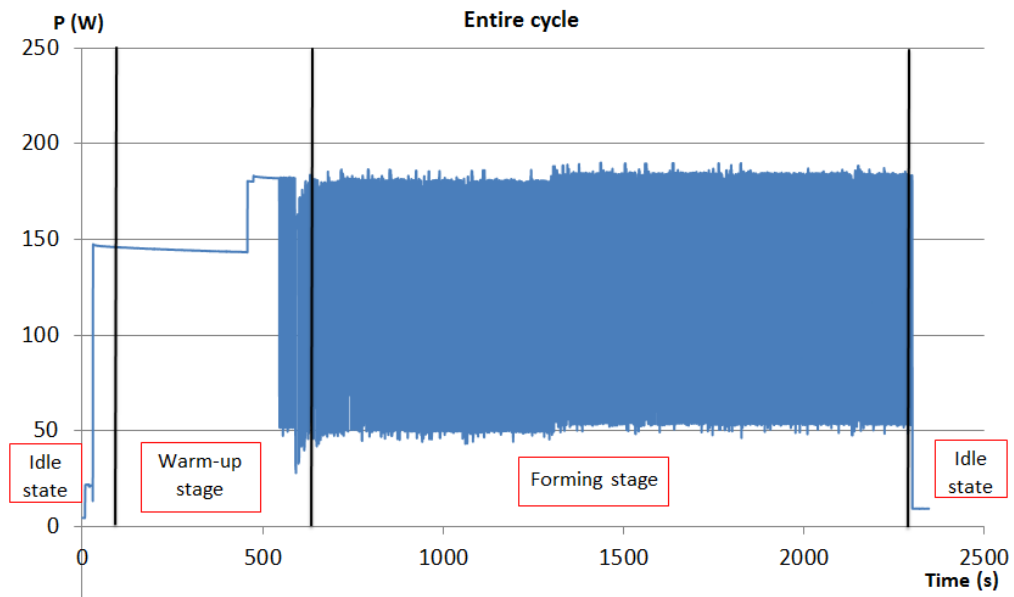

Figure 11: Manufacturing cycle for the academic part

The power measurement started while the machine is in standby mode. In this mode, the machine is not printing, however a little amount of electrical power is consumed because of the LCD screen and LEDs. Then, the operator process the cycle start button and the warm up stage begins. The first level of power corresponds to the rising temperature of the heat bed plate. The second level of power corresponds to the nozzle warm up. During this second level, the heat bed plate continues to warm up until its temperature set point is reached. After all the components have finished their warm up stage, the forming stage starts. A lot of oscillations can be observed during this last stage. These oscillations are not generated by the stepper motors. Indeed, values of current and voltage are the same all the time during the forming stage because of the nature of the motors. Oscillations are generated by the maintain of the heat bed plate. Indeed, during its warm up stage, its temperature set point is exceeded by 4 °C. Therefore the machine stops heating bed plate and its temperature decreases under its temperature set point. Then the machine detects that the heat bed plate is below its temperature set point and starts heating it again. Figure 12 shows a zoom during the forming stage. This physical phenomenon last only one to two seconds and is repeated during all the forming stage.

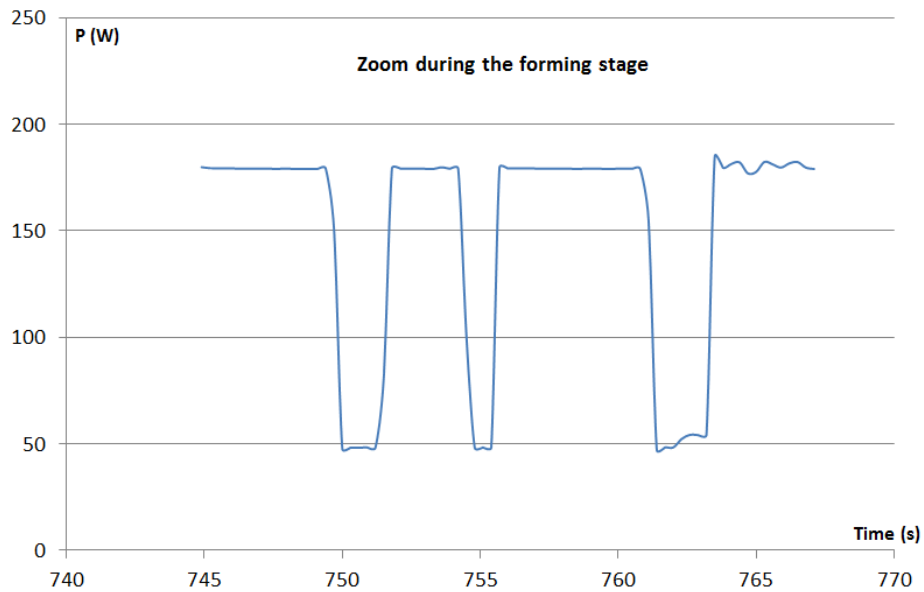

Figure 12: Zoom during the forming stage

5.3 Repetitions

Considering the machine studied is open source, the access of each stage can be selected manually. Thus, it was not necessary to launch a build to studying the desire stage. For both studies, all measurements were realized with the same initial condition. The workshop temperature was 20 °C for all the measurements but also the initial temperature of the heat bed plate and the nozzle was the same all the time. All the stage measurements were realized five times. The heat bed plate initial temperature was 20 °C and the power consumption was measured during its warm up to its set point temperature (110 °C). After each measurement, the heat bed plate was cooled down to its initial temperature and the experiment was realized again. The nozzle temperature and the heat bed plate were at 20 °C, the power is measured during the warm up to its temperature set point of 230 °C. For the heat bed plate and the nozzle maintaining temperature stages, measurements were performed during 30 minutes. Variation of power during idle state was very low, thus

measurements were performed only for 15 minutes. Knowing the power consumption for all stages, the average power of the forming stage could be easily calculated. Time study has been realized only for heat bed plate and nozzle warm up. Time of others stages depend on the forming stage duration and the forming stage depends on part geometry. Thus the heat bed plate and nozzle warm up duration were measured from their initial to their temperature set point five times. The duration of other stages is calculated after the print finishing knowing the entire build time and the warm up duration of the heat bed plate and the nozzle.

The most important consuming element for this machine is the heat bed plate with a peak of 138 W during the warm up stage and power ranging from 74 W to 75 W during the maintain of the plate temperature. Power usage during nozzle warm up ranges from 39 W to 40 W, is less than the heat bed plate because of its single heating resistor. During the maintain of the nozzle temperature, power varies from 25 W to 26 W forming stage has a constant power level of approximately 21 W. The average power of each stage for five measurements is listed in Table 3. Average power of each stage

Stage	Average power (W)	Standard deviation (W)
CAD file preparation	31.6	0.34
Idle state	4.40	0.28
Plate warm-up	137.39	1.19
Maintain the plate temperature	74.15	0.81
Nozzle warm up	39.57	1.06
Maintain the nozzle temperature	25.14	0.72
Forming stage	21.28	0.59

Table 3. Average power of each stage

A breakdown of the duration of the different stages is presented in Table 4. Duration of the different stage

Stage	Time(s)
CAD file preparation	300
Idle state	2280
Plate warm-up	525
Maintain the plate temperature	1755
Nozzle warm up	150
Maintain the nozzle temperature	1710
Forming stage	1710

Table 4. Duration of the different stage

For this specific part (Figure 7), the entire manufacturing time was 2280 seconds (38 minutes). Duration of plate and nozzle warm up has been measured five times separately of the entire cycle and for the five measures, the time for reaching their temperature set point for both components was the same. Forming stage duration is the same as the duration of the maintaining temperature stage of the nozzle and is calculated by subtracting the total warm up stage from the entire cycle duration.

5.4 Evaluation of material quantity

Estimation of material quantity is evaluated with equation (1). The part used in this study does not require support material due to its simple shape. Complex parts may require support material, equation (2) will be used to estimate the total amount of support quantity. Table 5 shows the difference between the calculated mass, the real mass obtained by a precision scale and the mass estimated by the Makerbot software. The same part was manufactured five times and the real mass was exactly the same when measuring with a 0.1 g precise machine.

Material	ρ_{ABS} (kg/m ³)	V_{layer} (mm ³)	H_{part} (mm)	H_{layer} (mm)	Calculated mass (g)	Real mass (g)	Mass estimated by the software (g)
30 x 30 x 10 parts	1080	163,6	10	0,2	8.6	8.7	12.2

Table 5. Material evaluation

V_{layer} is calculated thanks to equation (5). Others information are given by the CAD file and the software.

$$V_{\text{layer}} = \frac{V_{\text{total}}}{\text{Number of layer}} \quad (5)$$

More accurate results are obtained by using the equation than the estimation made by the software. The error in percentage between the calculated mass and the real mass is 1.1 % and between the real mass and the mass estimated by the software is 40 % for this specific part.

5.5 Data processing

Figure 13 represents the power and the duration associate to each manufacturing stage. This figure shows a picture of the Makerbot machine where the weight of each stage in terms of power consumption and duration are put forward. Compare to the forming stage, the warm-up stages including both heat bed plate and nozzle heat is much energy consuming. However the duration of the maintain of temperature for the two devices are depending to the forming stage duration. Considering that heat bed plate is the most consuming component, one way to enhance the environmental performance of this

machine is to reduce the forming stage duration. Another way is to reduce the power of the warming-up system of the machine. Average power and time of each stage are now well known, electrical energy consumption is calculated thanks to equation (3). Knowing also the mass of the part (8.7 g), the specific energy consumption (kWh/kg) is calculated as 9.51 kWh/kg.

Compare to the SEC values for FDM process investigated by other authors, the SEC in this paper scores significantly lower. This difference is justified by the type of machine studied by the other authors. Indeed, all the FDM machines studied in Table 1 are industrial machines. The powers involved in this kind of machine are greater than in low-cost open-source machines.

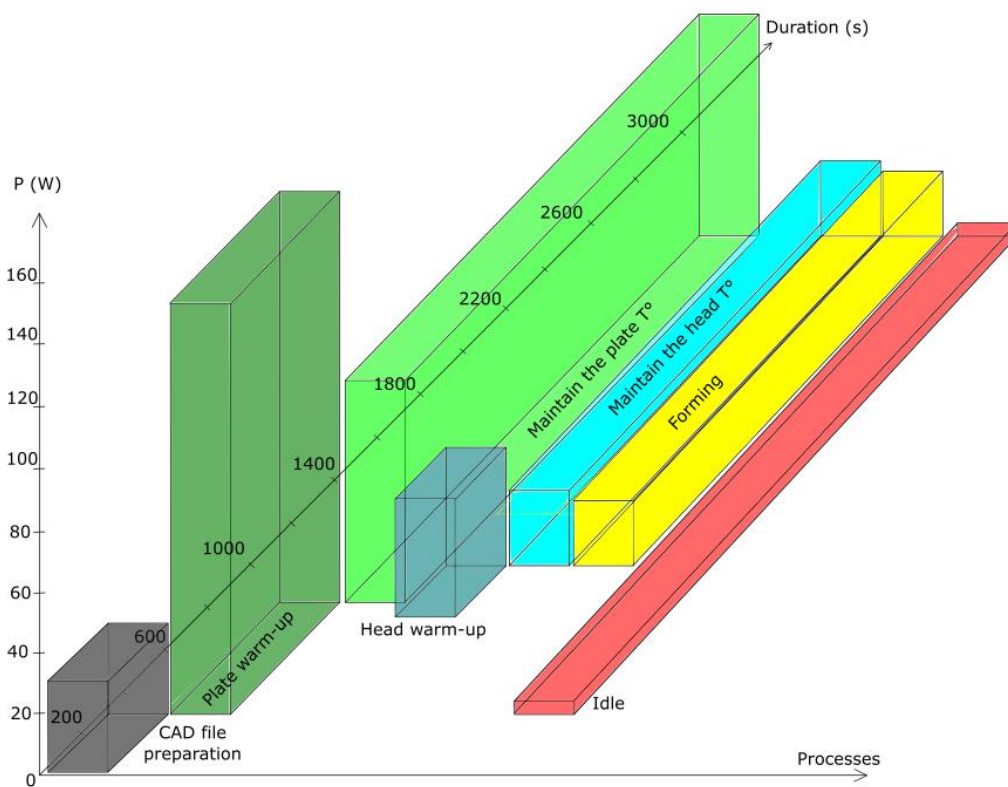

Figure 13: Picture of the consumption of each stage of the Makerbot

5.6 Modelling

Step 2, 3, 4 and 5 of the methodology (Figure 2) allow manufacturers to collect data about electrical and material consumption during parts fabrication. Thanks to all the measurements, a predictive model can be set up in order to estimate the electrical energy and material consumption for any manufacturing strategy.

Figure 14 and equation (Erreur ! Référence non valide pour un signet.6) show how the total energy is calculated in this model. The average power of each stage is known due to the previous measurements (green in Figure 14). The known duration (green in Figure 14) before starting the printing are T_{idle} , T_{plate} , T_{nozzle} and a total warm up time that combine T_{plate} and T_{nozzle} called $T_{warm-up}$. However, some durations depends on the geometry of the part (red in Figure 14). Thus, it is not possible to associate with these durations an average value that remain constant.

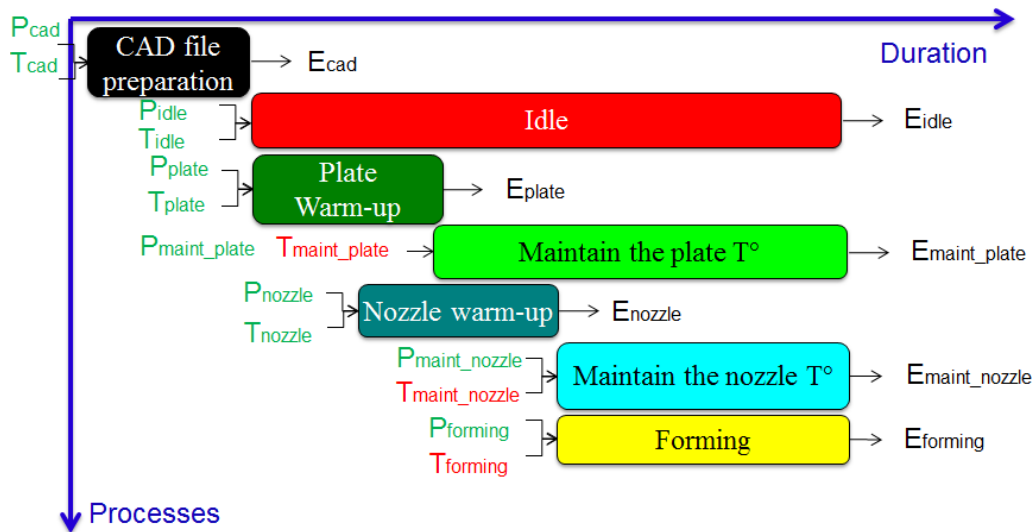

Figure 14. Method of calculation

$$E_{total} = (P_{cad} \times T_{cad}) + (P_{idle} \times T_{idle}) + (P_{plate} \times T_{plate}) + (P_{maint_pla} \times T_{maint_pla}) + (P_{nozzle} \times T_{nozzle}) +$$

$(P_{maint_nozzle} \times T_{maint_nozzle}) + (P_{forming} \times T_{forming})$ (Erreur ! Référence non valide pour un signet.6)

Duration that are depending on the part geometry are calculated in the following way.

$$T_{Maint_Pla} = T_{forming} + (T_{Warm-up} - T_{plate}) \quad (7)$$

$$T_{forming} = T_{Maint_nozzle} = T_{Idle} - T_{Warm-up} \quad (8)$$

Figure 15 presents the different stage duration in the manufacturing cycle of the machine for a better understanding.

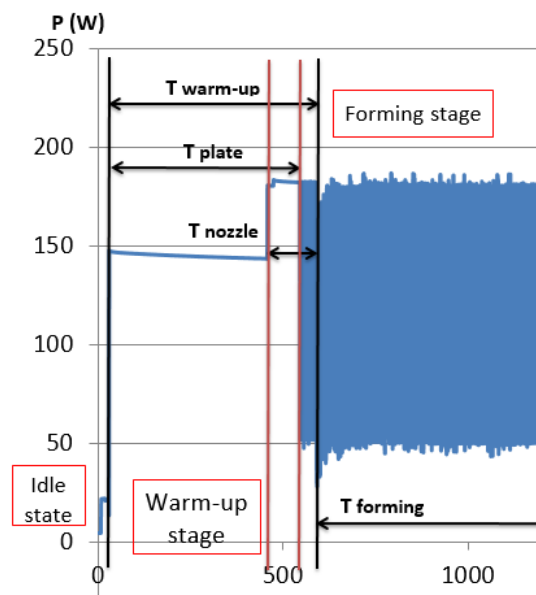

Figure 15. Stage duration in the manufacturing cycle

Once the operator has informed the numerical tool about the total manufacturing time, all the unknown times are calculated with equations (7) and (8). Thus, the total energy consumption is estimated. To evaluate of the material quantity, the operator has to inform

about the total volume of the part and the total height for an accurate estimation of the mass.

5.7 Comparison between the real and the model for several parts

New parts has been designed in order to apply the predictive model to different geometry (Table 6. SEC of various parts

). For this cylindrical part, the total manufacturing time estimated by the software is 780 seconds and the real time is 846 seconds. This difference between the estimated and the real manufacturing time cause an error of 7.8 %. Electrical energy consumption was also calculated not with estimation but with the real time and the percentage of error between these two values are 7.68 %. Same parts of 30 mm x 10 mm x 10 mm dimension were manufactured with different orientations. The first one was built according to Z axis direction and the other one was built according to X, Y plan.



Part	Dimension s	Estimate d time (s)	Real time (s)	Time error (%)	SEC (kWh/kg)	Energy error (%)
	R = 15 h = 4.25	780	846	7.87	7.64	7.61
	10 x 10 x 30	1410	1483	4.92	13.01	4.88
	30 x 10 x 10	1020	1067	4.39	9.38	4.16

Table 6. SEC of various parts

The specific energy consumption of the part built in the Z axis direction is higher than the other one. It is because FDM process build time is primary influenced by Z height, therefore a taller part will result in a longer build time. Considering that the manufacturing time of these two parts is different but their masses are the same, their specific energy consumption is therefore different. For the manufactured parts studied in the model, the energy error varies approximately from 4 % to 8 % between the estimated and the measured energy. This percentage of error is satisfying for low dimension parts. However, other studies for bigger parts and functional parts have to be done to improve the model.

Table 7. Mass of the different parts

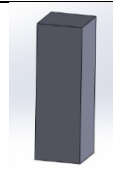
represents the mass of the parts obtained by the tree different methods. For the cylindrical part, the error in percentage between the calculated mass and the real mass is 6.8 % and between the real mass and the mass estimated by the software is 38 % . . For the rectangular shape, the error in percentage between the calculated mass and the real mass is 3.3% and between the real mass and the mass estimated by the software is 37.3 % . Equation (1) and (2) used in this methodology are more accurate to estimate the mass of a part than the Makerbot software for all the parts studied in this article.

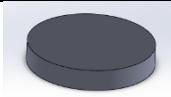
Material	ρ_{ABS} (kg/m ³)	V_{layer} (mm ³)	H_{part} (mm)	H_{layer} (mm)	Calculated mass (g)	Mass	
						Real mass (g)	estimated by the software (g)
	1080	115.5	4.25	0.2	2.7	2.9	4



	20	30	2.9	3	4.12
	54.5	10			

Table 7. Mass of the different parts

The previous studied parts have a pretty basic shape and are not representative of the capability of AM processes. To overcome this situation, two parts with more complex shape has been designed and manufactured in order to show that the developed model is predicting reliable data for any part geometry. Figure 16 represents an impeller present in cars engine to the left and a cup holder optimized topologically to the right.

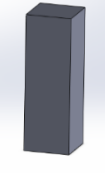
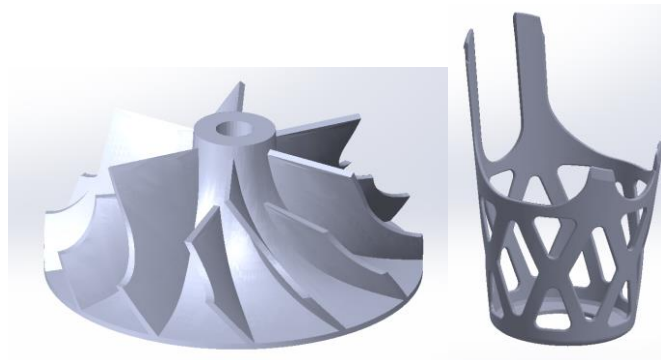

Figure 16.

Table 8 represents the estimated and the real values of the electrical energy consumption and Table 9 shows the estimated and real masses for the impeller and the cup holder. Even if the studied parts in this case are more complex, the difference between the model and the real remains acceptable.

	Electrical energy (estimated Wh)	Electrical energy (real Wh)	Gap (%)
Impeller	180.6	191	5.5
Cup holder	109.8	118.1	7

Table 8.

Mass of the part (estimated g)	Mass of the part (real g)	Gap (%)	Mass of the support (estimated g)	Mass of the support (real g)	Gap (%)
Impeller					
Cup holder					

Table 9.

6. Conclusion

The proposed methodology assesses, with accuracy, the life cycle inventory of FDM process during the manufacturing step. This methodology not only focuses on the electrical energy consumption but also on material consumption which is often forgotten when environmental impacts of these processes are realized. Future work on the inventory data of this additive manufacturing process will be to take into account the process emission and the creation of the feedstock filament. There are actually no life cycle inventory data on these features. This paper also describes the development of a parametric process model, which provides to an operator, accurate estimations of the environmental performances of FDM process. This model allows users to quantify the environmental footprint of their FDM parts during the product design stage. Thus, it is possible for the designer to change the product design for a better ecofriendly part. With this

methodology, it is possible to compare the environmental performances of all kind of AM machine.

Future work will use this methodology on others AM machine for the purpose of making a comparison of the environmental performances of machines. Different parts will be made to improve the model for a better accuracy.

References

- Balogun, V. A., Kirkwood, N. D., & Mativenga, P. T. (2014). Direct Electrical Energy Demand in Fused Deposition Modelling. *Procedia CIRP*, 15, 38–43.
- Baumers, M., Tuck, C., Hague, R., Ashcroft, I., & Wildman, R. (2010). A comparative study of metallic additive manufacturing power consumption. *Solid Free Fabr Symp*, 278–288.
- Baumers, M., Tuck, C., Wildman, R., Ashcroft, I., & Hague, R. (2011). Energy inputs to additive manufacturing: Does capacity utilization matter? *Solid Free Fabr Symp*, 30–40.
- Bourell, D. L., Beaman, J. J., Leu, M. C., & Rosen, D. W. (2009). A Brief History of Additive Manufacturing and the 2009 Roadmap for Additive Manufacturing: Looking Back and Looking Ahead, (2).
- Burkhart, M., & Aurich, J. C. (2015). Framework to predict the environmental impact of additive manufacturing in the life cycle of a commercial vehicle. *Procedia CIRP*, 29, 408–413.
- Huang, R., Riddle, M., Graziano, D., Warren, J., Das, S., Nimbalkar, S., Masanet, E. (2015). Energy and Emissions Saving Potential of Additive Manufacturing: The Case of Lightweight Aircraft Components. *J Clean Prod*, 1559-1570.
- Junk, S., & Côté, S. (2012). A practical approach to comparing energy effectiveness of rapid prototyping, Proc of AEPR'12, 17th eur forum on rapid prototyp and manuf, 12–14.
- Junk, S., & Côté, S. (2013). *Influencing variables on sustainability in additive manufacturing*. Offenburg - Germany: Helena Bartolo.

- Kellens, K., Dewulf, W., Overcash, M., Hauschild, M. Z., & Duflou, J. R. (2012a). Methodology for systematic analysis and improvement of manufacturing unit process life cycle inventory (UPLCI) CO2PE! initiative (cooperative effort on process emissions in manufacturing). Part 1: Methodology description . *Int J Life Cycle Assess*, *17*(2), 242–251.
- Kellens, K., Dewulf, W., Overcash, M., Hauschild, M. Z., & Duflou, J. R. (2012b). Methodology for systematic analysis and improvement of manufacturing unit process life cycle inventory (UPLCI) CO2PE! initiative (cooperative effort on process emissions in manufacturing). Part 2: Case studies. *Int J Life Cycle Assess*, *17*(2), 242–251.
- Kellens, K., Yasa, E., Dewulf, W., & Duflou, J. R. (2010). Environmental assessment of selective laser melting and selective laser sintering. *Going Green - CARE Innov*, (Section 4).
- Le Bourhis, F., Kerbrat, O., Dembinski, L., Hascoet, J.-Y., & Mognol, P. (2014). Predictive Model for Environmental Assessment in Additive Manufacturing Process. *Procedia CIRP*, *15*, 26–31.
- Lee, J., An, J., & Chua, C. K. (2017). Fundamentals and applications of 3D printing for novel materials. *Applied Materials Today*, *7*, 120–133.
- Lee, J., See, W., An, J., Kai, C., Tang, C. Y., Fane, A. G., & Haur, T. (2016). The potential to enhance membrane module design with 3D printing technology. *Journal of Membrane Science*, *499*, 480–490.
- Luo, Y. L. Y., Ji, Z. J. Z., Leu, M. C., & Caudill, R. (1999). Environmental performance analysis of solid freedom fabrication processes. *Proc of the 1999 IEEE Int Symp on Electron and the Environ (Cat. No.99CH36357)*.
- Makerbot Industries. (2009). Makerbot replicator 2X. Retrieved from <http://store.makerbot.com/replicator2x>
- Masood, S. H. (2014). *Advances in Fused Deposition Modeling. Comprehensive Materials Processing* (Vol. 10). pp 69-91.
- Meteyer, S., Xu, X., Perry, N., & Zhao, Y. F. (2014). Energy and Material Flow Analysis of Binder-jetting Additive Manufacturing Processes. *Procedia CIRP*, *15*, 19–25.
- Mognol, P., Lopicart, D., & Perry, N. (2006). Rapid prototyping: energy and environment in the spotlight. *Rapid Prototyp J*, *12*(1), 26–34.

- Morrow, W. R., Qi, H., Kim, I., Mazumder, J., & Skerlos, S. J. (2007). Environmental aspects of laser-based and conventional tool and die manufacturing. *J Clean Prod*, 15(10), 932–943.
- Sreenivasan, R., & Bourell, D. L. (2009). Sustainability study in selective laser sintering – An energy perspective. *Solid Free Fabr Symp*, 257–265.
- Sreenivasan, R., Goel, A., & Bourell, D. L. (2010). Sustainability issues in laser-based additive manufacturing. *Phys Procedia*, 5, 81–90.
- Telenko, C., & Seepersad, C. C. (2012). A comparative evaluation of energy consumption of Selective Laser Sintering and Injection Molding of Nylon parts. *Solid Free Fabr Symp*, 41–54.
- Wilson, J. M., Piya, C., Shin, Y. C., Zhao, F., & Ramani, K. (2014). Remanufacturing of turbine blades by laser direct deposition with its energy and environmental impact analysis. *J Clean Prod*, 80, 170–178.
- Wittbrodt, B. T., Glover, A. G., Laureto, J., Anzalone, G. C., Oppliger, D., Irwin, J. L., & Pearce, J. M. (2013). Life-cycle economic analysis of distributed manufacturing with open-source 3-D printers. *Mechatron*, 23(6), 713–726.
- Wohlers, T. (2015). *Additive manufacturing and 3D printing state of the industry*.
- Yoon, H.-S., Lee, J.-Y., Kim, H.-S., Kim, M.-S., Kim, E.-S., Shin, Y.-J., ... Ahn, S.-H. (2014). A comparison of energy consumption in bulk forming, subtractive, and additive processes: Review and case study. *Int J Precis Eng and Manuf-Green Technol*, 1(3), 261–279.