



**HAL**  
open science

## Uncertainty propagation of p-boxes using sparse polynomial chaos expansions

R Schöbi, B Sudret

► **To cite this version:**

R Schöbi, B Sudret. Uncertainty propagation of p-boxes using sparse polynomial chaos expansions. 2016. hal-01421112

**HAL Id: hal-01421112**

**<https://hal.science/hal-01421112>**

Preprint submitted on 21 Dec 2016

**HAL** is a multi-disciplinary open access archive for the deposit and dissemination of scientific research documents, whether they are published or not. The documents may come from teaching and research institutions in France or abroad, or from public or private research centers.

L'archive ouverte pluridisciplinaire **HAL**, est destinée au dépôt et à la diffusion de documents scientifiques de niveau recherche, publiés ou non, émanant des établissements d'enseignement et de recherche français ou étrangers, des laboratoires publics ou privés.

# UNCERTAINTY PROPAGATION OF P-BOXES USING SPARSE POLYNOMIAL CHAOS EXPANSIONS

R. Schöbi, B. Sudret



## Data Sheet

---

**Journal:** -

**Report Ref.:** RSUQ-2016-009

**Arxiv Ref.:** <http://arxiv.org/abs/1608.05565> - [stat.CO]

**DOI:** -

**Date submitted:** August 19, 2016

**Date accepted:** -

---

# Uncertainty propagation of p-boxes using sparse polynomial chaos expansions

R. Schöbi<sup>1</sup> and B. Sudret<sup>1</sup>

<sup>1</sup>*Chair of Risk, Safety and Uncertainty Quantification,  
ETH Zurich, Stefano-Frascini-Platz 5, 8093 Zurich, Switzerland*

## Abstract

In modern engineering, physical processes are modelled and analysed using advanced computer simulations, such as finite element models. Furthermore, concepts of reliability analysis and robust design are becoming popular, hence, making efficient quantification and propagation of uncertainties an important aspect. In this context, a typical workflow includes the characterization of the uncertainty in the input variables. In this paper, input variables are modelled by probability-boxes (p-boxes), accounting for both aleatory and epistemic uncertainty. The propagation of p-boxes leads to p-boxes of the output of the computational model. A two-level meta-modelling approach is proposed using non-intrusive sparse polynomial chaos expansions to surrogate the exact computational model and, hence, to facilitate the uncertainty quantification analysis. The capabilities of the proposed approach are illustrated through applications using a benchmark analytical function and two realistic engineering problem settings. They show that the proposed two-level approach allows for an accurate estimation of the statistics of the response quantity of interest using a small number of evaluations of the exact computational model. This is crucial in cases where the computational costs are dominated by the runs of high-fidelity computational models.

**Keywords:** uncertainty quantification – uncertainty propagation – probability-boxes – surrogate models – sparse polynomial chaos expansions – non-intrusive methods

## 1 Introduction

In modern engineering, computational simulations (*e.g.* finite element-based simulations) have become a popular tool for predicting and analysing the behaviour of mechanical systems or en-

gineering structures. The increasing knowledge in science and engineering leads to models of larger complexity, which requires increasing computational resources. At the same time, awareness on quantitative reliability, robustness, and design optimization is growing. Engineers are more and more concerned with the quantification of uncertainties (Sudret, 2007; De Rocquigny, 2012; Forrester et al., 2008).

In this context, a typical workflow consists of defining a computational model, determining a model for the uncertain input parameters, then propagating and analysing the uncertainty in the quantities of interest (QoI). The uncertainty in input parameters is traditionally quantified by probability theory, which describes the variability of a parameter by a single measure. However, in many situations probability theory is not appropriate to quantify completely uncertainty in the parameters. Indeed, aleatory uncertainty corresponds to the natural variability of an input parameter (non-reducible), whereas epistemic uncertainty is related to lack of knowledge which, in principle, could be reduced by gathering more information (*e.g.* data points, measurements) (Der Kiureghian and Ditlevsen, 2009).

A number of methods have been proposed to capture the characteristics of so-called *imprecise probabilities* which include aleatory as well as epistemic uncertainties. Amongst those methods are Dempster-Shafer structures (Dempster, 1967; Shafer, 1976), possibility theory (Dubois and Prade, 1988), Bayesian hierarchical models (Gelman et al., 2009), fuzzy sets (Möller and Beer, 2004), probability-boxes (p-boxes) (Ferson and Ginzburg, 1996), clouds (Neumaier, 2004; Destercke et al., 2008), and random sets (Matheron, 1975; Molchanov, 2005). The focus of this paper lies on p-boxes, which are defined by lower and upper boundary curves to the cumulative distribution function of an input variable.

In the context of probabilistic input, uncertainty propagation methods have been widely studied in the last decades through Monte Carlo simulation. However, when considering p-boxes in the input space, uncertainty propagation is more complex. A much lower number of methods have been developed for propagating p-boxes, amongst which are nested Monte Carlo algorithms (Eldred and Swiler, 2009; He et al., 2015) and interval-analysis-based algorithms (Helton and Oberkampf, 2004; Helton et al., 2004). These algorithms require a large number of model evaluations to ensure an accurate estimate of the uncertainty in the QoIs. Then, in the general case of expensive-to-evaluate models, these types of algorithms may become intractable.

A popular strategy to reduce computational costs in uncertainty propagation is the use of meta-models in order to surrogate the exact model by an approximative, inexpensive-to-evaluate function (Sudret, 2015). Common meta-modelling techniques are Gaussian process models (a.k.a Kriging) (Santner et al., 2003; Krige, 1951), Polynomial Chaos Expansions (PCE) (Ghanem and Spanos, 2003) and support vector machines (Gunn, 1998). Traditionally, meta-modelling techniques have been used in the context of probabilistic input in a variety of problems such

as uncertainty propagation (Blatman and Sudret, 2010; Schöbi et al., 2015), sensitivity analysis (Sudret, 2008), structural reliability analysis (Echard et al., 2011; Balesdent et al., 2013; Schöbi et al., 2016) and design optimization (Dubourg et al., 2011; Moustapha et al., 2016).

In contrast, meta-modelling techniques have only been used in few occasions to propagate uncertainties modelled by imprecise probabilities. Recent contributions include Chen et al. (2015), where fuzzy sets are propagated using generalized polynomial chaos meta-models, Hu and Du (2015), where Kriging is used to estimate failure probabilities, and Li and Xiu (2012), where epistemic uncertainty is propagated using polynomial surrogate models.

In this paper, we introduce a novel approach to propagate uncertainties modelled by p-boxes through complex computational models using sparse non-intrusive polynomial chaos expansions. The paper is structured as follows: Section 2 introduces the definition of p-boxes followed by the definition of two case studies inspired by engineering practice. Uncertainty propagation and related algorithms are discussed in Section 3. Section 4 introduces the proposed approach, which makes use of meta-models at two levels of the uncertainty propagation workflow. Three applications (Section 5) are used to illustrate and discuss the proposed method. The paper terminates with conclusions in Section 6.

## 2 Imprecise probability

### 2.1 Probability theory

Consider the probability space  $(\Omega, \mathcal{F}, \mathbb{P})$ , where  $\Omega$  denotes the outcome space equipped with the  $\sigma$ -algebra  $\mathcal{F}$  and a probability measure  $\mathbb{P}$ . A random variable  $X$  is defined by the mapping  $X(\omega) : \Omega \rightarrow \mathcal{D}_X \subset \mathbb{R}$ , where  $\omega \in \Omega$  is an elementary event and  $\mathcal{D}_X$  is the support domain of  $X$ . A realization of the random variable  $X$  is denoted by the corresponding lower case letter  $x$ . A random variable  $X$  is typically characterized by a *cumulative distribution function* (CDF)  $F_X$  where  $F_X(x) \stackrel{\text{def}}{=} \mathbb{P}(X \leq x)$ . For continuous random variables, the corresponding *probability density function* (PDF) is defined by  $f_X(x) = dF_X(x)/dx$ .

As seen in the definitions above, probability theory provides a single measure to quantify uncertainty in  $X$ . In other words, it is assumed that the uncertainty is known and quantifiable by a probability distribution through its CDF (and related PDF). In many cases, however, knowledge on  $X$  is incomplete and probability theory is not sufficient to describe the uncertainty. In the sequel, we introduce a more general framework known as *probability-boxes*.

### 2.2 Probability-boxes

The motivation for probability-boxes (hereinafter called *p-boxes*) is that one may not be able to define a precise CDF due to lack of knowledge (epistemic uncertainty). Hence, the framework

of p-boxes accounts for aleatory (natural variability) as well as for epistemic uncertainty in the description of variable  $X$ .

Mathematically speaking, a *p-box* is defined by lower and upper bounds to the CDF of  $X$ , denoted by  $\underline{F}_X$  and  $\overline{F}_X$  respectively (Ferson and Ginzburg, 1996; Ferson and Hajagos, 2004). For any value  $x \in \mathcal{D}_X$  the true but unknown CDF lies within these bounds, *i.e.*  $\underline{F}_X(x) \leq F_X(x) \leq \overline{F}_X(x)$ ,  $\forall x \in \mathcal{D}_X$ . The boundary curves of the p-box mark extremes of the CDF and are thus themselves CDFs by definition. Note that this type of p-boxes is called *free* p-boxes in the literature as opposed to parametric p-boxes, which are defined as a distribution the parameters of which are modelled by intervals (Ferson et al., 2003; Schöbi and Sudret, 2015b). In this paper, only free p-boxes are discussed, because they are a generalization of parametric p-boxes. Hence in the remainder of the paper, the adjective *free* will be omitted in the context of free p-boxes for the sake of simplicity.

The name *probability-box* comes from the fact that  $\underline{F}$  and  $\overline{F}$  define an intermediate space which resembles a box, as it can be seen in Figure 1. When the bounds of the p-box coincide for every  $x \in X$ , *i.e.*  $\underline{F}_X(x) = \overline{F}_X(x)$ , the corresponding p-box degenerates into a single CDF, as it is usual in standard probability theory.

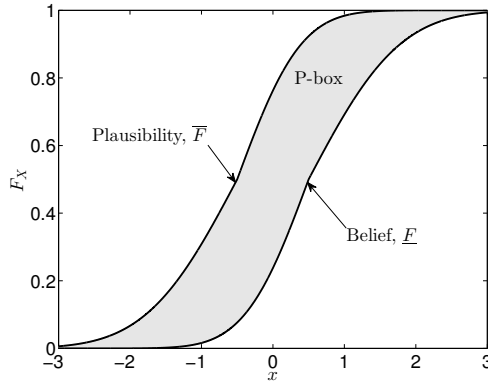

Figure 1: Probability-boxes

The framework of probability-boxes is strongly connected to Dempster-Shafer’s theory of evidence (Dempster, 1967; Shafer, 1976), as previously discussed in *e.g.* Walley (2000) and Ferson et al. (2004). The bounds  $\underline{F}_X$  and  $\overline{F}_X$  can be interpreted as belief and plausibility measures for the event  $\{X \leq x\}$  (see also Figure 1). The *belief* describes the minimum amount of probability that *must* be associated with the event  $\{X \leq x\}$  whereas the *plausibility* describes the maximum amount of probability that *might* be associated to the same event.

## 2.3 Determination of p-box bounds

A number of methods exist for determining the boundary curves of the p-box depending on the type of information accessible (Ferson et al., 2003). These methods include robust Bayesian analysis (Berger, 1985; Zhang et al., 2013), Chebyshev’s inequalities (Oberguggenberger and Fellin, 2008; Chebyshev, 1874), and Kolmogorov-Smirnov confidence limits (Kolmogoroff, 1941; Smirnov, 1939; Zhang et al., 2013). Additionally, the type of information can be diverse: precise or imprecise data from measurements, expert opinions obtained in a survey, or a mixture of both. Hence in the sequel, two cases are distinguished for defining a p-box by aggregation of data in the main part of this paper. These cases lead us to define two scenarios inspired by the engineering practice.

### 2.3.1 Case #1 – interval-valued expert opinions

Consider the case where different experts are asked to name an interval for describing the possible values of a variable. Expert  $i = 1, \dots, n_E$  provides an interval  $x^{(i)} \in [\underline{x}^{(i)}, \bar{x}^{(i)}]$ . Additionally, a mass of credibility  $w^{(i)}$  is assigned to each expert accounting for the expert’s knowledge. Note that the credibility is defined here as a relative value so that  $\sum_{i=1}^{n_E} w^{(i)} = 1$ . Figure 2(A) displays a set of seven expert opinions (horizontal intervals) and their credibility (number next to intervals).

A large variety of methods for aggregating multiple sources of information have been proposed in the literature (Ferson et al., 2003; Ayyub, 2001; Ayyub and Klir, 2006). In this paper, the *mixture method* described in Ferson et al. (2003) is applied under the assumption that the disagreement between the various estimates of the variable represents actual variability (*i.e.* aleatory uncertainty). According to the mixture method, the lower and upper boundary of the p-box are defined as the CDF of the lower bounds  $\underline{x}^{(i)}$  and the upper bounds  $\bar{x}^{(i)}$  of the intervals taking into consideration their weights:

$$\underline{F}_X(x) = \sum_{i=1}^{n_E} w^{(i)} \cdot \mathbb{I}_{\underline{x}^{(i)} \leq x}(x), \quad \bar{F}_X(x) = \sum_{i=1}^{n_E} w^{(i)} \cdot \mathbb{I}_{\bar{x}^{(i)} \leq x}(x), \quad (1)$$

where  $\mathbb{I}_{(\cdot)}$  is the indicator function with  $\mathbb{I} = 1$  for a true subscript statement and  $\mathbb{I} = 0$  otherwise. The resulting p-box corresponding to the expert opinions in Fig. 2(A) is shown in Fig. 2(B).

### 2.3.2 Case #2 – CDF-shaped expert opinions

**Case #2(a)** Experts are asked to give their opinion on the behaviour of a variable in the form of a CDF. Each expert provides a formulation for the CDF denoted by  $F_X^{(i)}, i = 1, \dots, n_E$ , where the support of  $X$  is possibly unbounded. An example of seven expert CDFs is shown in



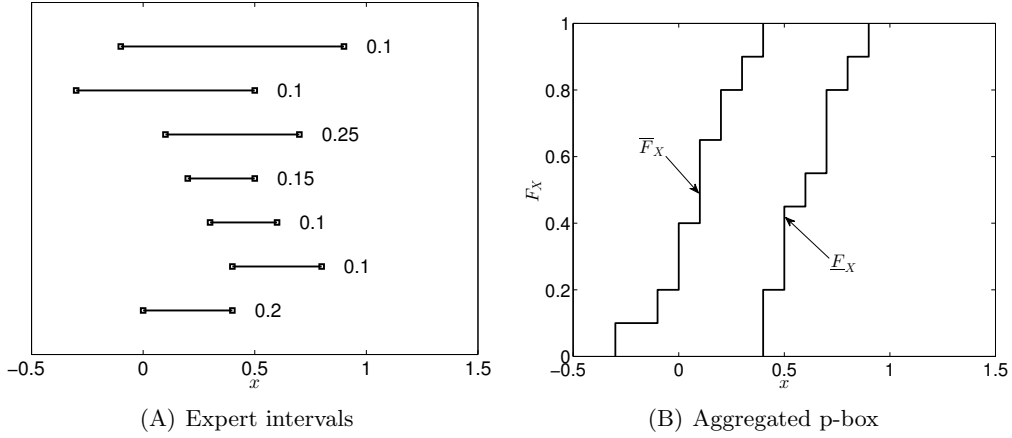

Figure 2: Case #1 – p-box as a combination of expert intervals and credibility measures

Figure 3(A). Assuming that these seven CDFs describe the uncertainty in the system (epistemic and aleatory) the p-box can be generated by the envelope of the experts' CDFs (Ferson et al., 2003; Fu et al., 2011):

$$\underline{F}_X(x) = \min_{i=1,\dots,n_E} F_X^{(i)}(x), \quad \bar{F}_X(x) = \max_{i=1,\dots,n_E} F_X^{(i)}(x), \quad \forall x \in \mathcal{D}_X. \quad (2)$$

Note that contrary to Case #1, the credibility of the experts is not considered in Case #2. Assuming that the true CDF lies between the experts' CDF, the envelope of all opinions includes the true CDF, thus forming a valid p-box. The resulting p-box for the CDFs in Fig. 3(A) can be found in Fig. 3(B). The boundary curves of the p-box consist of sections of different input CDFs.

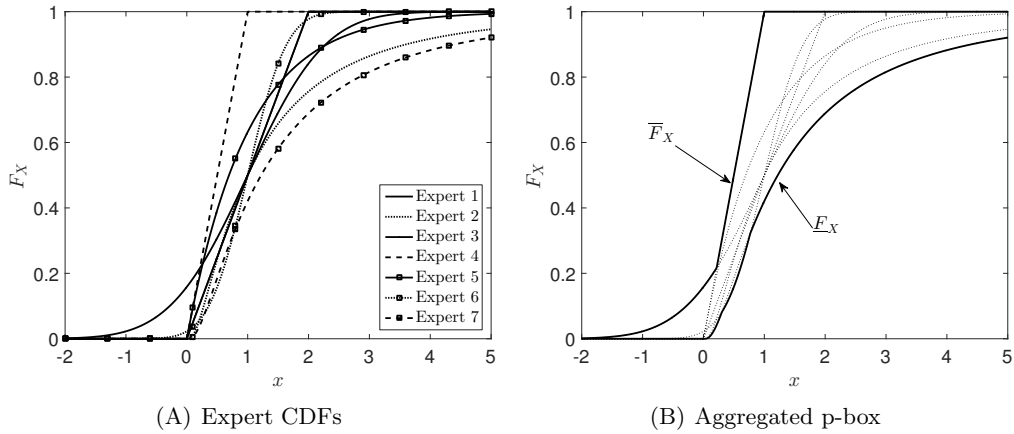

Figure 3: Case #2 – p-box as a combination of expert CDFs

**Case #2(b)** An alternative way to define a p-box is to choose a distribution family and set interval-valued distribution parameters. The p-box is defined by the envelope of the set of distributions as in Case #2(a). The p-box bounds are then found by:

$$\underline{F}_X(x) = \min_{\boldsymbol{\theta} \in \mathcal{D}_{\boldsymbol{\theta}}} F_X(x|\boldsymbol{\theta}), \quad \overline{F}_X(x) = \max_{\boldsymbol{\theta} \in \mathcal{D}_{\boldsymbol{\theta}}} F_X(x|\boldsymbol{\theta}), \quad \forall x \in \mathcal{D}_X, \quad (3)$$

where  $\boldsymbol{\theta}$  is a vector of distribution parameters which are defined in a domain  $\mathcal{D}_{\boldsymbol{\theta}}$  (Ferson et al., 2003; Zhang et al., 2010). Note that in this case, only the bounds are used for further analyses. The information about the distribution family is ignored (as opposed to so-called parametric p-boxes) once  $\underline{F}_X$  and  $\overline{F}_X$  are defined by Eq. (3).

### 3 Propagation of p-boxes

#### 3.1 Computational model

A *computational model* is defined as a deterministic mapping of the  $M$ -dimensional input vector  $\boldsymbol{x}$  to the QoI  $y$  (considered scalar here for the sake of simplicity):

$$\mathcal{M} : \boldsymbol{x} \in \mathcal{D}_X \subset \mathbb{R}^M \rightarrow y = \mathcal{M}(\boldsymbol{x}) \in \mathbb{R}, \quad (4)$$

where  $\boldsymbol{x} = (x_1, \dots, x_M)^\top$ . The computational model is considered a *black box* of which only the input vector  $\boldsymbol{x}$  and the QoI  $y$  are accessible, as it is usual for legacy computer codes that cannot be modified internally for the sake of uncertainty quantification. Due to uncertainties in the input vector  $\boldsymbol{x}$ , the latter is represented by an imprecise random vector  $\boldsymbol{X} = (X_1, \dots, X_M)^\top$  whose components are assumed statistically independent throughout this paper. Each component  $X_i$  is modelled by a p-box, which is propagated through the computational model to an output p-box  $Y$ :

$$Y = \mathcal{M}(\boldsymbol{X}). \quad (5)$$

In the context of p-boxes, the uncertainty propagation boils down to the estimation of the bounds on the CDF of the QoI  $Y$ , namely  $\underline{F}_Y$  and  $\overline{F}_Y$ . In the following sections, new algorithms for propagating p-boxes are proposed and discussed.

#### 3.2 Slicing algorithm

The *slicing algorithm* transforms the propagation of p-boxes into the propagation of a large number of intervals, the propagation of which is a well-established field of research related to constraint optimization algorithms (Moore, 1966; Stolfi and De Figueiredo, 2003; Dong and Shah, 1987). The main steps for applying this algorithm are described in the following:

1. *Discretization*: Discretization methods approximate the p-box by a set of intervals and corresponding probability masses in order to facilitate the uncertainty propagation task. A number of discretization schemes are available in the literature (Tonon, 2004; Zhang et al., 2010). The *outer discretization method* is now briefly reviewed here. Each input p-box is discretized into a number of interval and associated probability masses. For variable  $X_i$ , the interval  $[0, 1]$  is divided into  $n_{X_i}$  subintervals with corresponding thickness  $m_i^{(j)}$  where  $j = 1, \dots, n_{X_i}$  and  $\sum_j m_i^{(j)} = 1$  (Figure 4(B)). Let us denote the lower and upper boundary of these intervals by  $\underline{c}_i^{(j)}$  and  $\bar{c}_i^{(j)}$ , respectively. Given the bounds of the p-box  $[\underline{F}_{X_i}, \bar{F}_{X_i}]$ , the corresponding intervals in  $X_i$  are:

$$\underline{x}_i^{(j)} = \bar{F}_{X_i}^{-1}(\underline{c}_i^{(j)}), \quad \bar{x}_i^{(j)} = \underline{F}_{X_i}^{-1}(\bar{c}_i^{(j)}), \quad (6)$$

for  $j = 1, \dots, n_{X_i}$  and  $i = 1, \dots, M$ . The intervals of interest are then  $[\underline{x}_i^{(j)}, \bar{x}_i^{(j)}]$  and the associated probability masses are  $m_{X_i}^{(j)}$ , which together characterize the p-boxes of the input  $X_i$ .

2. *Interval propagation*: Let  $\mathcal{K}$  be a set of multi-indices defining a combination of intervals of each input parameter  $X_i$ :

$$\mathcal{K} = \{\mathbf{k} = (k_1, \dots, k_M), k_i \in [1, \dots, n_{X_i}], i = 1, \dots, M\}. \quad (7)$$

Let  $\mathcal{D}_{\mathbf{k}}$  be the hyperrectangle defined by:

$$\mathcal{D}_{\mathbf{k}} = [\underline{x}_1^{(k_1)}, \bar{x}_1^{(k_1)}] \times \dots \times [\underline{x}_M^{(k_M)}, \bar{x}_M^{(k_M)}]. \quad (8)$$

For each hyperrectangle  $\mathcal{D}_{\mathbf{k}}$ , two optimization problems are solved to define the associated bounds of the QoI:

$$\underline{y}^{(\mathbf{k})} = \min_{\mathbf{x} \in \mathcal{D}_{\mathbf{k}}} \mathcal{M}(\mathbf{x}), \quad \bar{y}^{(\mathbf{k})} = \max_{\mathbf{x} \in \mathcal{D}_{\mathbf{k}}} \mathcal{M}(\mathbf{x}). \quad (9)$$

The probability mass associated to  $\mathcal{D}_{\mathbf{k}}$  can be computed by:

$$m_Y^{(\mathbf{k})} = m_{X_1}^{(k_1)} \cdot m_{X_2}^{(k_2)} \cdot \dots \cdot m_{X_M}^{(k_M)}. \quad (10)$$

Correspondingly, the p-box of the QoI is eventually characterized by  $n_Y = n_{X_1} \cdot n_{X_2} \cdot \dots \cdot n_{X_M}$  intervals  $[\underline{y}^{(\mathbf{k})}, \bar{y}^{(\mathbf{k})}]$  with associated probability masses given in Eq. (10). Hence,  $2 \cdot n_Y$  optimization algorithms (see Eq. (9)) are required in the  $M$ -dimensional optimization domain in order to propagate the input p-boxes. When  $M$  and  $n_{X_i}$  become large, this quickly becomes intractable due to the large number of optimizations. This problem is

often referred to as the *curse of dimensionality*.

A number of methodologies can be found in the literature to simplify the optimizations, amongst which are the classical interval analysis (Moore, 1966), affine arithmetic (Stolfi and De Figueiredo, 2003) and the vertex method (Dong and Shah, 1987; Dubois et al., 2004). However, these simplifications require restrictive assumptions, such as monotonicity in the computational model, to ensure accuracy. Other optimization algorithms can be applied such as local, derivative-based methods (*e.g.* BFGS algorithm (Byrd et al., 1999)), global methods (*e.g.* genetic algorithms (Goldberg, 1989) and differential evolution algorithms (Storn and Price, 1997; Deng et al., 2013)) and hybrid methods (*i.e.* with a global and local component) for solving directly Eq. (9). They are more accurate in the general case but require extensive computational resources.

3. *Merging*: The result of the previous step is a set of  $n_Y = |\mathcal{K}|$  intervals  $[\underline{y}^{(k)}, \bar{y}^{(k)}]$  and the corresponding probability masses  $m_y^{(k)}$ . The response p-box is then obtained by converting  $\{\bar{y}^{(k)}, m_y^{(k)}\}$  and  $\{\underline{y}^{(k)}, m_y^{(k)}\}$  to weighted empirical CDFs  $\underline{F}_Y$  and  $\bar{F}_Y$  as explained in Eq. (1).

Figure 4 illustrates the main steps of the slicing algorithm on a one-dimensional problem. The bounds of the input p-box are defined by two Gaussian distributions with  $\mu_X = [1.5, 2]$  and  $\sigma_X = [0.7, 1.0]$  (Case #2(b)) (Figure 4(A)). The p-box is discretized with  $n_X = 20$  equally spaced subintervals, *i.e.*  $m^{(j)} = 1/20$  (Figure 4(B)). The computational model is  $y = x/2 + 4$  (Figure 4(C)). Figure 4(D) illustrates the influence of  $n_X$  on the accuracy of the response p-box. It can be seen from this simple example already that the number of discretization points  $n_{X_i}$  is crucial to the accuracy of the response p-box: the approximated response p-box is conservative in the sense that it is wider than the exact response p-box obtained analytically. The larger  $n_{X_i}$  the more accurate the approximated p-box, and at the same time the larger the computational costs. This effect is more pronounced when the input vector is multi-dimensional, as discussed later in Section 5.3.

Note that in Case #1, the intervals might be chosen to represent each expert's opinion. Then, the expert's credibility is equal to the probability mass in uncertainty propagation, *i.e.*  $m^{(j)} = w^{(j)}$ ,  $j = 1, \dots, n_{X_i}$ .

### 3.3 Problem conversion

A disadvantage of the slicing algorithm is the full-factorial design, which leads to a potentially large number of optimizations for high-dimensional problems, namely  $n_Y = |\mathcal{K}| = n_{X_1} \cdot n_{X_2} \cdot \dots \cdot n_{X_M}$ . In order to circumvent the effects of the full factorial approach, the imprecise problem setting is reformulated in this section, as originally proposed by Zhang et al. (2010) and Schöbi and Sudret (2015a).

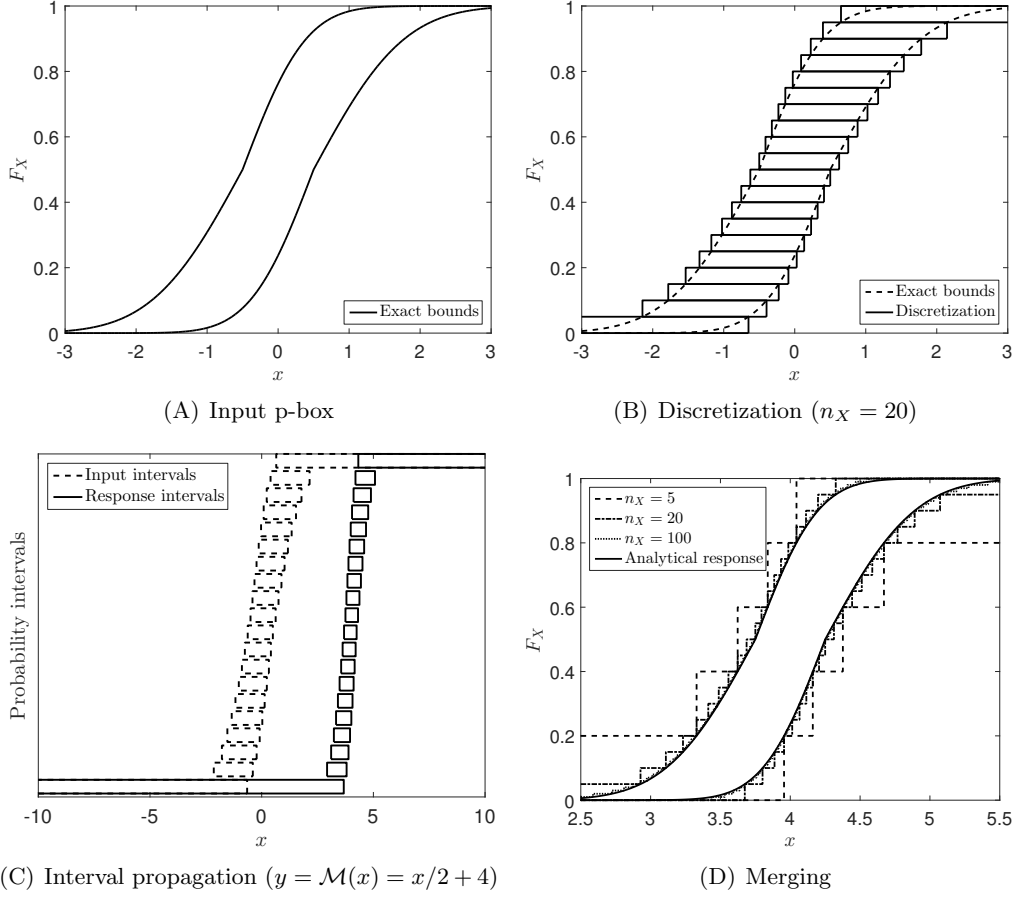

Figure 4: Illustration of the slicing algorithm. The bounds of the input p-box are defined from Gaussian CDFs with interval-valued mean value and standard deviation.  $n_X = 20$  intervals are used.

Consider the random vector  $\mathbf{C}$  made of independent, uniformly distributed variables in the unit-hypercube domain  $\mathcal{D}_{\mathbf{C}} = [0, 1]^M$ . The random variable  $C_i$  shall describe the CDF value of input variable  $X_i$ , *i.e.*  $C_i = F_{X_i}(X_i)$ . Given a p-box in  $X_i$ , each  $c_i \in [0, 1]$  corresponds then to an interval  $[\underline{x}_i, \bar{x}_i]$  in  $\mathcal{D}_{X_i}$  through the inverse CDF of the bounds of the p-box:

$$\underline{x}_i(c_i) = \overline{F}_{X_i}^{-1}(c_i), \quad \bar{x}_i(c_i) = \underline{F}_{X_i}^{-1}(c_i). \quad (11)$$

Note that compared to the previous definition in Eq. (6) where the interval  $[\underline{c}_i, \bar{c}_i]$  is the input argument, Eq. (11) uses a single value  $c_i$ . Eq. (11) can be interpreted from Eq. (6) when setting  $n_{X_i} \rightarrow \infty$  and thus  $m_i^{(j)} \rightarrow 0$  and  $\underline{c}_i \approx \bar{c}_i$ . For a given realization  $\mathbf{c} \in \mathcal{D}_{\mathbf{C}}$ , let us denote by:  $\mathcal{D}_{\mathbf{c}} = [\underline{x}_1(c_1), \bar{x}_1(c_1)] \times \dots \times [\underline{x}_M(c_M), \bar{x}_M(c_M)]$ . As a consequence, two computational models can then be formulated as a function of  $\mathbf{c}$ , equivalent to Eq. (9) (Schöbi and Sudret, 2015a;

Alvarez et al., 2014):

$$\underline{y} = \underline{\mathcal{M}}(\mathbf{c}) = \min_{\mathbf{x} \in \mathcal{D}_c} \mathcal{M}(\mathbf{x}), \quad \bar{y} = \overline{\mathcal{M}}(\mathbf{c}) = \max_{\mathbf{x} \in \mathcal{D}_c} \mathcal{M}(\mathbf{x}). \quad (12)$$

These equations lead to intervals  $[\underline{y}, \bar{y}]$  of the QoI  $Y$ . In analogy with the slicing algorithm (see also Figure 4), the lower bounds of the intervals model the upper boundary curve of  $Y$  (and vice versa). Hence, the lower bound model  $\underline{\mathcal{M}}$  maps  $\mathbf{C}$  to the upper bound  $\bar{Y}$  and the upper bound model  $\overline{\mathcal{M}}$  maps  $\mathbf{C}$  to the lower bound response  $\underline{Y}$ :

$$\underline{Y} = \overline{\mathcal{M}}(\mathbf{C}), \quad \bar{Y} = \underline{\mathcal{M}}(\mathbf{C}), \quad (13)$$

where  $\underline{Y}$  and  $\bar{Y}$  are characterized by the CDF  $\underline{F}_Y$  and  $\bar{F}_Y$  respectively. Eq. (13) splits the propagation of p-boxes into two standard uncertainty propagation problems associated with input random vector  $\mathbf{C}$ .

The probabilistic description of the auxiliary input vector allows for conventional methods of uncertainty propagation such as random sampling (Monte Carlo simulation, Latin-hypercube sampling (McKay et al., 1979)) and low-discrepancy sequences (Sobol' sequence (Sobol', 1967), Halton sequence (Halton, 1960)). These methods are more efficient than the full factorial design approach in Section 3.2, but they are not conservative with respect to the p-box due to the nature of sampling methods, as opposed to the previously discussed slicing algorithm. Large sample sets must then be used to ensure proper accuracy.

## 4 Two-level meta-modelling

### 4.1 Basic idea

Considering the main steps of the uncertainty propagation of p-boxes presented in Section 3.3, there are three main factors contributing to the total computational effort. Firstly, the computational model is evaluated a large number of times due to the optimization methods, in particular when using global optimization methods in the general case when model monotonicity does not hold. Secondly, the number of optimization operations is large considering the sampling-based approach for estimating the bounds of the response p-box, *i.e.*  $\underline{Y}$  and  $\bar{Y}$ . Last but not least, the cost of a single evaluation of the computational model may affect the total costs considerably.

In order to address these three factors, it is proposed in this paper to surrogate the computational model at two levels by polynomial chaos expansions. More specifically, the first-level meta-model approximates the response of  $\mathcal{M}$ , whereas the second-level one approximates the response of the lower and upper model denoted by  $\underline{\mathcal{M}}$  and  $\overline{\mathcal{M}}$ .

## 4.2 Meta-modelling $\underline{\mathcal{M}}$ and $\overline{\mathcal{M}}$

### 4.2.1 Polynomial Chaos Expansions

Assume the output  $Y = \mathcal{M}(\mathbf{C})$  of a computational model  $\mathcal{M}$  with input random vector  $\mathbf{C} \sim f_{\mathbf{C}}$  has a finite second moment, *i.e.*  $\mathbb{E}[Y^2] < +\infty$ . According to (Ghanem and Spanos, 2003),  $Y$  may be cast as the following polynomial chaos expansion:

$$Y = \mathcal{M}(\mathbf{C}) = \sum_{\boldsymbol{\alpha} \in \mathbb{N}^M} a_{\boldsymbol{\alpha}} \psi_{\boldsymbol{\alpha}}(\mathbf{C}), \quad (14)$$

where  $\{\psi_{\boldsymbol{\alpha}}(\mathbf{C}), \boldsymbol{\alpha} \in \mathbb{N}^M\}$  are multivariate orthonormal polynomials in  $\mathbf{C}$  and  $a_{\boldsymbol{\alpha}}$  are coefficients to be computed. Due to the assumption of independence, the joint CDF of  $\mathbf{C}$  is the product of its marginals. Then, for each marginal distribution  $f_{C_i}$  a functional inner product is defined as:

$$\langle \phi_1, \phi_2 \rangle_i = \int_{\mathcal{D}_i} \phi_1(c_i) \phi_2(c_i) f_{C_i}(c_i) dc. \quad (15)$$

Then, a family of orthonormal polynomials  $\{\psi_j^{(i)}, j \in \mathbb{N}\}$  can be built for each input variable  $C_i$  that satisfies:

$$\langle \psi_j^{(i)}, \psi_k^{(i)} \rangle = \int_{\mathcal{D}_{C_i}} \psi_j^{(i)}(c) \psi_k^{(i)}(c) f_{C_i}(c) dc = \delta_{jk}, \quad (16)$$

where  $\delta_{jk} = 1$  for  $j = k$  and  $\delta_{jk} = 0$  otherwise. In the present case of uniform random variables in  $C_i$ , Legendre polynomials forms the family of orthonormal polynomials. For other orthogonal polynomial function families, the reader is referred to *e.g.* Sudret (2007). The multivariate polynomials (used in Eq. (14)) are finally composed of the univariate polynomials by tensor product:

$$\psi_{\boldsymbol{\alpha}}(\mathbf{C}) = \prod_{i=1}^M \psi_{\alpha_i}^{(i)}(C_i). \quad (17)$$

### 4.2.2 Non-intrusive PCE

In practice, it is not feasible to handle infinite series as presented in Eq. (14). Hence, the infinite set of multivariate orthonormal polynomials is truncated, such that Eq. (14) transforms to:

$$Y \approx Y^{(P)} \stackrel{\text{def}}{=} \mathcal{M}^{(P)}(\mathbf{C}) = \sum_{\boldsymbol{\alpha} \in \mathcal{A}} a_{\boldsymbol{\alpha}} \psi_{\boldsymbol{\alpha}}(\mathbf{C}), \quad (18)$$

where  $\mathcal{A} \subset \mathbb{N}^M$  is a finite set of multi-indices and  $P$  denotes its cardinality ( $P = |\mathcal{A}|$ ). A number of truncation schemes have been proposed in the literature, amongst which is the *hyperbolic truncation set* (Blatman and Sudret, 2010), which is based on the q-norm:

$$\mathcal{A}_q^{M,p} = \{\boldsymbol{\alpha} \in \mathbb{N}^M : \|\boldsymbol{\alpha}\|_q \leq p\}, \quad (19)$$

$$\|\boldsymbol{\alpha}\|_q = \left( \sum_{i=1}^M \alpha_i^q \right)^{1/q}, \quad (20)$$

where  $0 < q \leq 1$  is a user-defined parameter and  $p$  is the maximal total degree of the polynomials. A small value of  $q$  leads to a smaller number of high-rank polynomials. When  $q$  tends to zero, only univariate polynomials are left in the set of polynomials. Using  $\mathcal{A}_q^{M,p}$  then, Eq. (18) transforms to:

$$Y \approx Y^{(P)} \stackrel{\text{def}}{=} \mathcal{M}^{(P)}(\mathbf{C}) = \sum_{\boldsymbol{\alpha} \in \mathcal{A}_q^{M,p}} a_{\boldsymbol{\alpha}} \psi_{\boldsymbol{\alpha}}(\mathbf{C}), \quad P = |\mathcal{A}_q^{M,p}|. \quad (21)$$

Finally, the coefficients  $a_{\boldsymbol{\alpha}}$  are computed. Assume that the variable  $Y$  in Eq. (21) is replaced by  $\underline{Y}$  and  $\overline{Y}$  for the two computational models in Eq. (12). Due to interpreting  $\mathcal{M}$  and thus  $\underline{\mathcal{M}}$  and  $\overline{\mathcal{M}}$  as black-box models, only *non-intrusive* training algorithms are presented here to compute the PCE coefficients. One strategy is least-square analysis, as originally introduced by Berveiller et al. (2006). Consider a set of  $N$  samples of the input vector  $\boldsymbol{\mathfrak{c}} = \{\boldsymbol{\mathfrak{c}}^{(1)}, \dots, \boldsymbol{\mathfrak{c}}^{(N)}\}$ , called *experimental design*, and the corresponding responses of the two computational models:

$$\begin{aligned} \underline{\mathcal{Y}} &= \left\{ \underline{\mathcal{Y}}^{(1)} = \overline{\mathcal{M}}(\boldsymbol{\mathfrak{c}}^{(1)}), \dots, \underline{\mathcal{Y}}^{(N)} = \overline{\mathcal{M}}(\boldsymbol{\mathfrak{c}}^{(N)}) \right\}, \\ \overline{\mathcal{Y}} &= \left\{ \overline{\mathcal{Y}}^{(1)} = \underline{\mathcal{M}}(\boldsymbol{\mathfrak{c}}^{(1)}), \dots, \overline{\mathcal{Y}}^{(N)} = \underline{\mathcal{M}}(\boldsymbol{\mathfrak{c}}^{(N)}) \right\}. \end{aligned}$$

The set of coefficients can be computed through the solution of the least squares problem:

$$\underline{\mathbf{a}}^* = \arg \min_{\mathbf{a} \in \mathbb{R}^P} \frac{1}{N} \sum_{i=1}^N \left( \underline{\mathcal{Y}}^{(i)} - \sum_{\boldsymbol{\alpha} \in \mathcal{A}_q^{M,p}} a_{\boldsymbol{\alpha}} \psi_{\boldsymbol{\alpha}}(\boldsymbol{\mathfrak{c}}^{(i)}) \right)^2, \quad (22)$$

$$\overline{\mathbf{a}}^* = \arg \min_{\mathbf{a} \in \mathbb{R}^P} \frac{1}{N} \sum_{i=1}^N \left( \overline{\mathcal{Y}}^{(i)} - \sum_{\boldsymbol{\alpha} \in \mathcal{A}_q^{M,p}} a_{\boldsymbol{\alpha}} \psi_{\boldsymbol{\alpha}}(\boldsymbol{\mathfrak{c}}^{(i)}) \right)^2. \quad (23)$$

Finally, the two PCE models for the bounds of the response p-box are:

$$\underline{Y} \approx \overline{\mathcal{M}}^{(P)}(\mathbf{C}) = \sum_{\boldsymbol{\alpha} \in \mathcal{A}_q^{M,p}} \underline{a}_{\boldsymbol{\alpha}}^* \psi_{\boldsymbol{\alpha}}(\mathbf{C}), \quad (24)$$

$$\overline{Y} \approx \underline{\mathcal{M}}^{(P)}(\mathbf{C}) = \sum_{\boldsymbol{\alpha} \in \mathcal{A}_q^{M,p}} \overline{a}_{\boldsymbol{\alpha}}^* \psi_{\boldsymbol{\alpha}}(\mathbf{C}). \quad (25)$$

### 4.2.3 Sparse PCE

The efficiency of the meta-modelling algorithm depends on the choice of the set of polynomials  $\mathcal{A}^{M,p}$  or the hyperbolic truncation set  $\mathcal{A}_q^{M,p}$ , which decrease drastically the number of unknowns of the problem while ensuring that polynomials up to degree  $p$  in each variable are considered.



In high-dimensional problems, however, such truncation schemes are not efficient enough.

A complementary approach is to select the polynomials out of a candidate set which are most influential to the system response. Different selection algorithms have been presented in the literature, such as *least absolute shrinkage operator* (LASSO) (Tibshirani, 1996), *least angle regression* (LAR) (Efron et al., 2004; Blatman and Sudret, 2011), and *compressive sensing* (Sargsyan et al., 2014). In this paper, sparse PCE meta-models are trained with LAR which has also been applied previously in Schöbi et al. (2015, 2016). Note that the resulting  $\mathcal{A}$  is likely to be different for  $\underline{Y}$  and  $\bar{Y}$ , because of the selection algorithm.

### 4.3 Meta-modelling $\mathcal{M}$

#### 4.3.1 Condensation of p-boxes

The expensive-to-evaluate computational model  $\mathcal{M}$  may itself be approximated with a sparse PCE model in view of solving the global optimization problems defining  $\underline{\mathcal{M}}$  and  $\bar{\mathcal{M}}$ . The input of  $\mathcal{M}$  is a p-box in  $M$  dimensions in the problems on consideration. However, in order to apply a sparse PCE model, a probabilistic input vector is required. Hence, auxiliary input variables  $\tilde{X}_i$  are defined for the sole purpose of meta-modelling  $\mathcal{M}$ . The auxiliary input variables should represent the probability mass in the input p-boxes in an appropriate manner. In other words, the auxiliary distributions aim at "summarizing" the p-box, such as fulfilling  $\underline{F}_X(x) < F_{\tilde{X}}(x) < \bar{F}_X(x)$ ,  $\forall x \in \mathcal{D}_X$ . This is the so-called *condensation* phase. As p-boxes are defined on interval-valued CDFs, a number of distributions can be proposed, *i.e.* there is no unique choice.

Generally speaking, for Case #1 (Section 2.3.1) and bounded p-boxes, it is proposed to use a uniform distribution between the minimum and maximum value of the p-boxes, *i.e.* :

$$\tilde{X}_i \sim \mathcal{U} \left( \min_{j=1, \dots, n_E} \left( x_i^{(j)} \right), \max_{j=1, \dots, n_E} \left( \bar{x}_i^{(j)} \right) \right), \quad (26)$$

where  $\left[ x_i^{(j)}, \bar{x}_i^{(j)} \right]$  is the interval on variable  $i$  corresponding to the  $j$ -th expert. For Case #2 (Section 2.3.2) and generally for unbounded p-boxes, it is proposed to define the CDF of  $\tilde{X}_i$  as an average curve of its input p-boxes:

$$\tilde{F}_{X_i}(x_i) = \frac{1}{2} \left( \underline{F}_{X_i}(x_i) + \bar{F}_{X_i}(x_i) \right). \quad (27)$$

In both cases, the proposed auxiliary input distribution covers the p-box in the areas where most of the probability mass is located and is therefore suitable to represent the p-box in a sparse PCE model. However, in terms of accuracy of the meta-model, different distributions might be more suitable than the one in Eq. (27) (see also Section 5 for a detailed discussion on this aspect).

### 4.3.2 Arbitrary input PCE

Having defined an auxiliary input vector  $\tilde{\mathbf{X}}$ , it can be propagated through the computational model. The corresponding uncertainty propagation problem then reads:

$$\tilde{Y} = \mathcal{M}(\tilde{\mathbf{X}}), \quad (28)$$

and the corresponding approximation with PCE:

$$\tilde{Y} \approx \mathcal{M}^{(P)}(\tilde{\mathbf{X}}) = \sum_{\alpha \in \mathcal{A}_q^{M,p}} \tilde{a}_\alpha \psi_\alpha(\tilde{\mathbf{X}}). \quad (29)$$

This PCE model can be trained by pure vanilla least-square analysis, least-angle regression or any other non-intrusive technique (see Section 4.2).

An important aspect here is when  $\tilde{X}_i$  has an arbitrary CDF shape for which it might not be trivial to define a set of orthogonal polynomials (Gautschi, 2004). Ahlfeld et al. (2016) and Dey et al. (2016) discuss the use of so-called *arbitrary PCE*, which are based on arbitrarily shaped input distributions. An alternative way is to formalize an isoprobabilistic transform from variables  $\tilde{X}_i$  to  $Z_i$  for which a suitable set of orthogonal polynomials is known already. The mapping from one distribution to the other is denoted by  $T : Z_i = T(\tilde{X}_i)$ . A point  $x_i \sim \tilde{X}_i$  can be mapped to  $Z_i$  as  $z_i = F_{Z_i}^{-1}(F_{\tilde{X}_i}(x_i))$ . When  $\tilde{X}_i$  and  $Z_i$  are chosen in a smart way, the transform  $T$  shall be nearly linear. The PCE model can then be written as:

$$\tilde{Y} \approx \mathcal{M}^{(P)}(\tilde{\mathbf{X}}) = \sum_{\alpha \in \mathcal{A}^{M,p}} \tilde{a}_\alpha \psi_\alpha(T(\tilde{\mathbf{X}})), \quad (30)$$

where the set of  $\psi_\alpha$ 's are orthogonal with respect to the vector  $\mathbf{Z} = T(\tilde{\mathbf{X}})$ .

## 4.4 Aggregation of two levels of meta-modelling

### 4.4.1 Framework of meta-models

Figure 5 summarizes the two levels of meta-modelling presented previously. A first level of sparse PCE approximates the computational model  $\mathcal{M}$  on the basis of the auxiliary input vector  $\tilde{\mathbf{X}}$ , which is itself defined according to the type of input p-box considered. This results in the meta-model  $\mathcal{M}^{(P)}$ . Then, the problem is divided into the estimation of  $\underline{Y}$  and  $\bar{Y}$  by Eq. (13). They are obtained by approximating  $\bar{\mathcal{M}}$  and  $\underline{\mathcal{M}}$ , respectively, via sparse PCE and the probabilistic input vector  $\mathbf{C}$ , which defines the second level of the two-level approach.

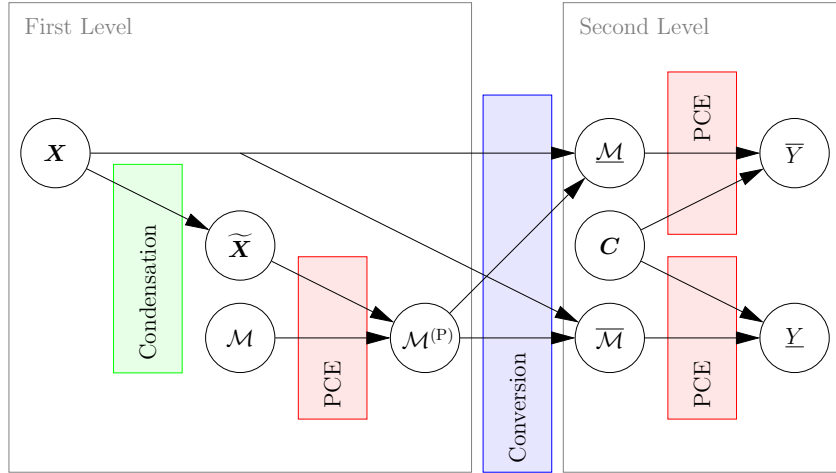

Figure 5: Two-level meta-modelling for the propagation of p-boxes – definition and connection of the two levels

#### 4.4.2 Case #1

In the case of bounded p-boxes, *i.e.* when the support of the boundary CDFs  $\underline{F}_{X_i}$  and  $\overline{F}_{X_i}$  are compact, the methods can be applied as described in the previous sections. For the first level of meta-modelling, bounded variables  $\widetilde{\mathbf{X}}$  are used so that the response  $\widetilde{Y}$  may be approximated efficiently. On the second-level meta-model however, the response  $\underline{Y} = \overline{\mathcal{M}}(\mathbf{C})$  and  $\overline{Y} = \underline{\mathcal{M}}(\mathbf{C})$  are non-smooth due to the stairs-like input p-boxes  $X_i$  originating in a finite set of expert intervals. The effect of this non-smoothness is investigated further in the example in Section 5.2. However, when the number of expert intervals and the number of variables are small, the second-level meta-model may be redundant, as the full factorial design approach is tractable (*i.e.*  $n_Y$  small). In the other extreme case of large number of variables and intervals, the response boundary curves lose the stairs-shaped nature of the CDF curves due to the large number of response intervals (*i.e.*  $n_Y$  large).

#### 4.4.3 Case #2

In the case of unbounded p-boxes, the uncertainty propagation analysis, as proposed above, may become inefficient due to the usage of a bounded  $\mathbf{C}$  on the second-level meta-model. In general, it is not advised to model an unbounded variable  $X$  by a bounded variable  $Y$  and the corresponding isoprobabilistic transform, due to the highly non-linear functional form of this transform (Schöbi and Sudret, 2016, 2015a).

In order to reduce the effect of the non-linear transform and to ensure fast convergence, the second-level meta-model is trained in the auxiliary input domain  $\widetilde{\mathbf{X}}$  as previously discussed in Schöbi and Sudret (2015a). An isoprobabilistic transform can be formulated such that  $\mathbf{C} =$

$T(\widetilde{\mathbf{X}})$ . The corresponding models are:

$$\underline{Y} = \overline{\mathcal{M}}\left(T(\widetilde{\mathbf{X}})\right), \quad \overline{Y} = \underline{\mathcal{M}}\left(T(\widetilde{\mathbf{X}})\right). \quad (31)$$

These two computational models can be approximated using sparse PCE meta-models.

#### 4.4.4 Special case: monotone computational models

When the computational model  $\mathcal{M}$  is known to be monotonic with respect to all variables  $X_i$ , then the constraint optimization in Eq. (12) reduces to the analysis of the corners of the search domain. Hence, uncertainty propagation of p-boxes simplifies to the propagation of the bounds of the input p-boxes. It follows that the meta-modelling of  $\underline{\mathcal{M}}$  and  $\overline{\mathcal{M}}$  becomes out of scope.  $\underline{Y}$  and  $\overline{Y}$  can be directly estimated based on  $\mathcal{M}^{(P)}$  and the bounds of each  $X_i$ .

## 5 Applications

### 5.1 Reference solution

In the following application examples, the proposed two-level meta-modelling algorithm is compared to a reference solution. The reference solution is obtained by (i) using the original computational model  $\mathcal{M}$  (no first-level meta-model  $\mathcal{M}^{(P)}(\widetilde{\mathbf{X}})$ ) and by (ii) using a large number of points ( $n = 10^6$ ) in the prediction of  $\underline{Y}$  and  $\overline{Y}$ .

### 5.2 Rosenbrock function

#### 5.2.1 Problem definition

The Rosenbrock function is a benchmark analytical (polynomial) function with two input variables used for optimization (Rosenbrock, 1960):

$$y = f_1(\mathbf{x}) = 100(x_2 - x_1^2)^2 + (1 - x_1)^2. \quad (32)$$

Here, we model parameters  $x_1$  and  $x_2$  by two independent p-boxes  $X_1$  and  $X_2$ .

Figure 6(A) shows the response surface of  $f_1$  as a function of  $x_1$  and  $x_2$ . The response is non-monotone around the origin of the input space and has a global minimum of  $y = 0$  at  $\{x_1 = 1, x_2 = 1\}$ . Thus, the QoI  $Y$  is bounded on one side to the domain  $\mathcal{D}_Y = [0, \infty]$ .

**Case #1** The p-boxes based on the opinions of seven experts are illustrated in Figure 6(B). The solid lines mark the p-box for  $X_1$ , whereas the dashed lines mark the p-box for  $X_2$ . It can be

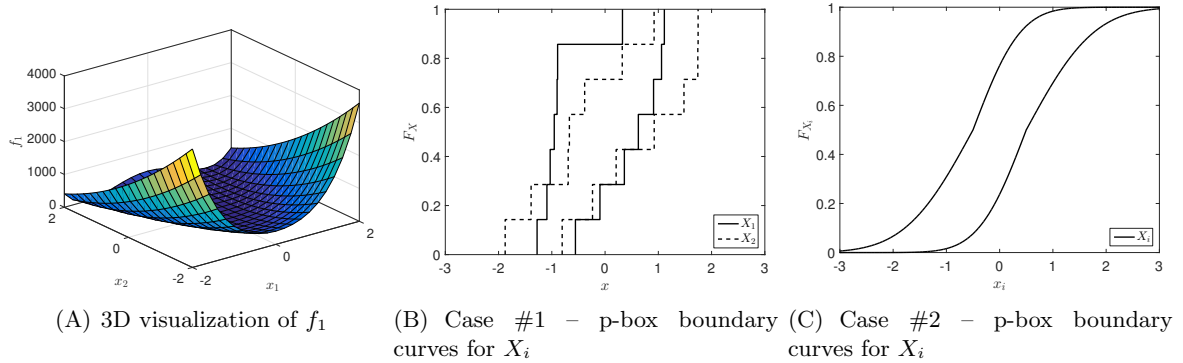

Figure 6: Rosenbrock function – Problem setup

seen that the credibility of the experts is uniform due to the constant vertical step size between the vertical plateaus of the boundary CDFs, and that the p-boxes are bounded on both sides.

**Case #2** The bounds of the two input variables  $X_i$  are defined as follows (Case #2(b)):

$$\underline{F}_{X_i}(x_i) = \min_{\mu \in [\underline{\mu}, \bar{\mu}], \sigma \in [\underline{\sigma}, \bar{\sigma}]} F_{\mathcal{N}}(x_i | \mu, \sigma),$$

$$\bar{F}_{X_i}(x_i) = \max_{\mu \in [\underline{\mu}, \bar{\mu}], \sigma \in [\underline{\sigma}, \bar{\sigma}]} F_{\mathcal{N}}(x_i | \mu, \sigma),$$

where  $F_{\mathcal{N}}(x | \mu, \sigma)$  is a Gaussian CDF with mean value  $\mu$  and standard deviation  $\sigma$ . In order to generate a p-box, the distribution parameters are given in intervals:  $\mu \in [\underline{\mu}, \bar{\mu}] = [-0.5, 0.5]$  and  $\sigma \in [\underline{\sigma}, \bar{\sigma}] = [0.7, 1.0]$ . Figure 6(C) shows the boundary curves of the p-boxes for  $X_i$ ,  $i = 1, 2$ .

## 5.2.2 Analysis

The two-level meta-modelling approach has been implemented taking advantage of the MATLAB-based uncertainty quantification framework UQLAB (Marelli and Sudret, 2014, 2015). The sparse PCE meta-models were calibrated with Latin-hypercube experimental designs (McKay et al., 1979) and appropriate sets of orthonormal polynomials (Legendre polynomials for bounded variables and Hermite polynomials for unbounded variables). The set of polynomials is determined by a degree-adaptive LAR of which the maximum total polynomial degree is set to 30 and the parameter for the hyperbolic truncation set  $\mathcal{A}_q^{M,p}$  is set to  $q = 0.75$ . The number of samples in the experimental design is denoted by  $N_1$  and  $N_2$  for constructing the meta-models of  $\mathcal{M}$  and  $\{\underline{\mathcal{M}}, \bar{\mathcal{M}}\}$ , respectively. In order to achieve a statistical significance, the uncertainty propagation analyses are replicated 50 times with different LHS experimental designs.

For Case #1, the auxiliary input variables are defined as in Eq. (26), whereas for Case #2, the auxiliary input variables are defined as  $F_{\tilde{X}_i} = F_{\mathcal{N}}(x|0, 1)$ . Note that for Case #2, both levels

of meta-models are trained in the same auxiliary domain, *i.e.*  $\mathcal{D}_{\tilde{\mathbf{x}}}$ .

The performance of the proposed two-level meta-modelling approach is measured in terms of the goodness-of-fit of the meta-models in the two levels of the approach. The accuracy of the meta-models is measured by the *relative generalization error*, which is defined as follows:

$$err_{\text{gen}}[Y] = \frac{\mathbb{E}[(Y - Y^{(P)})^2]}{\text{Var}[Y]}, \quad (33)$$

where  $Y$  is the true response variable and  $Y^{(P)}$  is its meta-model response value. An estimate of the relative generalization error is computed by a large sample set  $\{\mathbf{x}_i, i = 1, \dots, 10^6\}$ , called validation set, as follows:

$$\widehat{err}_{\text{gen}}[Y] \stackrel{\text{def}}{=} \frac{\sum_i (y_i - y_i^{(P)})^2}{\sum_i (y_i - \mu_Y)^2}, \quad (34)$$

where  $y_i$  is the exact value of response of the computational model,  $y_i^{(P)}$  is the prediction value based on the meta-model, and  $\mu_Y$  is the estimated mean value of the response variable  $Y$ .

A second measure for the accuracy of the proposed two-level approach is the comparison of the true and the meta-modelled p-boxes for the QoI  $Y$ . In particular, the graphical comparison of the boundary CDFs  $\underline{Y}$  and  $\overline{Y}$  is made in the typical variable-CDF plot and shows the quality of the proposed approximations.

### 5.2.3 Results

**Case #1** The polynomial form of the Rosenbrock function can be modelled exactly with the polynomial-based PCE models. Hence, the first-level meta-model does not introduce any approximation in this application example.

The reference solution for the second-level models  $\underline{\mathcal{M}}$  and  $\overline{\mathcal{M}}$  is obtained by propagating all possible combinations of input intervals, *i.e.*  $n_{E,X_1} \cdot n_{E,X_2} = 7 \cdot 7 = 49$  intervals. This results in stairs-shaped boundary curves for the response p-box. These shapes are difficult to model with polynomials, which generally define smooth functions. Hence, the accuracy of the second-level meta-models is low, as see in Figure 7, which summarizes the relative generalization error for the two second-level meta-models:  $\overline{\mathcal{M}}^{(P)}$  and  $\underline{\mathcal{M}}^{(P)}$ . In fact, it requires  $N_2 = 1,000$  samples to achieve an accuracy of  $\widehat{err}_{\text{gen}} \approx 0.05$  due to the shape of the input p-boxes. In other words, the continuous input vector  $\mathbf{C}$  is mapped onto 49 values in the response variables  $\underline{Y}$  and  $\overline{Y}$ .

The explanation for this convergence behaviour is illustrated in Figure 8, which shows the response surface of the computational models as a function of the input random variables. The computational model  $\mathcal{M}$ , which is the basis for the first-level meta-model, shows smooth contour lines (see Figure 8(A)), whereas  $\underline{\mathcal{M}}$  and  $\overline{\mathcal{M}}$  show plateau-shaped response surfaces (see Figure 8(B) and 8(C)) with constant response values within each plateau. A total of  $7 \times 7 = 49$

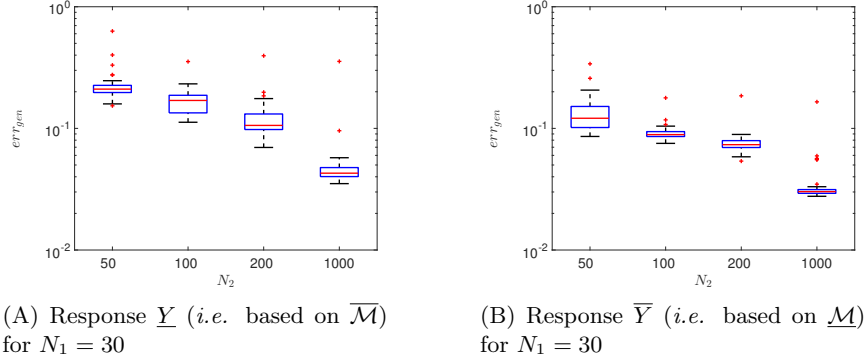

Figure 7: Rosenbrock function – Case #1 – relative generalization error as a function of  $N_1$ ,  $N_2$  and based on 50 replications of the same analysis

distinct plateaus can be identified corresponding to the 49 possible combinations of input intervals defined by the expert opinions. Instead of training second-level meta-models, the original (small) number of input intervals, *i.e.* the intervals given by the experts, may be propagated directly to estimate the bounds of the response p-box. In other words, the slicing algorithm may be applied of the second-level of the uncertainty analysis, due to the low number of response intervals, *i.e.*  $|\mathcal{K}| = 49$ .

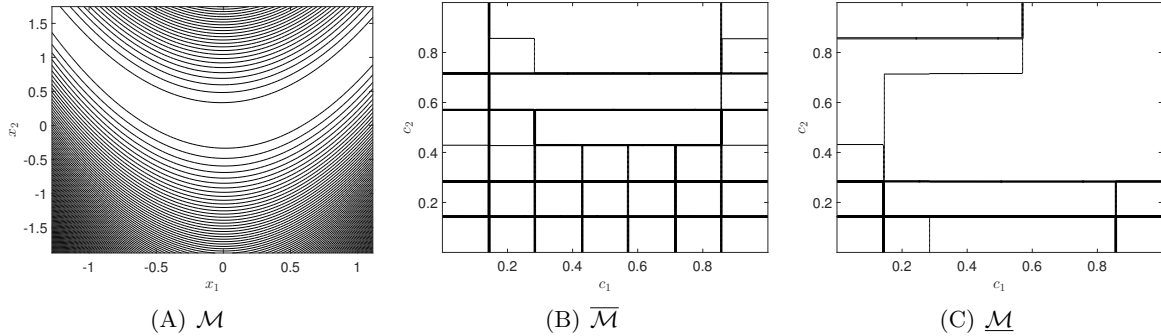

Figure 8: Rosenbrock function – Case #1 – shape of the response surfaces

When comparing the boundary curves of the response p-box, however, results show that the proposed approach provides accurate (although smooth) approximations of the response p-box boundaries. The exact boundary curves of the p-box of  $Y$  are shown in Figure 9, where the distinct values are clearly visible in the stairs-shaped CDF curves. For comparison, the boundary curves of the two-level approach are presented for a single run with  $N_1 = 50$  and  $N_2 = 200$ . For this run, the relative generalization error are  $\widehat{err}_{\text{gen}}[\overline{Y}] = 1.14 \cdot 10^{-1}$  and  $\widehat{err}_{\text{gen}}[\underline{Y}] = 8.76 \cdot 10^{-2}$ . The PCE-based CDFs are not capable of reproducing the stairs-like functions but still follow the exact boundary curves sufficiently accurately for visual comparison. This explains the large relative generalization errors in the second-level meta-models.

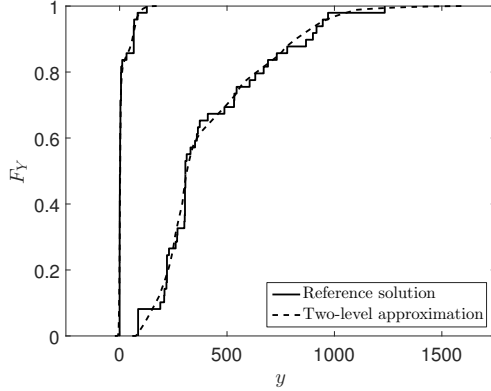

Figure 9: Rosenbrock function – Case #1 – Response p-boxes  $Y \in [\underline{Y}, \overline{Y}]$ : reference solution ( $n = 7 \cdot 7 = 49$ ) versus two-level approach ( $N_1 = 50, N_2 = 200$ )

**Case #2** Analogously to Case #1, the performance of the second-level meta-models is shown in the two Figures 10(A) and 10(B) for  $\underline{Y}$  and  $\overline{Y}$ , respectively, using  $N_1 = 100$  and  $N_2 = \{50, 100, 200, 1000\}$ . As expected, the relative generalization error becomes smaller with larger experimental design, *i.e.* larger  $N_2$ . Interestingly however, the values are considerably different for  $\underline{Y}$  and  $\overline{Y}$ , due to the shape of the response function  $\overline{\mathcal{M}}$  and  $\underline{\mathcal{M}}$ , respectively.

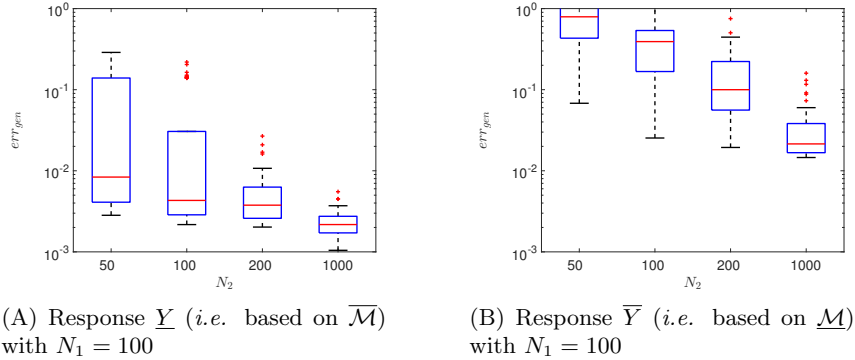

Figure 10: Rosenbrock function – Case #2 – relative generalization error as a function of  $N_1, N_2$  and based on 50 replications of the same analysis

Figure 11 shows the response surface for  $\mathcal{M}$ ,  $\underline{\mathcal{M}}$  and  $\overline{\mathcal{M}}$ , respectively, as a function of the auxiliary input variables  $\widetilde{\mathbf{X}}$ . Comparing the three sets of contour lines in Figure 11, the response surface of  $\underline{\mathcal{M}}$  has a large plateau around the origin and steep value increases around the plateau. This behaviour is difficult to model with polynomials, which results in a lower accuracy seen in Figure 10(B).

Finally, the resulting boundary curves of the p-box of  $Y$  are shown in Figure 12. The reference solution was computed with the exact computational model on the first level of the algorithm and  $n = 10^6$  samples on the second level. The effect of the identified plateau in  $\underline{\mathcal{M}}$



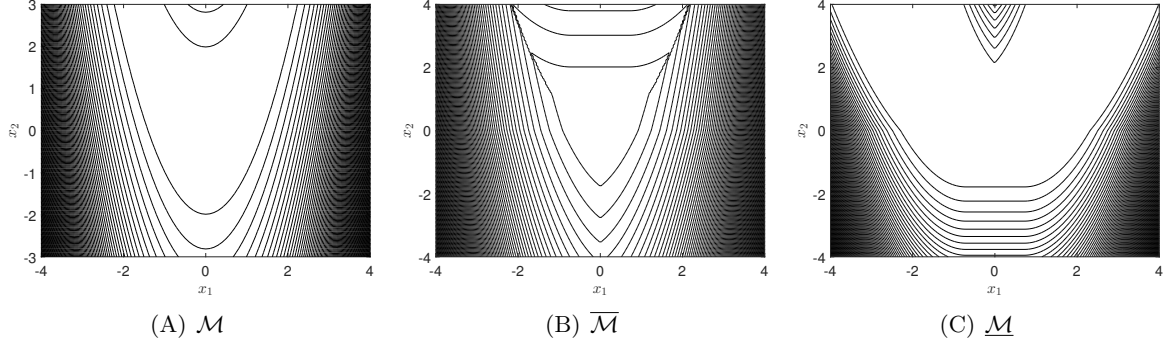

Figure 11: Rosenbrock function – shape of the response surfaces of  $\underline{M}$  and  $\overline{M}$  as a function of  $\widetilde{\mathbf{X}}$

in Figure 11(C) is that a large quantile of  $\overline{Y}$  is close to  $y = 0$  (see Figure 12). Additionally, a single realization of those boundary curves is drawn in Figure 12 for the case of  $N_1 = 100$  and  $N_2 = 200$ . The corresponding relative generalization error for  $\underline{Y}$  and  $\overline{Y}$  are  $\widehat{err}_{\text{gen}}[\underline{Y}] = 3.43 \cdot 10^{-1}$  and  $\widehat{err}_{\text{gen}}[\overline{Y}] = 5.66 \cdot 10^{-3}$ , respectively. Despite the relatively large values of the relative generalization error of the second-level meta-model, the bounds of the response p-box are modelled accurately.

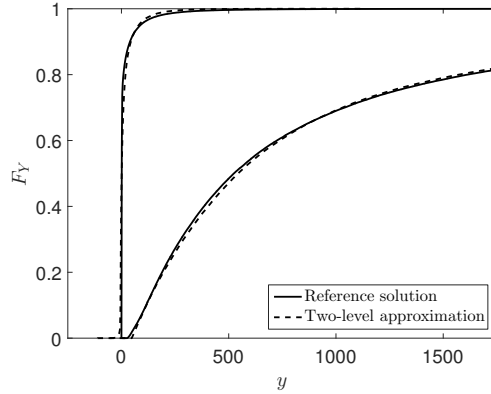

Figure 12: Rosenbrock function – Case #2 – Response p-boxes  $Y \in [\underline{Y}, \overline{Y}]$ : reference solution ( $n = 10^6$ ) versus two-level approach ( $N_1 = 100$ ,  $N_2 = 200$ )

### 5.3 Two-degree-of-freedom damped oscillator

#### 5.3.1 Problem definition

Consider the two-degree-of-freedom (2-dof) damped oscillator subjected to white noise excitation  $S(t)$ , sketched in Figure 13. The subscripts  $p$  and  $s$  refer to the primary and secondary mass, respectively. The QoI is the force acting on the secondary spring. According to Der Kiureghian and de Stefano (1990) and Dubourg et al. (2013), the peak force  $P_s$  in the secondary spring can

be computed by:

$$P_s = 3 k_s \sqrt{\mathbb{E}_S [x_s^2]}, \quad \text{where} \quad \mathbb{E}_S [x_s^2] = \pi \frac{S_0}{4\zeta_s \omega_s^3} \frac{\zeta_a \zeta_s}{\zeta_p \zeta_s (4\zeta_a^2 + \xi^2) + \gamma \zeta_a^2} \frac{(\zeta_p \omega_p^3 + \zeta_s \omega_s^3) \omega_p}{4\zeta_a \omega_a^4}, \quad (35)$$

where  $\omega_p = \sqrt{k_p/m_p}$  and  $\omega_s = \sqrt{k_s/m_s}$  are the natural frequencies,  $\gamma = m_s/m_p$ ,  $\omega_a = (\omega_p + \omega_s)/2$ ,  $\zeta_a = (\zeta_p + \zeta_s)/2$ ,  $\xi = (\omega_p - \omega_s)/\omega_a$ ,  $m$  is the mass,  $k_p$  and  $k_s$  are the spring stiffnesses, and  $\zeta$  is the damping ratio. The set of input parameters  $\mathbf{x} = \{m_p, m_s, k_p, k_s, \zeta_p, \zeta_s, S_0\}$  are considered statistically independent. The parameters  $\{m_p, m_s, k_p, k_s, S_0\}$  are well-known (*i.e.* negligible epistemic uncertainty) and defined as independent lognormal variables, with properties summarized in Table 1. Each lognormal variable is characterized by a mean value and a coefficient of variation (CoV). Assume that the properties of the damping ratios  $\{\zeta_p, \zeta_s\}$  are investigated through a survey among experts because of the highly uncertain nature of damping in dynamic systems. Analogously to Case #1, each expert provides an interval of values for the two damping ratios. Eleven and ten intervals have been collected for  $\zeta_p$  and  $\zeta_s$ , respectively. The aggregated p-boxes are shown in Figure 14 assuming equal credibility among the experts.

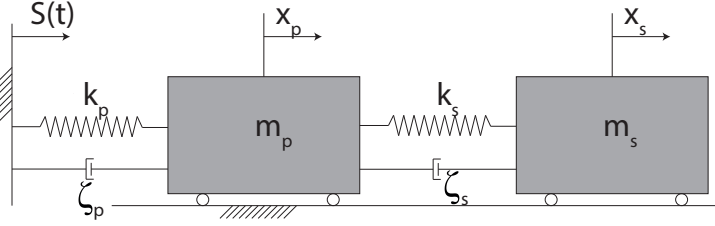

Figure 13: Sketch of the 2-dof damped oscillator

Table 1: 2-dof damped oscillator – probabilistic input variables

Variable	Distribution	Mean	CoV
$m_p$	Lognormal	1.50	10%
$m_s$	Lognormal	0.01	10%
$k_p$	Lognormal	1.00	20%
$k_s$	Lognormal	0.05	20%
$S_0$	Lognormal	100	10%

### 5.3.2 Analysis

The settings for the two-level meta-modelling approach are kept the same as in the Rosenbrock function example in Section 5.2. Sparse PCE is trained with a candidate basis of maximum total polynomial degree equal to 20 and hyperbolic truncation sets with  $q = 0.75$ . The auxiliary variables  $\tilde{X}_i$  for  $\zeta_p$  and  $\zeta_s$  are defined as in Eq. (26). In order to analyse the influence of the sample

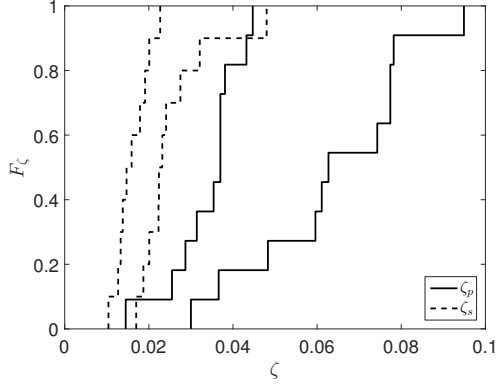

Figure 14: 2-dof damped oscillator – aggregated p-boxes of the damping ratio (10 expert opinions of equal credibility)

size,  $N_1$  and  $N_2$  are varied in  $\{100, 200, 300, \rightarrow \infty\}$  and  $\{100, 200, 300, 1000\}$ , respectively. Note that  $N_1 \rightarrow \infty$  denotes a case where the first-level meta-model is not applied; instead, the true model  $\mathcal{M}$  is used. 50 independent analyses with different experimental designs are conducted to assess the statistical significance of the QoI.

### 5.3.3 Results

The results for the relative generalization error are summarized in Table 2. As expected, increasing  $N_1$  reduces the relative generalization error of the first-level meta-model (see  $\widehat{err}_{\text{gen}}[\tilde{P}_s]$ ). However, the accuracy of the second-level meta-model is lower than the first-level meta-model, and does not depend significantly on the accuracy of the first-level meta-model. Thus, the error is dominated by the second-level meta-modelling operation. The explanation lies in the p-boxes of the damping coefficients  $\zeta_p$  and  $\zeta_s$ , which have stairs-shaped boundary CDF curves. Analogously to Case #1 in the Rosenbrock function (Section 5.2), this shape reduces the accuracy of the meta-model on the second level.

Although the two-level meta-models are fairly accurate, as discussed previously, the bounds of the resulting p-box is computed accurately, as seen in Figure 15. A reference solution based on  $n = 10^5$  Monte Carlo samples is compared to the two-level meta-modelling approach with  $N_1 = 300$  and  $N_2 = 100$ . The boundary curves ( $\underline{F}_{P_s}$  and  $\overline{F}_{P_s}$ ) obtained from the proposed approach are almost superimposed with the reference ones.

### 5.3.4 Comparison to slicing algorithm

In order to illustrate the curse of dimensionality, the slicing algorithm is applied on the second level of the two-level approach replacing the calibration of the meta-models  $\underline{\mathcal{M}}^{(P)}$  and  $\overline{\mathcal{M}}^{(P)}$ . Note that in order to apply the slicing algorithm consistently, each probabilistic input variable

Table 2: 2-dof damped oscillator – resulting relative generalization error  $\widehat{err}_{\text{gen}}$  based on a Monte Carlo simulation with  $n = 10^5$  samples – mean value of 50 repetitions

$N_1$	$\widehat{err}_{\text{gen}} [\tilde{P}_s]$	$N_2$	$\widehat{err}_{\text{gen}} [\underline{P}_s]$	$\widehat{err}_{\text{gen}} [\overline{P}_s]$
100	$1.59 \cdot 10^{-2}$	100	$5.85 \cdot 10^{-2}$	$9.46 \cdot 10^{-2}$
		200	$4.59 \cdot 10^{-2}$	$7.32 \cdot 10^{-2}$
		300	$4.18 \cdot 10^{-2}$	$6.76 \cdot 10^{-2}$
		1000	$3.19 \cdot 10^{-2}$	$5.17 \cdot 10^{-2}$
200	$5.24 \cdot 10^{-3}$	100	$5.20 \cdot 10^{-2}$	$7.99 \cdot 10^{-2}$
		200	$3.41 \cdot 10^{-2}$	$6.08 \cdot 10^{-2}$
		300	$2.97 \cdot 10^{-2}$	$5.21 \cdot 10^{-2}$
		1000	$1.87 \cdot 10^{-2}$	$3.57 \cdot 10^{-2}$
300	$2.85 \cdot 10^{-3}$	100	$5.12 \cdot 10^{-2}$	$8.09 \cdot 10^{-2}$
		200	$3.13 \cdot 10^{-2}$	$5.93 \cdot 10^{-2}$
		300	$2.75 \cdot 10^{-2}$	$4.99 \cdot 10^{-2}$
		1000	$1.71 \cdot 10^{-2}$	$3.30 \cdot 10^{-2}$
$\rightarrow \infty$	0	100	$5.44 \cdot 10^{-2}$	$8.49 \cdot 10^{-2}$
		200	$3.07 \cdot 10^{-2}$	$6.11 \cdot 10^{-2}$
		300	$2.71 \cdot 10^{-2}$	$4.96 \cdot 10^{-2}$
		1000	$1.52 \cdot 10^{-2}$	$3.07 \cdot 10^{-2}$

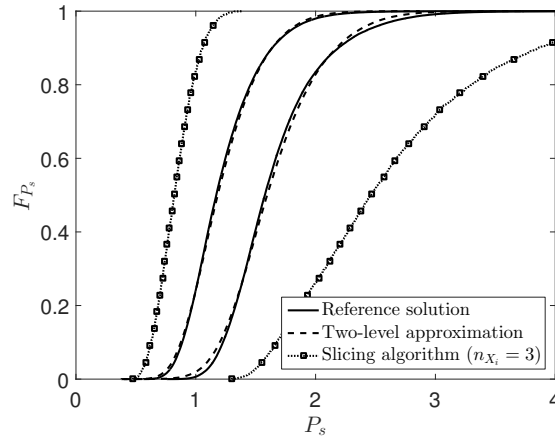

Figure 15: 2-dof damped oscillator – QoI  $P_s$ : reference solution ( $n = 10^5$ ) versus two-level approximation approach ( $N_1 = 300$ ,  $N_2 = 100$ ,  $\widehat{err}_{\text{gen}} [\tilde{P}_s] = 2.57 \cdot 10^{-3}$ ,  $\widehat{err}_{\text{gen}} [\overline{P}_s] = 7.50 \cdot 10^{-2}$ ,  $\widehat{err}_{\text{gen}} [\underline{P}_s] = 3.89 \cdot 10^{-2}$ ) and slicing algorithm with  $n_{X_i} = 3$

is interpreted as p-box too. These continuous random variables are bounded within their 1% and 99% quantiles in order to obtain finite intervals for the interval analysis. The number of intervals is chosen as  $n_{X_1} = 3$  in order to obtain a similar number of optimization operations as the proposed two-level approach, *i.e.*  $|\mathcal{K}| = 3^7 = 2187$ . Figure 16 illustrates the discretization for  $m_p$  and  $\zeta_p$ . The boundary curves of the discretized p-boxes are wider than the original input p-boxes. This effect is pronounced probabilistic input variables, as seen in the left part of

Figure 16.

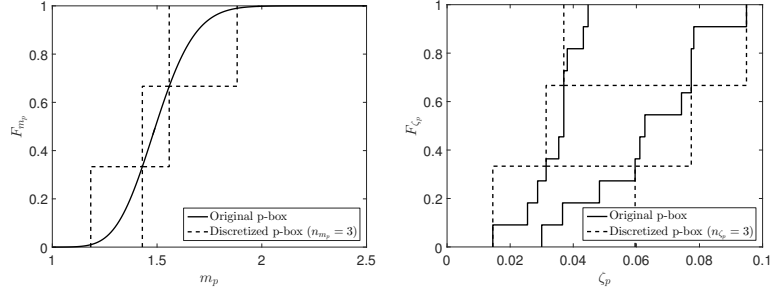

Figure 16: 2-dof damped oscillator – discretization of  $m_p$  and  $\zeta_p$  with  $n_{X_i} = 3$

The discretization algorithm leads to conservative approximations of the true input p-boxes. The propagation of the discretized intervals results in a p-box that is much wider (*i.e.* more conservative) compared to the proposed two-level approach, as indicated in Figure 15, despite the fact that more model evaluations were computed. The conservative estimate of the response p-box originate mainly in the coarse approximation of the five probabilistic input variables.

## 5.4 Two-dimensional truss structure

### 5.4.1 Problem definition

The third application example is a two-dimensional truss structure, which has been discussed previously in the context of reliability analysis (Lee and Kwak, 2006; Blatman and Sudret, 2010; Schöbi et al., 2016). Figure 17 shows the truss which is composed of 13 nodes and 23 bars. The geometry of the nodes is given deterministically, whereas the loading and material properties are given by p-boxes. The upper chord of the truss is subjected to loads  $P_i$ ,  $i = 1, \dots, 6$ . The horizontal bars are described by the cross-sectional area  $A_1$  and the Young's modulus  $E_1$  whereas the diagonal bars are described by  $A_2$  and  $E_2$ , respectively. The 10-dimensional input vector then reads:

$$\mathbf{X} = [A_1, A_2, E_1, E_2, P_1, P_2, P_3, P_4, P_5, P_6]. \quad (36)$$

Analogously to Case #2(b), the input variables are modelled by p-boxes defined by the envelope of a set of curves. The distribution function and its interval-valued parameters are summarized in Table 3. The variables are assumed to be statistically independent.

The QoI is the deflection  $u$  at mid-span as a function of the loading and the material parameters. The arrow in Figure 17 indicates positive values for  $u$ .

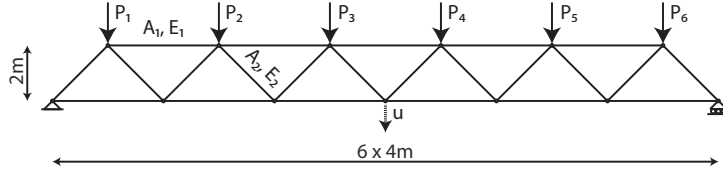

Figure 17: Two-dimensional truss – geometry, loading and QoI

Table 3: Two-dimensional truss – input p-boxes

Variable		Distribution	Mean	CoV
$A_1$	$[m^2]$	Lognormal	$[1.9, 2.1] \cdot 10^{-3}$	$[8, 12]\%$
$A_2$	$[m^2]$	Lognormal	$[0.9, 1.1] \cdot 10^{-3}$	$[8, 12]\%$
$E_1, E_2$	$[Pa]$	Lognormal	$[2.0, 2.2] \cdot 10^{11}$	$[9, 11]\%$
$P_1, \dots, P_6$	$[N]$	Gumbel	$[4.0, 6.0] \cdot 10^4$	$[10, 15]\%$

### 5.4.2 Analysis

For the truss structure, the auxiliary variable  $\tilde{X}_i$  is defined as follows. The mean value  $\mu_{\tilde{X}_i}$  is the mid-range of the mean value of  $X_i$ , and the coefficient of variation  $CoV_{\tilde{X}_i}$  is set to the maximum value of the coefficient of variation of  $X_i$ . The auxiliary variables are used on both levels of meta-models to ensure a good convergence behaviour.

Similar to the previous examples, the number of samples is varied in both levels of meta-models, *i.e.*  $N_1 = \{100, 300, \rightarrow \infty\}$  and  $N_2 = \{100, 300\}$ . The sparse PCE meta-models are built with Hermite polynomials with a candidate basis of maximal total degree of 20 and hyperbolic truncation scheme with  $q = 0.75$ . To ensure statistical significance of the results, 50 independent runs of the analysis are performed with different LHS experimental designs.

### 5.4.3 Results

A summary of the relative generalization error is given in Table 4. As expected, increasing the number of samples in the experimental design decreases the error of the meta-model on both meta-modelling levels. In particular, the influence of a larger experimental design on the first-level meta-model is visible. For the second-level meta-model, the absolute value of the relative generalization error is larger than for the first level due to the larger complexity of the analysis. In fact, the accuracy of  $\underline{u}$  and  $\bar{u}$  depends on the quality of (i) the first-level meta-model, (ii) the optimization algorithm, and (iii) the second-level meta-model.

Another aspect of the modelling is the shape of the response p-box, which is shown in Figure 18. The reference solution is obtained by a Monte Carlo simulation ( $n = 10^5$ ) and by taking advantage of the monotonicity of the truss model. A two-level approximation with  $N_1 = 300$  is able to reproduce the boundary curves of the response p-box accurately: the two

Table 4: Two-dimensional truss – resulting relative generalization error based on a Monte Carlo simulation with  $n = 10^5$  samples – mean value of 50 repetitions

$N_1$	$\widehat{err}_{\text{gen}}[\tilde{u}]$	$N_2$	$\widehat{err}_{\text{gen}}[u]$	$\widehat{err}_{\text{gen}}[\bar{u}]$
100	$1.96 \cdot 10^{-3}$	100	$8.30 \cdot 10^{-2}$	$4.85 \cdot 10^{-2}$
		300	$2.39 \cdot 10^{-2}$	$2.50 \cdot 10^{-2}$
300	$1.44 \cdot 10^{-4}$	100	$9.10 \cdot 10^{-2}$	$4.66 \cdot 10^{-2}$
		300	$2.09 \cdot 10^{-2}$	$2.01 \cdot 10^{-2}$
$\rightarrow \infty$	0	100	$1.24 \cdot 10^{-2}$	$2.18 \cdot 10^{-2}$
		300	$7.05 \cdot 10^{-3}$	$1.65 \cdot 10^{-2}$

curves for  $\bar{u}$  coincide, whereas the two curves for  $u$  are remarkably close to each other, too.

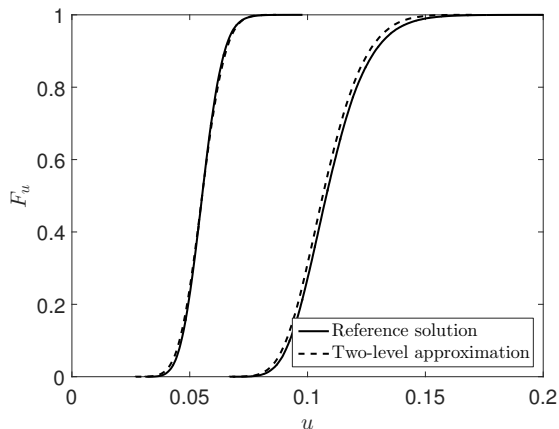

Figure 18: Two-dimensional truss – p-box of the deflection  $u$ : reference solution ( $n = 10^5$ ) versus two-level meta-modelling approach ( $N_1 = 300$ ,  $N_2 = 300$ ) ( $\widehat{err}_{\text{gen}}[\tilde{u}] = 9.82 \cdot 10^{-5}$ ,  $\widehat{err}_{\text{gen}}[\bar{u}] = 3.70 \cdot 10^{-2}$ , and  $\widehat{err}_{\text{gen}}[u] = 2.64 \cdot 10^{-2}$ )

## 6 Conclusions

This paper deals with the propagation of uncertainty in the input parameters of a deterministic, black-box computational model. Traditionally, the uncertainty of the input variables is described using probability theory, *i.e.* by probability distributions. In engineering practice however, data may be too limited to allow for an accurate, purely probabilistic modelling. This can be accounted for by modelling the input parameters using imprecise probability theory, which accounts for both aleatory (natural variability) and epistemic uncertainty (lack of knowledge). The use of probability-boxes (p-boxes) is one way to capture this mixed uncertainty by providing lower and upper bounds for the cumulative distribution function of variables.

In the context of p-boxes modelling, uncertainty propagation analyses are not straightforward. Using a simple problem conversion, the problem is recast as two independent uncertainty propagation problems based on standard probabilistic modelling of the inputs. This problem

conversion allows for traditional sampling-based methods, such as Monte Carlo simulation. However, due to the repeated evaluation of the computational model in sampling-based methods, the computational costs may become intractable.

In this paper, a two-level meta-modelling approach is proposed to reduce the overall computational cost considerably. Sparse non-intrusive Polynomial Chaos Expansions (PCE) are used to surrogate the computational model. Sparse PCE allows for an efficient (accurate and inexpensive) modelling of the bounds of the response p-box.

The capabilities of the two-level approach are illustrated by a benchmark analytical function and two realistic engineering problems. In all examples, the proposed approach is capable of estimating the bounds of the response p-box accurately with only a small number of runs of the exact computational model. This is of major significance in practice where computational resources are typically limited and at the same time expensive-to-evaluate models are analysed.

## References

## References

- Ahlfeld, R., B. Belkouchi, and F. Montomoli (2016). SAMBA: Sparse approximation of moment-based arbitrary polynomial chaos. *J. Comput. Phys.* 320, 1–16.
- Alvarez, D. A., J. E. Hurtado, and F. Uribe (2014). Estimation of the lower and upper probabilities of failure using random sets and subset simulation. In M. Beer, S.-K. Au, and J. W. Hall (Eds.), *Vulnerability, Uncertain. Risk*, Liverpool, UK, pp. 905–914. ASCE.
- Ayyub, B. M. (2001). *Elicitation of Expert Opinions for Uncertainty and Risks*. CRC Press.
- Ayyub, B. M. and G. J. Klir (2006). *Uncertainty Modeling and Analysis in Engineering and the Sciences*. Chapman & Hall.
- Balesdent, M., J. Morio, and J. Marzat (2013). Kriging-based adaptive Importance Sampling algorithms for rare event estimation. *Structural Safety* 44, 1–10.
- Berger, J. O. (1985). *Statistical Decision Theory and Bayesian Analysis*. New York: Springer-Verlag.
- Berveiller, M., B. Sudret, and M. Lemaire (2006). Stochastic finite elements: a non intrusive approach by regression. *Eur. J. Comput. Mech.* 15(1-3), 81–92.
- Blatman, G. and B. Sudret (2010). An adaptive algorithm to build up sparse polynomial chaos expansions for stochastic finite element analysis. *Prob. Eng. Mech.* 25(2), 183–197.



- Blatman, G. and B. Sudret (2011). Adaptive sparse polynomial chaos expansion based on Least Angle Regression. *J. Comput. Phys* 230(6), 2345–2367.
- Byrd, R. H., M. E. Hribar, and J. Nocedal (1999). An interior point algorithm for large-scale nonlinear programming. *SIAM J. Optim.* 9(4), 877–900.
- Chebyshev, P. (1874). Sur les valeurs limites des intégrales. *Journal de Mathématiques Pures et Appliquées, Ser 2* 19, 157–160.
- Chen, S., K.-R. G. Reyes, M. K. Gupta, M. C. McAlpine, and W. B. Powell (2015, jan). Optimal learning in experimental design using the knowledge gradient policy with application to characterizing nanoemulsion stability. *SIAM/ASA J. Uncertain. Quantif.* 3(1), 320–345.
- De Rocquigny, E. (2012). *Modelling under risk and uncertainty – An introduction to statistical, phenomenological and computational methods*. Wiley series in probability and statistics. John Wiley & Sons, Chichester.
- Dempster, A. P. (1967). Upper and lower probabilities induced by multivalued mapping. *Ann. Math. Stat.* 38(2), 325–339.
- Deng, W., X. Yang, L. Zou, M. Wang, Y. Liu, and Y. Li (2013). An improved self-adaptive differential evolution algorithm and its application. *Chemo. Intel. Lab.* 128, 66–76.
- Der Kiureghian, A. and M. de Stefano (1990). An efficient algorithm for second-order reliability analysis. Technical Report UCB/SEMM-90/20. Dept of Civil and Environmental Engineering, University of California, Berkeley.
- Der Kiureghian, A. and O. Ditlevsen (2009, March). Aleatory or epistemic? Does it matter? *Structural Safety* 31(2), 105–112.
- Destercke, S., D. Dubois, and E. Chojnacki (2008, November). Unifying practical uncertainty representations. II: clouds. *Int. J. Approx. Reason.* 49(3), 664–677.
- Dey, S., T. Mukhopadhyay, H. H. Khodaparast, and S. Adhikari (2016). Fuzzy uncertainty propagation in composites using GramSchmidt polynomial chaos expansion. *Appl. Math. Model.* 40(7), 4412–4428.
- Dong, W. and H. C. Shah (1987, October). Vertex method for computing functions of fuzzy variables. *Fuzzy Sets Syst.* 24(1), 65–78.
- Dubois, D., H. Fargier, and J. Fortin (2004). A generalized vertex method for computing with fuzzy intervals. In *2004 IEEE Int. Conf. Fuzzy Syst. (IEEE Cat. No.04CH37542)*, Volume 1, pp. 541–546. IEEE.

- Dubois, D. and H. Prade (1988). *Possibility theory: an approach to computerized processing of uncertainty*. New York: Plenum.
- Dubourg, V., B. Sudret, and J.-M. Bourinet (2011). Reliability-based design optimization using Kriging surrogates and subset simulation. *Struct. Multidisc. Optim.* 44(5), 673–690.
- Dubourg, V., B. Sudret, and F. Deheeger (2013). Metamodel-based importance sampling for structural reliability analysis. *Prob. Eng. Mech.* 33, 47–57.
- Echard, B., N. Gayton, and M. Lemaire (2011). AK-MCS: an active learning reliability method combining Kriging and Monte Carlo simulation. *Structural Safety* 33(2), 145–154.
- Efron, B., T. Hastie, I. Johnstone, and R. Tibshirani (2004). Least angle regression. *Annals of Statistics* 32, 407–499.
- Eldred, M. S. and L. P. Swiler (2009). Efficient algorithms for mixed aleatory-epistemic uncertainty quantification with application to radiation-hardened electronics part I : algorithms and benchmark results. Technical Report SAND2009-5805, Sandia National Laboratories.
- Ferson, S. and L. R. Ginzburg (1996). Different methods are needed to propagate ignorance and variability. *Reliab. Eng. Sys. Safety* 54(2-3), 133–144.
- Ferson, S. and J. G. Hajagos (2004). Arithmetic with uncertain numbers: rigorous and (often) best possible answers. *Reliab. Eng. Sys. Safety* 85(1-3), 135–152.
- Ferson, S., V. Kreinovich, L. Ginzburg, D. S. Myers, and K. Sentz (2003). Constructing Probability Boxes and Dempster-Shafer Structures. Technical report, Sandia National Laboratories.
- Ferson, S., R. Nelson, J. Hajagos, D. Berleant, J. Zhang, W. Tucker, L. Ginzburg, and W. Oberkampf (2004). Dependence in probabilistic modeling, Dempster-Shafer theory, and probability bounds analysis. Technical Report SAND2004-3072, Sandia National Laboratories.
- Forrester, A., A. Sobester, and A. Keane (2008). *Engineering design via surrogate modelling: a practical guide*. Wiley.
- Fu, G., D. Butler, S.-T. Khu, and S. Sun (2011). Imprecise probabilistic evaluation of sewer flooding in urban drainage systems using random set theory. *Water Resour. Res.* 47, W02534.
- Gautschi, W. (2004). *Orthogonal Polynomials: Computation and Approximation*. Numerical Mathematics and Scientific Computation. Oxford University Press.
- Gelman, A., J. Carlin, H. Stern, and D. Rubin (2009). *Bayesian Data Analysis* (second ed.). Chapman & Hall/CRC.

- Ghanem, R. and P. Spanos (2003). *Stochastic Finite Elements: A Spectral Approach* (2nd ed.). Courier Dover Publications, Mineola.
- Goldberg, G. H. (1989). *Genetic Algorithms in Search, Optimization, and Machine Learning*. Addison-Wesley Professional.
- Gunn, S. (1998). Support vector machines for classification and regression. Technical Report ISIS-1-98, Dpt. of Electronics and Computer Science, University of Southampton.
- Halton, J. H. (1960). On the efficiency of certain quasi-random sequences of point in evaluating multi-dimensional integrals. *Numer. Math.* 2, 84–90.
- He, Y., M. Mirzargar, and R. M. Kirby (2015). Mixed aleatory and epistemic uncertainty quantification using fuzzy set theory. *Int. J. Approx. Reason.* 66, 1–15.
- Helton, J., J. Johnson, and W. Oberkampf (2004, July). An exploration of alternative approaches to the representation of uncertainty in model predictions. *Reliab. Eng. Sys. Safety* 85(1-3), 39–71.
- Helton, J. and W. Oberkampf (2004). Alternative representations of epistemic uncertainty. *Reliab. Eng. Sys. Safety* 85(1-3), 1–10.
- Hu, Z. and X. Du (2015, oct). A random field approach to reliability analysis with random and interval variables. *ASCE-ASME J. Risk Uncertain. Eng. Syst. Part B Mech. Eng.* 1(4), 041005.
- Kolmogoroff, A. (1941). Confidence limits for unknown distribution function. *Ann. Math. Stat.* 12(4), 461–463.
- Krige, D. (1951). A statistical approach to some basic mine valuation problems on the Witwatersrand. *J. of the Chem., Metal. and Mining Soc. of South Africa* 52(6), 119–139.
- Lee, S. and B. Kwak (2006). Response surface augmented moment method for efficient reliability analysis. *Structural Safety* 28, 261–272.
- Li, J. and D. Xiu (2012). Computation of failure probability subjected to epistemic uncertainty. *SIAM J. Sci. Comput.* 34(6), 2946–2964.
- Marelli, S. and B. Sudret (2014). UQLab: a framework for uncertainty quantification in MATLAB. In *Proc. 2nd Int. Conf. on Vulnerability, Risk Analysis and Management (ICVRAM2014)*, Liverpool, United Kingdom.

- Marelli, S. and B. Sudret (2015). UQLab user manual – Polynomial chaos expansions. Technical report, Chair of Risk, Safety & Uncertainty Quantification, ETH Zurich. Report # UQLab-V0.9-104.
- Matheron, G. (1975). *Random Sets and Integral Geometry*. J. Wiley & Sons, New York.
- McKay, M. D., R. J. Beckman, and W. J. Conover (1979). A comparison of three methods for selecting values of input variables in the analysis of output from a computer code. *Technometrics* 2, 239–245.
- Molchanov, I. (2005). *The Theory of Random Sets*. Springer, New York.
- Möller, B. and M. Beer (2004). *Fuzzy Randomness*. Springer.
- Moore, R. (1966). *Interval analysis*. Englewood Cliffs, NJ: Prentice Hall.
- Moustapha, M., B. Sudret, J.-M. Bourinet, and B. Guillaume (2016). Quantile-based optimization under uncertainties using adaptive kriging surrogate models. *Struct. Multidisc. Optim.*. In press.
- Neumaier, A. (2004). Clouds, fuzzy sets, and probability intervals. *Reliab. Comput.* 10(4), 249–272.
- Oberguggenberger, M. and W. Fellin (2008). Reliability bounds through random sets: non-parametric methods and geotechnical applications. *Comput. Struct.* 86(10), 1093–1101.
- Rosenbrock, H. (1960). An automatic method for finding the greatest or least value of a function. *Comput. J.* 3, 175–184.
- Santner, T. J., B. J. Williams, and W. I. Notz (2003). *The Design and Analysis of Computer Experiments*. Springer, New York.
- Sargsyan, K., C. Safta, H. N. Najm, B. J. Debusschere, D. Ricciuto, and P. Thornton (2014). Dimensionality reduction for complex models via Bayesian compressive sensing. *Int. J. Uncertain. Quantification* 4(1), 63–93.
- Schöbi, R. and B. Sudret (2015a). Imprecise structural reliability analysis using PC-Kriging. In *Proc. 25th European Safety and Reliability Conference (ESREL2015), Zurich, Switzerland*.
- Schöbi, R. and B. Sudret (2015b). Propagation of uncertainties modelled by parametric p-boxes using sparse polynomial chaos expansions. In *Proc. 12th Int. Conf. on Applications of Stat. and Prob. in Civil Engineering (ICASP12), Vancouver, Canada*.

- Schöbi, R. and B. Sudret (2016). Multi-level meta-modelling in imprecise structural reliability analysis. In *Proc. 6th Asian-Pacific Symp. Struct. Reliab. (APSSRA'2016), Shanghai*.
- Schöbi, R., B. Sudret, and S. Marelli (2016). Rare event estimation using Polynomial-Chaos-Kriging. *ASCE-ASME J. Risk Uncertain. Eng. Syst. Part A Civ. Eng.*, D4016002.
- Schöbi, R., B. Sudret, and J. Wiart (2015). Polynomial-chaos-based Kriging. *Int. J. Uncertainty Quantification* 5(2), 171–193.
- Shafer, G. (1976). *A mathematical theory of evidence*. Princeton, NJ: Princeton University Press.
- Smirnov, N. (1939). On the estimation of the discrepancy between empirical curves of distribution for two independent samples. *Bulletin de l'Université de Moscou, Série internationale (Mathématiques)* 2.
- Sobol', L. M. (1967). The distribution of point in a cube and the approximate evaluation of integrals. *USSR. Comput. Math. Math. Phys.* 7(4), 86–112.
- Stolfi, J. and L. H. De Figueiredo (2003). An introduction to affine arithmetic. *TEMA Tend. Mat. Apl. Comput.* 4(3), 297–312.
- Storn, R. and K. Price (1997). Differential evolution, a simple and efficient heuristic for global optimization over continuous spaces. *J. Global Optim.* 11(4), 341–359.
- Sudret, B. (2007). *Uncertainty propagation and sensitivity analysis in mechanical models – Contributions to structural reliability and stochastic spectral methods*. Université Blaise Pascal, Clermont-Ferrand, France. Habilitation à diriger des recherches, 173 pages.
- Sudret, B. (2008). Global sensitivity analysis using polynomial chaos expansions. *Reliab. Eng. Sys. Safety* 93, 964–979.
- Sudret, B. (2015). Polynomials chaos expansions and stochastic finite element methods. In K.-K. Phoon and J. Ching (Eds.), *Risk Reliab. Geotech. Eng.*, Chapter 6. Taylor and Francis.
- Tibshirani, R. (1996). Regression shrinkage and selection via LASSO. *J. Roy. Stat. Soc. B* 58, 267–288.
- Tonon, F. (2004, jul). Using random set theory to propagate epistemic uncertainty through a mechanical system. *Reliab. Eng. Syst. Safety* 85(1-3), 169–181.
- Walley, P. (2000, may). Towards a unified theory of imprecise probability. *Int. J. Approx. Reason.* 24(2-3), 125–148.

Zhang, H., H. Dai, M. Beer, and W. Wang (2013). Structural reliability analysis on the basis of small samples: an interval quasi-Monte Carlo method. *Mech. Syst. Signal Process.* 37(1-2), 137–151.

Zhang, H., R. L. Mullen, and R. L. Muhanna (2010). Interval Monte Carlo methods for structural reliability. *Structural Safety* 32, 183–190.